

LICENSING SUB COMMITTEE AGENDA

Wednesday, 14 June 2017 at 10.00 am in the Blaydon Room - Civic Centre

From the Chief Executive, Sheena Ramsey

Item	Business
------	----------

1	Application for a New Premises Licence (Pages 3 - 142)
---	---

Report of the Strategic Director, Communities and Environment (attached).

This page is intentionally left blank

TITLE OF REPORT: **Application for a Premises Licence:**
Abel House, Unit 1&2, Station Road, Rowlands Gill, NE39
1QD

REPORT OF: **Strategic Director, Communities & Environment:**
Licensing Officer

1. **PURPOSE OF THE REPORT**

The Sub-Committee is asked to consider the application from Stephen Olver for a new Premises Licence for Abel House, Unit 1 & 2, Station Road, Rowlands Gill, NE39 1QD following receipt of representations from members of the public.

2. **BACKGROUND**

The Application

This report relates to an application by Stephen Olver (The Applicant) for a new Premises Licence for Abel House, Unit 1 & 2, Station Road, Rowlands Gill, NE39 1QD. The application is attached at Appendix 1.

The application for a new Premises Licence under s17 of the Licensing Act 2003 is for the supply of alcohol (on and off the premises) and live and recorded music at the following times:

Provision of regulated entertainment (Live Music)

Sunday: 17:00 – 20:00

Provision of regulated entertainment (Recorded Music and Anything of a Similar Description)

Sunday - Thursday: 12:00 – 21:30

Friday & Saturday: 12:00 – 22:00

Supply of Alcohol

Sunday - Thursday: 12:00 – 21:30

Friday & Saturday: 12:00 – 22:00

The application was advertised at the premises and in the local press.

Conditions

The Licensing Authority may attach conditions to any licence which are appropriate for the promotion of the Licensing Objectives.

In consultation with Northumbria Police and Gateshead Council's Environmental Health Service, the Applicant has agreed the addition of a number of conditions. These proposed conditions are detailed in Appendix 1.1

A copy of the Model Pool of Conditions from Gateshead Council's Statement of Licensing Policy is attached as Appendix 1.2 that relate to the application.

Planning

Gateshead Council's Planning Department have advised that a planning application is required for the premises to be used as a public house / drinking establishment, and that no application has yet been received for such permission to be considered.

3. REPRESENTATIONS

The following representations were received:

- Planning Department (See Appendix 2)
- Mr T E Brown (See Appendix 2.1)
- Mr Lindsay J Williams (See Appendix 2.2)
- Robert Allan Steele (See Appendix 2.3)
- Mr G and Mrs A Smith (See Appendix 2.4)
- Mrs C Purvis (See Appendix 2.5)
- Joan Henderson (See Appendix 2.6)
- Ian and Ivy Maughan (See Appendix 2.7)
- M E Bell (See Appendix 2.8)
- Neville and Sheila Stoddart (See Appendix 2.9)
- Mr M and Mrs P Ainsley (See Appendix 2.10)
- William and Heather Woods (See Appendix 2.11)
- Elaine Snell (See Appendix 2.12)
- Janet Brodie (See Appendix 2.13)
- Petition containing 94 signatures (See Appendix 2.14)

4. PARTIES

The Parties to the hearing will be:

- a) The Applicant, Stephen Olver
- b) Planning Department
- c) The members of the public that have submitted a representation or signed the petition

5. FOR CONSIDERATION

The areas for consideration by the Sub-Committee are:

- The application for a Premises Licence;
- The representations;
- Whether or not the application should be granted; and
- The conditions to be attached to the Premises Licence (if granted).

6. THE POLICY & GUIDANCE

In determining the application with a view to promoting the licensing objectives the licensing authority must give appropriate weight to:

- (a) the steps that are appropriate to promote the licensing objectives
- (b) the Statement of Gateshead Council's Licensing Policy, and
- (c) the Amended Guidance (April 2017) issued under Section 182 of the Licensing Act 2003 by the Secretary of State
- (d) The Licensing Act 2003.

Some relevant parts of the Policy and Amended Guidance are reproduced in Appendices 3 and 4. The parties may refer to any part of the Policy and Guidance during the hearing.

7. FOR DECISION

The Sub-Committee is asked to consider the application, decide whether or not it should be granted, and if relevant, attach such conditions as it deems appropriate for the promotion of the Licensing Objectives.

APPENDICES

Appendix	1	Premises Licence Application
	1.1	Proposed conditions
	1.2	Model Conditions from Gateshead Council's Licensing Policy
Appendix	2	Representation from Planning Department
	2.1	Representation from Mr T E Brown
	2.2	Representation from Mr Lindsay J Williams
	2.3	Representation from Robert Allan Steele
	2.4	Representation from Mr G and Mrs A Smith
	2.5	Representation from Mrs C Purvis
	2.6	Representation from Joan Henderson
	2.7	Representation from Ian and Ivy Maughan
	2.8	Representation from M E Bell
	2.9	Representation from Neville and Sheila Stoddart
	2.10	Representation from Mr M and Mrs P Ainsley
	2.11	Representation from William and Heather Woods
	2.12	Representation from Elaine Snell
	2.13	Representation from Janet Brodie
	2.14	Representation from Petition
Appendix	3	Relevant Extracts from Gateshead Council's Licensing Policy
Appendix	4	Relevant Extracts from the Guidance issued under Section 182 of the Licensing Act 2003.
Appendix	5	Area Plan

APPENDICES

NEW PREMISES LICENCE APPLICATION

**ABEL HOUSE, UNIT 1 & 2, STATION ROAD, ROWLANDS GILL, NE39
1QD**

19/05/17.

Application for a premises licence to be granted
under the Licensing Act 2003

PLEASE READ THE FOLLOWING INSTRUCTIONS FIRST

Before completing this form please read the guidance notes at the end of the form. If you are completing this form by hand please write legibly in block capitals. In all cases ensure that your answers are inside the boxes and written in black ink. Use additional sheets if necessary.

You may wish to keep a copy of the completed form for your records.

I/ Stephen Oliver
~~We~~

(Insert name(s) of applicant)

apply for a premises licence under section 17 of the Licensing Act 2003 for the premises described in Part 1 below (the premises) and I/we are making this application to you as the relevant licensing authority in accordance with section 12 of the Licensing Act 2003

Part 1 - Premises details

Postal address of premises or, if none, ordnance survey map reference or description Station Road ABEL HOUSE UNIT 1 & 2 STATION ROAD			
Post town	Rowlands Gill	Postcode	NE39 1 QD

Telephone number at premises (if any)	
Non-domestic rateable value of premises	£ 5300

Part 2 - Applicant details

Please state whether you are applying for a premises licence as Please tick as appropriate

- a) an individual or individuals * please complete section (A) ✓
- b) a person other than an individual *
 - i as a limited company/limited liability partnership please complete section (B)
 - ii as a partnership (other than limited liability) please complete section (B)
 - iii as an unincorporated association or please complete section (B)
 - iv other (for example a statutory corporation) please complete section (B)
- c) a recognised club please complete section (B)
- d) a charity please complete section (B)
- e) the proprietor of an educational establishment please complete section (B)

- f) a health service body please complete section (B)
- g) a person who is registered under Part 2 of the Care Standards Act 2000 (c14) in respect of an independent hospital in Wales please complete section (B)
- ga) a person who is registered under Chapter 2 of Part 1 of the Health and Social Care Act 2008 (within the meaning of that Part) in an independent hospital in England please complete section (B)
- h) the chief officer of police of a police force in England and Wales please complete section (B)

* If you are applying as a person described in (a) or (b) please confirm (by ticking yes to one box below):

I am carrying on or proposing to carry on a business which involves the use of the premises for licensable activities; or

I am making the application pursuant to a

statutory function or

a function discharged by virtue of Her Majesty's prerogative

(A) INDIVIDUAL APPLICANTS (fill in as applicable)

<input checked="" type="checkbox"/> Mr	<input type="checkbox"/> Mrs	<input type="checkbox"/> Miss	<input type="checkbox"/> Ms	<input type="checkbox"/> Other Title (for example, Rev)	
Surname OLVER			First names STEPHEN		
Date of birth over <input checked="" type="checkbox"/>		I am 18 years old or		Please tick yes	
Nationality [REDACTED]					
Current residential address if different from premises address		AGED MINERS HOMES HIGH SPEN ROWLANDS GILL			
Post town		ROWLANDS GILL		Postcode	
				NE39 [REDACTED]	
Daytime contact telephone number [REDACTED]					
E-mail address (optional) [REDACTED]					

SECOND INDIVIDUAL APPLICANT (if applicable)

<input type="checkbox"/> Mr	<input type="checkbox"/> Mrs	<input type="checkbox"/> Miss	<input type="checkbox"/> Ms	<input type="checkbox"/> Other Title (for example, Rev)	
-----------------------------	------------------------------	-------------------------------	-----------------------------	---	--

Surname		First names	
Date of birth over		I am 18 years old or <input type="checkbox"/> Please tick yes <input type="checkbox"/>	
Nationality			
Current postal address if different from premises address			
Post town		Postcode	
Daytime contact telephone number			
E-mail address (optional)			

(B) OTHER APPLICANTS

Please provide name and registered address of applicant in full. Where appropriate please give any registered number. In the case of a partnership or other joint venture (other than a body corporate), please give the name and address of each party concerned.

Name
Address
Registered number (where applicable)
Description of applicant (for example, partnership, company, unincorporated association etc.)
Telephone number (if any)
E-mail address (optional)

Part 3 Operating Schedule

DD MM YYYY

When do you want the premises licence to start?

01 07 2017

DD MM YYYY

If you wish the licence to be valid only for a limited period, when do you want it to end?

Please give a general description of the premises (please read guidance note 1)

A SINGLE STOREY UNIT, CURRENTLY AN ART STUDIO AND GALLERY ON STATION RT. ROWLANDS GILL.

If 5,000 or more people are expected to attend the premises at any one time, please state the number expected to attend.

What licensable activities do you intend to carry on from the premises?

(please see sections 1 and 14 and Schedules 1 and 2 to the Licensing Act 2003)

Provision of regulated entertainment (please read guidance note 2)

Please tick all that apply

- a) plays (if ticking yes, fill in box A)
- b) films (if ticking yes, fill in box B)
- c) indoor sporting events (if ticking yes, fill in box C)
- d) boxing or wrestling entertainment (if ticking yes, fill in box D)
- e) live music (if ticking yes, fill in box E) ✓
- f) recorded music (if ticking yes, fill in box F) ✓
- g) performances of dance (if ticking yes, fill in box G)
- h) anything of a similar description to that falling within (e), (f) or (g) ✓
(if ticking yes, fill in box H)

Provision of late night refreshment (if ticking yes, fill in box I)

Supply of alcohol (if ticking yes, fill in box J) ✓

In all cases complete boxes K, L and M

A

Plays Standard days and timings (please read guidance note 7)			Will the performance of a play take place indoors or outdoors or both – please tick (please read guidance note 3)	Indoors	
Day	Start	Finish		Outdoors	
Mon			<u>Please give further details here</u> (please read guidance note 4)		
Tue					
Wed			<u>State any seasonal variations for performing plays</u> (please read guidance note 5)		
Thur					
Fri			<u>Non standard timings. Where you intend to use the premises for the performance of plays at different times to those listed in the column on the left, please list</u> (please read guidance note 6)		
Sat					
Sun					

B

Films Standard days and timings (please read guidance note 7)			<u>Will the exhibition of films take place indoors or outdoors or both – please tick</u> (please read guidance note 3)	Indoors	
Day	Start	Finish		Outdoors	
Mon			<u>Please give further details here</u> (please read guidance note 4)	Both	
Tue					
Wed			<u>State any seasonal variations for the exhibition of films</u> (please read guidance note 5)		
Thur					
Fri			<u>Non standard timings. Where you intend to use the premises for the exhibition of films at different times to those listed in the column on the left, please list</u> (please read guidance note 6)		
Sat					
Sun					

C

Indoor sporting events Standard days and timings (please read guidance note 7)			Please give further details (please read guidance note 4)
Day	Start	Finish	
Mon			State any seasonal variations for indoor sporting events (please read guidance note 5)
Tue			
Wed			
Thur			Non standard timings. Where you intend to use the premises for indoor sporting events at different times to those listed in the column on the left, please list (please read guidance note 6)
Fri			
Sat			
Sun			

D

Boxing or wrestling entertainments Standard days and timings (please read guidance note 7)			<u>Will the boxing or wrestling entertainment take place indoors or outdoors or both - please tick</u> (please read guidance note 3)	Indoors
Day	Start	Finish		Outdoors
Mon			<u>Please give further details here</u> (please read guidance note 4)	Both
Tue				
Wed			<u>State any seasonal variations for boxing or wrestling entertainment</u> (please read guidance note 5)	
Thur				
Fri			<u>Non standard timings. Where you intend to use the premises for boxing or wrestling entertainment at different times to those listed in the column on the left, please list</u> (please read guidance note 6)	
Sat				
Sun				

E

Live music Standard days and timings (please read guidance note 7)			Will the performance of live music take place <u>indoors or outdoors or both</u> – please tick (please read guidance note 3)	Indoors	<input checked="" type="checkbox"/>
Day	Start	Finish		Outdoors	<input type="checkbox"/>
Mon	12.00	21.30	Please give further details here (please read guidance note 4) BUSKERS PLAYING AMPLIFIED AND UNAMPLIFIED.	Both	<input type="checkbox"/>
Tue	12.00	21.30			
Wed	12.00	21.30	State any seasonal variations for the performance of live music (please read guidance note 5)		
Thur	12.00	21.30			
Fri	12.00	22.00	Non standard timings. Where you intend to use the premises for the performance of live music at different times to those listed in the column on the left, please list (please read guidance note 6) UP TO 21.00 ON BANK HOLIDAY. WEEKENDS.		
Sat	12.00	22.00			
Sun	12.00	21.30			
	17.00	20.00			

F

Recorded music Standard days and timings (please read guidance note 7)			Will the playing of recorded music take place <u>indoors or outdoors or both</u> – please tick (please read guidance note 3)	Indoors	<input checked="" type="checkbox"/>
Day	Start	Finish		Outdoors	<input type="checkbox"/>
Mon	12.00	21.30	<u>Please give further details here</u> (please read guidance note 4) BACKGROUND MUSIC ONLY THROUGH SPEAKERS. NO JUKE BOX OR T.V.	Both	<input type="checkbox"/>
Tue	12.00	21.30			
Wed	12.00	21.30	<u>State any seasonal variations for the playing of recorded music</u> (please read guidance note 5)		
Thur	12.00	21.30			
Fri	12.00	22.00	<u>Non standard timings. Where you intend to use the premises for the playing of recorded music at different times to those listed in the column on the left, please list</u> (please read guidance note 6)		
Sat	12.00	22.00			
Sun	12.00	21.30			

G

Performances of dance Standard days and timings (please read guidance note 7)			<u>Will the performance of dance take place indoors or outdoors or both – please tick</u> (please read guidance note 3)	Indoors	
Day	Start	Finish		Outdoors	
Mon			<u>Please give further details here</u> (please read guidance note 4)		
Tue					
Wed			<u>State any seasonal variations for the performance of dance</u> (please read guidance note 5)		
Thur					
Fri			<u>Non standard timings. Where you intend to use the premises for the performance of dance at different times to those listed in the column on the left, please list</u> (please read guidance note 6)		
Sat					
Sun					

H

<p>Anything of a similar description to that falling within (e), (f) or (g) Standard days and timings (please read guidance note 7)</p>			<p>Please give a description of the type of entertainment you will be providing</p>		
Day	Start	Finish	<p>Will this entertainment take place indoors or outdoors or both – please tick (please read guidance note 3)</p>	Indoors	<input checked="" type="checkbox"/>
Mon	12.00	21.30		Outdoors	<input type="checkbox"/>
Tue	12.00	21.30	<p>Please give further details here (please read guidance note 4)</p>		
Wed	12.00	21.30			
Thur	12.00	21.30	<p>State any seasonal variations for entertainment of a similar description to that falling within (e), (f) or (g) (please read guidance note 5)</p>		
Fri	12.00	22.00			
Sat	12.00	22.00	<p>Non standard timings. Where you intend to use the premises for the entertainment of a similar description to that falling within (e), (f) or (g) at different times to those listed in the column on the left, please list (please read guidance note 6)</p>		
Sun	12.00	21.30			

I

Late night refreshment Standard days and timings (please read guidance note 7)			Will the provision of late night refreshment take place indoors or outdoors or both – please tick (please read guidance note 3)	Indoors	
Day	Start	Finish		Outdoors	
Mon			<u>Please give further details here</u> (please read guidance note 4)		
Tue					
Wed			<u>State any seasonal variations for the provision of late night refreshment</u> (please read guidance note 5)		
Thur					
Fri			<u>Non standard timings. Where you intend to use the premises for the provision of late night refreshment at different times, to those listed in the column on the left, please list</u> (please read guidance note 6)		
Sat					
Sun					

J

Supply of alcohol Standard days and timings (please read guidance note 7)			Will the supply of alcohol be for consumption - please tick (please read guidance note 8)	On the premises	
Day	Start	Finish		Off the premises	
Mon	12.00	21.30	State any seasonal variations for the supply of alcohol (please read guidance note 5)	Both	<input checked="" type="checkbox"/>
Tue	12.00	21.30			
Wed	12.00	21.30			
Thur	12.00	21.30	Non standard timings. Where you intend to use the premises for the supply of alcohol at different times to those listed in the column on the left, please list (please read guidance note 6)		
Fri	12.00	22.00			
Sat	12.00	22.00			
Sun	12.00	21.30			

OPEN TILL 22.00 ON BANK
HOLIDAY WEEKENDS, FRI, SAT, SUN,
MON. MIDNIGHT 24.00 NEW
YEARS EVE.

State the name and details of the individual whom you wish to specify on the licence as designated premises supervisor (Please see declaration about the entitlement to work in the checklist at the end of the form):

Name	STEPHEN OLVER	
Date of birth	[REDACTED]	
Address	AGED MINERS HOMES HIGH SPEN ROWLANDS GILL TYNE & WEAR	
Postcode	NE39	[REDACTED]
Personal licence number (if known)		
Issuing licensing authority (if known)	GATESHEAD	

K

Please highlight any adult entertainment or services, activities, other entertainment or matters ancillary to the use of the premises that may give rise to concern in respect of children (please read guidance note 9).

NO TV OR ANY NUDITY OR SEMI NUDITY TO BE SHOWN.
NO GAMING MACHINES

L

Hours premises are open to the public Standard days and timings (please read guidance note 7)			State any seasonal variations (please read guidance note 5)
Day	Start	Finish	
Mon	12.00	21.30	
Tue	12.00	21.30	
Wed	12.00	21.30	
Thur	12.00	21.30	<u>Non standard timings. Where you intend the premises to be open to the public at different times from those listed in the column on the left, please list</u> (please read guidance note 6) NEW YEARS EVE 24.00. BANK HOLIDAY WEEKENDS FRI 12.00 - 22.00 SAT 12.00 - 22.00 SUN 12.00 - 22.00 MON. 12.00 - 22.00
Fri	12.00	22.00	
Sat	12.00	22.00	
Sun	12.00	22.00	

M Describe the steps you intend to take to promote the four licensing objectives:

a) General - all four licensing objectives (b, c, d and e) (please read guidance note 10)

MANAGEMENT WILL CONTROL EXISTING TRAINING OF ALL STAFF TO MAKE THEM AWARE OF PREMISES LICENCE & REQUIREMENTS TO MEET THE FOUR LICENSING OBJECTIVES, WITH ATTENTION TO SELLING OF ALCOHOL TO UNDERAGE PEOPLE. - NO DRUNK & DISORDERLY BEHAVIOUR ON THE PREMISES. - VIGILANCE IN PREVENTING USE & SALE OF ILLEGAL DRUGS AT THE PREMISES. - NO VIOLENT & ANTI SOCIAL BEHAVIOUR. - NO HARM TO CHILDREN

CHALLENGE 25, CCTV SYSTEM INSTALLED WITH RECORDING.

b) The prevention of crime and disorder

CCTV SYSTEM TO MONITOR & RECORD PREMISES FOR THE PREVENTION OF CRIME. - A CLEAR & LEGIBLE NOTICE OUTSIDE PREMISES INDICATING NORMAL HOURS OF OPENING UNDER THE TERMS OF THE PREMISES LICENCE. - NOT SELLING ALCOHOL TO DRUNK CUSTOMERS. - STAFF WILL BE TRAINED TO ASK CUSTOMERS TO USE PREMISES IN AN ORDERLY & RESPECTFUL MANNER. PREVENTION & VIGILANCE IN ILLEGAL DRUGS ON PREMISES. CLEAR NOTICES WARNING CUSTOMERS OF POTENTIAL CRIMINAL ACTIVITY SUCH AS THEFT.

c) Public safety

WELL TRAINED STAFF ADHERANCE TO ENVIRONMENTAL HEALTH REQUIREMENTS - TRAINING & IMPLEMENTING UNDERAGE I.D. CHECKS. - A LOG BOOK OR RECORDING SYSTEM KEPT ON PREMISES TO ENTER ANY PARTICULARS OF INSPECTION, TO BE INSPECTED WHEN REQUIRED BY PERSONS AUTHORISED BY THE LICENSING ACT 2003. - ALL PARTS OF THE PREMISE WILL BE MAINTAINED & KEPT IN GOOD ORDER & SAFE CONDITION.

d) The prevention of public nuisance

MEASURES TAKEN TO REDUCE NOISE & PUBLIC NUISANCE PROMINENT & CLEAR NOTICE DISPLAYED AT EXIT REQUESTING THE PUBLIC TO RESPECT NEEDS OF NEARBY RESIDENTS & LEAVE PREMISES QUIETLY. - DELIVERIES WILL BE CARRIED OUT AT REASONABLE TIMES TO PREVENT DISTURBANCE TO NEARBY RESIDENTS. ALL STAFF ARRIVING OR DEPARTING WILL NOT CAUSE A DISTURBANCE. - CUSTOMERS WILL BE ASKED NOT TO STAND AROUND TALKING LOUDLY OUTSIDE PREMISES. CUSTOMERS WILL NOT BE ADMITTED TO PREMISES OUTSIDE OF OPENING TIMES. MOVING OF BINS WILL BE KEPT TO A MINIMUM. ANY OUTSIDE LIGHTING WILL NOT CAUSE A DISTURBANCE TO NEIGHBOURS

e) The protection of children from harm

CHALLENGE 25 SIGN, A SIGN THAT ANYONE OVER 18 BUT LOOKS UNDER 25 TO CARRY ACCEPTABLE I.D. PHOTOGRAPHIC DRIVING LICENCE, PASSPORT OR A CARD BEARING THE PASS HOLOGRAM, IF THEY WANT TO BUY ALCOHOL. - WELL TRAINED STAFF FOR REQUIREMENTS FOR IDENTIFYING & ESTABLISHING AGE. LOG BOOK TO BE KEPT ON PREMISES AT ALL TIMES.

Checklist:

Please tick to indicate agreement

I have made or enclosed payment of the fee. ✓

I have enclosed the plan of the premises. ✓

I have sent copies of this application and the plan to responsible authorities and others where applicable. ✓

I have enclosed the consent form completed by the individual I wish to be designated premises supervisor, if applicable. ✓

I understand that I must now advertise my application. ✓

I understand that if I do not comply with the above requirements my application will be rejected. ✓

[Applicable to all individual applicants, including those in a partnership which is not a limited liability partnership, but not companies or limited liability partnerships] I have included documents demonstrating my entitlement to work in the United Kingdom (please read note 15).

IT IS AN OFFENCE, UNDER SECTION 158 OF THE LICENSING ACT 2003, TO MAKE A FALSE STATEMENT IN OR IN CONNECTION WITH THIS APPLICATION. THOSE WHO MAKE A FALSE STATEMENT MAY BE LIABLE ON SUMMARY CONVICTION TO A FINE OF ANY AMOUNT.

IT IS AN OFFENCE UNDER SECTION 24B OF THE IMMIGRATION ACT 1971 FOR A PERSON TO WORK WHEN THEY KNOW, OR HAVE REASONABLE CAUSE TO BELIEVE, THAT THEY ARE DISQUALIFIED FROM DOING SO BY REASON OF THEIR IMMIGRATION STATUS. THOSE WHO EMPLOY AN ADULT WITHOUT LEAVE OR WHO IS SUBJECT TO CONDITIONS AS TO EMPLOYMENT WILL BE LIABLE TO A CIVIL PENALTY UNDER SECTION 15 OF THE IMMIGRATION, ASYLUM AND NATIONALITY ACT 2006 AND PURSUANT TO SECTION 21 OF THE SAME ACT, WILL BE COMMITTING AN OFFENCE WHERE THEY DO SO IN THE KNOWLEDGE, OR WITH REASONABLE CAUSE TO BELIEVE, THAT THE EMPLOYEE IS DISQUALIFIED.

Part 4 – Signatures (please read guidance note 11)

Signature of applicant or applicant's solicitor or other duly authorised agent (see guidance note 12). If signing on behalf of the applicant, please state in what capacity.

Declaration	<ul style="list-style-type: none">• [Applicable to individual applicants only, including those in a partnership which is not a limited liability partnership] I understand I am not entitled to be issued with a licence if I do not have the entitlement to live and work in the UK (or if I am subject to a condition preventing me from doing work relating to the carrying on of a licensable activity) and that my licence will become invalid if I cease to be entitled to live and work in the UK (please read guidance note 15).• The DPS named in this application form is entitled to work in the UK (and is not subject to conditions preventing him or her from doing work relating to a licensable activity) and I have seen a copy of his or her proof of entitlement to work, if appropriate (please see note 15)
-------------	---

Signature	[REDACTED]
Date	21.4.17
Capacity	

For joint applications, signature of 2nd applicant or 2nd applicant's solicitor or other authorised agent (please read guidance note 13). If signing on behalf of the applicant, please state in what capacity.

Signature	
Date	
Capacity	

Contact name (where not previously given) and postal address for correspondence associated with this application (please read guidance note 14)			
[REDACTED] AGED MINERS HOMES			
Post town	ROWLANDS GILL	Postcode	NE39 [REDACTED]
Telephone number (if any)	[REDACTED]		
If you would prefer us to correspond with you by e-mail, your e-mail address (optional)			
[REDACTED]			

Notes for Guidance

- Describe the premises, for example the type of premises, its general situation and layout and any other information which could be relevant to the licensing objectives. Where your application includes off-supplies of alcohol and you intend to provide a place for consumption of these off-supplies, you must include a description of where the place will be and its proximity to the premises.
- In terms of specific regulated entertainments please note that:
 - Plays: no licence is required for performances between 08:00 and 23.00 on any day, provided that the audience does not exceed 500.
 - Films: no licence is required for 'not-for-profit' film exhibition held in community premises between 08.00 and 23.00 on any day provided that the audience does not exceed 500 and the organiser (a) gets consent to the screening from a person who is responsible for the premises; and (b) ensures that each such screening abides by age classification ratings.
 - Indoor sporting events: no licence is required for performances between 08.00 and 23.00 on any day, provided that the audience does not exceed 1000.
 - Boxing or Wrestling Entertainment: no licence is required for a contest, exhibition or display of Greco-Roman wrestling, or freestyle wrestling between 08.00 and 23.00 on any day, provided that the audience does not exceed 1000. Combined fighting sports – defined as a contest, exhibition or display which combines boxing or wrestling with one or more martial arts – are licensable as a boxing or wrestling entertainment rather than an indoor sporting event.
 - Live music: no licence permission is required for:
 - a performance of unamplified live music between 08.00 and 23.00 on any day, on any premises.

Consent of individual to being specified as premises supervisor

STEPHEN OLVER

[full name of prospective premises supervisor]

of [REDACTED] AGED MINERS HOMES
ROWLANDS GILL
NE 39 [REDACTED]

[home address of prospective premises supervisor]

hereby confirm that I give my consent to be specified as the designated premises supervisor in relation to the application for

GRANT

[type of application]

by

STEPHEN OLVER

[name of applicant]

relating to a premises licence

[number of existing licence, if any]

for ABEL HOUSE UNIT 122
STATION RD
ROWLANDS GILL
NE39 1AD

[name and address of premises to which the application relates]

and any premises licence to be granted or varied in respect of this application made by

STEPHEN OLVER
[name of applicant]

concerning the supply of alcohol at
ABEL HOUSE UNIT 122
STATION RD
ROWLANDS GIL

NK39 1QD
[name and address of premises to which application relates]

I also confirm that I am entitled to work in the United Kingdom and am applying for, intend to apply for or currently hold a personal licence, details of which I set out below.

Personal licence number

[insert personal licence number, if any]

Personal licence issuing authority

[insert name and address and telephone number of personal licence issuing authority, if any]

Signed



STEPHEN OLVER
Name (please print)

21-4-17
Date

All intellectual property rights in this design are and will remain the property of Charles Collins RIBA. Any infringement will be taken seriously - promotional material the erection of structures based on these designs and drawings. This drawing must not be copied, traced, photocopied or otherwise reproduced or used for any purpose by any third party without the express written consent of Charles Collins RIBA who retains the copyright.

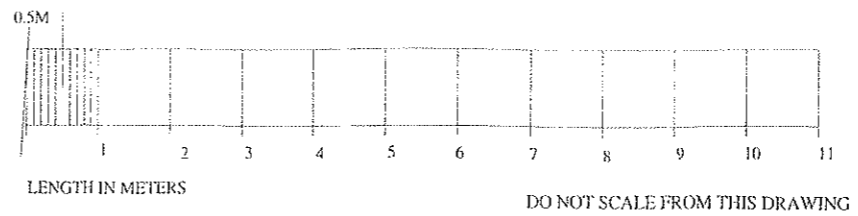

NOTES:

1. Details from this drawing only should be used for construction. Do not copy details from other drawings without the written consent of the Architect.

2. The contractor must refer to the specifications in the Architect's contract documents for the full details of the construction.

3. It is the contractor's responsibility to check the quantities before starting work on site.

4. Work under 'The Construction Management Regulations 2007' shall be undertaken in accordance with the Health & Safety File to be prepared.

5. This drawing is copyright and must not be reproduced in any form or by any means without the written consent of Charles Collins RIBA.

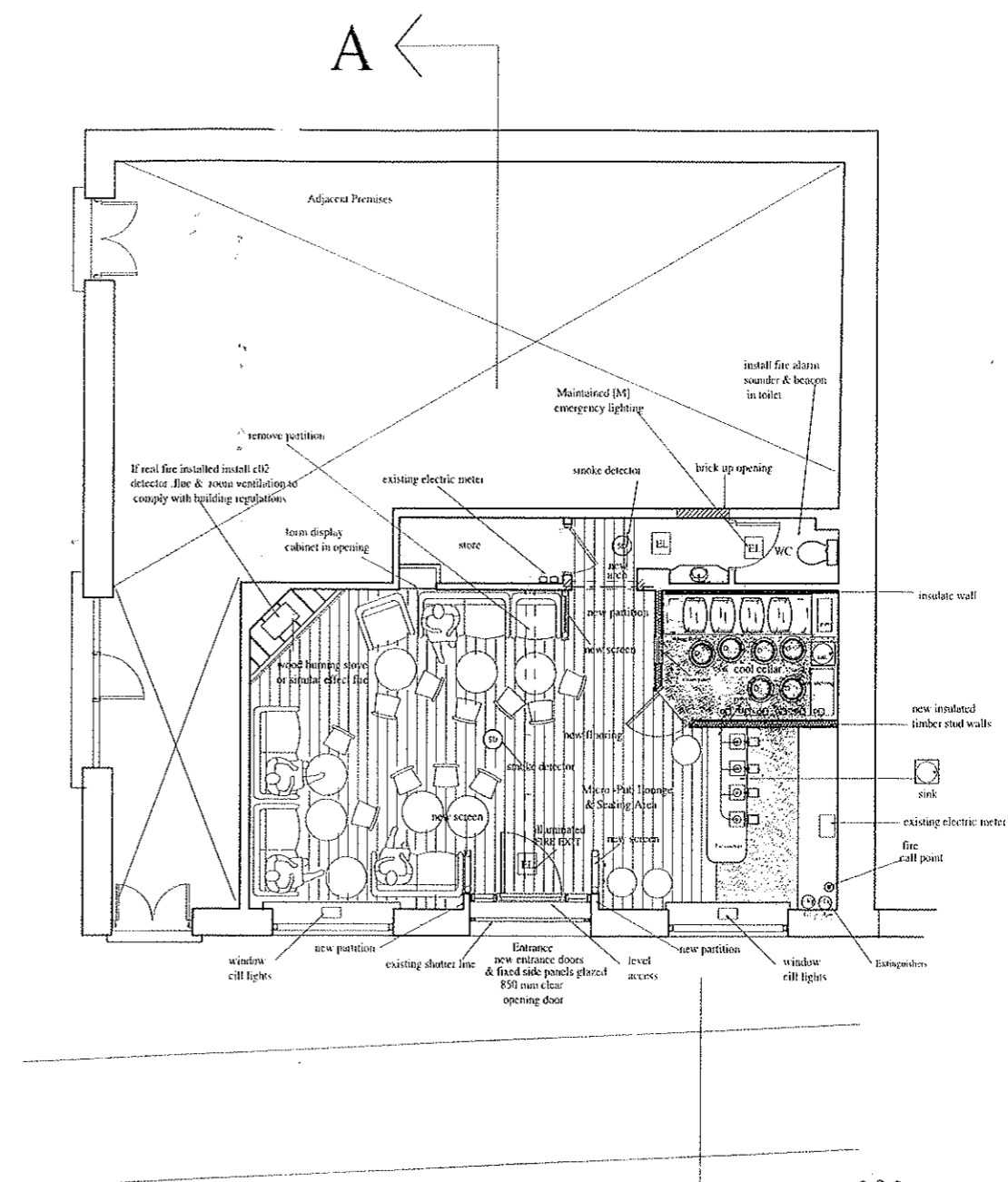
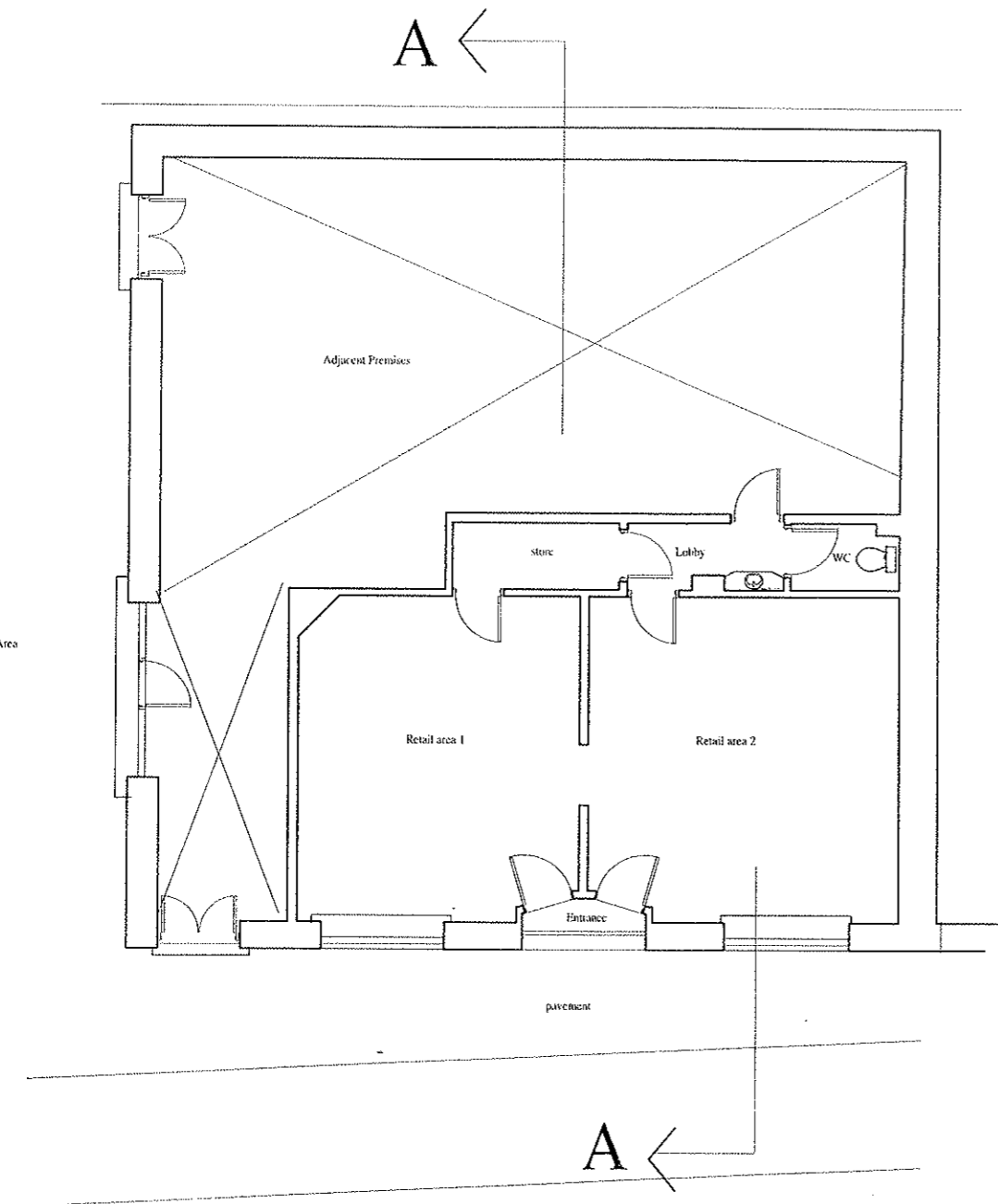

Station Road

Station Road

Existing Ground Floor Plan

Proposed Ground Floor Plan

PRELIMINARY DRAWINGS NOT ISSUED FOR CONSTRUCTION

Page 29

A1 Paper Size

Charles Collins RIBA
LANCASTER ASSOCIATES ARCHITECTS
 THE WOODLANDS, WINGROVE ROWLANDS GILL, NE39 1DT.
 TELEPHONE: 01207 545230

Proposed Micro Pub, Abel House,
 Station Road Rowlands Gill NE39 1PZ.

Existing & Proposed
 Floor Plans

Stephen Olver

1:50 SHS-MP-01/01 C

This page is intentionally left blank

PROPOSED CONDITIONS 18/05/17

Abel House

Unit 1 & 2
 Station road, Rowlands Gill
 Gateshead
 NE39 1QD

1. The premises are a small micro pub focusing to offer locally produced ales and specialist beers. The ethos of the premises is to promote relaxed environment to be enjoyed predominantly by customers of age range between 50/60years. Alcohol such as spirits and wine sold on the premises shall be that of a "high end" product and no promotions shall be offered for alcohol being sold at discount prices. There will be no change to the operating style of the premises without prior written notice to the Licensing Authority, which shall advise within 21 days whether a formal application for variation or a new licence is required and the licence holder shall comply with that direction.
2. The Premises Licence Holder and Designated Premises Supervisor shall ensure that at all times when premises are open for any licensable activity, there are sufficient, competent staff on duty at the premises for the purpose of fulfilling the terms and conditions of the Licence and for preventing crime and disorder.
3. A Challenge 25 policy shall be adopted ensuring that all members of staff at the premises shall refuse to sell alcohol to anyone who appears to be under the age of 25 and who is seeking to purchase alcohol unless that person provides credible photographic proof of age evidence. Such credible evidence, which shall include a photograph of the customer, will either be a passport, photographic driving licence, military ID or Proof of Age card carrying a 'Pass' logo.
4. A refusals ledger shall be maintained on the premises to record refusals of all age restricted products and shall be made available to officers of the Licensing Authority or Northumbria Police upon request
5. All staff shall be trained on their responsibilities under the Licensing Act, with a particular focus upon sales and proxy sales of alcohol. Refreshment training will be provided every 6 months. Accurate training records are to be kept for all staff involved in sales of alcohol and training files kept on premises available for inspection by the Police, Trading Standards or the Licensing Authority upon request
6. No patrons shall be allowed to leave the premises whilst in the possession of any open drinking vessel, open bottle or can, whether empty or containing any alcoholic beverage.
7. The Designated Premises Supervisor or other responsible person appointed by the Designated Premises Supervisor shall take part in local Pubwatch meetings as and when they are operating. Full engagement including explanation of what the scheme requires as well as the frequency of such meetings shall be done by the local Neighbourhood Policing Team with the Designated Premises Supervisor or other responsible person prior to any such scheme taking place
8. A CCTV system shall be designed, installed and maintained in proper working order, to the satisfaction of, and in consultation with, Northumbria Police. Such a system shall:
 - i) Be operated by properly trained staff;
 - ii) Be in operation at all times that the premises are open;
 - iii) Ensure coverage of all public entrances and exits, till areas and other areas as required by Northumbria Police;
 - iv) Be kept in a secure environment under the control of the Designated Premises Supervisor or other responsibly named (in writing) individual.
 - v) Have a member of staff present and trained in the retrieval of CCTV footage, with the ability to download the relevant footage onto a disc at the request from Northumbria Police;
 - vi) Cover the inside and outside of the premises
 - vii) Be to an identification standard of all persons entering the premises.
 - viii) Provide continuous recording facilities for each camera to a high standard of clarity. Such recordings shall be retained on tape/disc/hard drive or otherwise for a minimal period of 28 days and shall be supplied to a Police Officer and an authorised Officer of Local Authority on request.

Images recorded are to be retained in an unedited format and the CCTV system must continually record whilst the premises is open to the public.

9. Windows, doors and fire escapes shall remain closed during proposed entertainment events within the premises

APPENDIX 1

LICENSING ACT 2003 - POOL OF MODEL CONDITIONS

CONDITIONS RELATING TO THE PREVENTION OF CRIME AND DISORDER

1. The Licensee, that is the person in whose name the Premises Licence is issued, shall ensure that at all times when the premises are open for any licensable activity, there are sufficient, competent staff on duty at the premises for the purpose of fulfilling the terms and conditions of the Licence and for preventing crime and disorder.
2. The Licensee shall ensure that on each day that door supervisors are engaged for duty at the premises, their details (names and licence numbers) are recorded in an appropriate book kept at the premises. In conjunction with this record book, the licensee shall also keep an incident book. This record book and incident book must be available for inspection by the Police or Authorised Officer at all times when the premises are open.
3. Glass bottles containing beverages of any kind shall not be left in the possession of any patrons after service and following the discharge of the contents into an appropriate glass or drinking vessel.
4. Glass bottles containing wine may be sold for consumption with a meal taken at a table, by customers who are seated in an area set aside exclusively for patrons taking table meals.
5. No persons carrying open or sealed glass bottles shall be admitted to the premises at any time that the premises are open for any licensable activity.
6. One pint and half pint capacity drinking glasses, and highball (tumbler) drinking glasses, in which drinks are served, shall be of strengthened glass (tempered glassware) or of a material whereby in the event of breakage, the glass will fragment with no sharp edges being left. Alternatively, drinks may be served in non-glassware drinking vessels (e.g. plastic, polystyrene, waxed paper).
(Note. Weights and measures legislation requires the use of "stamped glasses" where "meter-measuring equipment" is not in use.)
7. No glass drinking vessels or glass bottles shall be permitted (in the areas described in the attached schedule and delineated on the approved plan.)
8. No patrons shall be allowed to leave the premises whilst in the possession of any drinking vessel or open glass bottle, whether empty or containing any beverage.
(Note. This condition shall not apply to patrons who have purchased beverages for consumption off the premises (within the curtilage of the premises licensed area or in the area covered by a Pavement Café Licence) with the express consent of the Licensee, designated premises supervisor or responsible person.)
9. The Licensee and designated premises supervisor shall ensure that there are effective management arrangements in place to enable them to know how many persons there are in the premises at all times when the premises are open for a licensable activity.

10. The maximum number of persons permitted to assemble on the licensed premises, or relevant part of the licensed premises shall be indicated by a fixed notice bearing the words "Maximum Occupancy" with letters and numbers not less than 20 mm high, conspicuously sited at each relevant part of the premises and at the reception point.
11. All members of staff at the premises including Door Supervisors shall seek "credible photographic proof of age evidence" from any person who appears to be under the age of 25 years and who is seeking access to the premises or is seeking to purchase or consume alcohol on the premises. Such credible evidence, which shall include a photograph of the customer, will either be a passport, photographic driving licence, or Proof of Age card carrying a "PASS" logo.
12. A suitably worded sign of sufficient size and clarity shall be displayed at the point of entry to the premises and in a suitable location at any points of sale, advising customers that they may be asked to produce evidence of their age.
13. A conspicuous notice shall be displayed on or immediately outside the premises adjacent to the entrance to the premises which gives details of times when the premises are permitted to be open for any licensable activity.
14. A conspicuous notice shall be displayed on, or immediately outside the premises, or immediately adjacent to the premises, which gives details of any restrictions relating to the admission of children to the premises.
15. A CCTV system shall be designed, installed and maintained in proper working order, to the satisfaction of the Licensing Authority and in consultation with Northumbria Police. Such a system shall:
 - Ensure coverage of all entrances and exits to the Licensed Premises internally and externally,
 - The till area
 - Ensure coverage of such other areas as may be required by the Licensing Authority and Northumbria Police.
 - Provide continuous recording facilities for each camera to a good standard of clarity. Such recordings shall be retained (on tape or otherwise) for a period of 28 days, and shall be supplied to the Licensing Authority or a Police Officer on request.
 - Be in operation at all times the premises are in use.
16. The Premises Licence Holder and Designated Premises Supervisor shall co-operate with any reasonable crime prevention initiative which are promoted by the Licensing Officer at Gateshead Police Station from time to time.
17. The Premises Licence Holder and Designated Premises Supervisor shall comply with any reasonable measures required by the Licensing Authority from time to time relating to preventing the sale of alcohol to children.
18. A 'Challenge 25' policy shall be adopted, ensuring that all members of staff at the premises shall refuse to sell alcohol to anyone who appears to be under the age of

- 25 and who is seeking to purchase alcohol unless that person provides credible photographic proof of age evidence.
19. Implementing and maintaining a 'Challenge 25' policy, including staff training to prevent underage sales, and ensuring that all members of staff at the premises shall seek credible photographic proof of age evidence from any person who appears to be under the age of 25 and who is seeking to purchase cigarettes and/or alcohol. Such credible evidence, which shall include a photograph of the customer, will either be a passport, photographic driving licence, or Proof of Age card carrying a 'PASS' logo.
 20. Staff are to be made aware of 'proxy sales' and shall refuse sales of alcohol to adults who they suspect are buying alcohol on behalf of children.
 21. Staff shall refuse to sell age restricted products to any adult who they suspect to be passing age restricted products to under age children (i.e. proxy sales). Details of these refusals should also be kept in the ledger.
 22. Staff are to be given sufficient training agreed with the Licensing Authority in the control of age-restricted products, refresher training for existing staff and training for all new staff.
 23. Accurate training records are to be kept for all staff involved in sales of age-restricted products.
 24. A refusals ledger shall be maintained, and made available to Local Authority enforcement officers on request. Refusals to be supported by the CCTV cameras.
 25. Staff are to be provided with an unobstructed view of the area immediately outside the shop and entrance.
 26. Persons under the age of 18 shall only be allowed to enter or remain on the premises prior to 21:00 hours each day, and only when accompanied by a responsible adult, and with the discretion of the Designated Premises Supervisor.
 27. No person carrying open or sealed glass bottles shall be admitted to the premises at any time that the premises are open for any licensable activity.
 28. There shall be displayed suitably worded signage of sufficient size and clarity at the point of entry to the premises and in a suitable location at any points of sale advising customers that underage sales of alcohol are illegal and that they may be asked to produce evidence of their age.

CONDITIONS RELATING TO PUBLIC SAFETY

29. Notices detailing the actions to be taken in the event of fire or other emergency, including how to summon the fire brigade shall be prominently displayed and protected from damage and deterioration.
30. Temporary electrical wiring and distribution systems shall not be provided without notification to the licensing authority at least ten days before commencement of the

- work and prior inspection by a suitable qualified electrician. Premises shall not be opened to the public until the work is deemed satisfactory by the above parties.
31. Where it is not possible to give ten days notification to the licensing authority of provision of temporary electrical wiring and distribution systems, the work shall be undertaken by competent, qualified persons.
 32. All temporary electrical wiring and distribution systems shall be inspected and certified by a competent person before they are put to use.
 33. An appropriately qualified medical practitioner shall be present throughout a sports entertainment involving boxing, wrestling, judo, karate or similar.
 34. Where a ring is constructed for the purposes of boxing, wrestling or similar sports, it must be constructed by a competent person, and inspected by a Building Control Officer of the Council (at the cost of the applicant). Any material used to form the skirt around the ring must be flame retardant.
 35. At any wrestling or other entertainment of a similar nature, members of the public shall not occupy any seat within 2.5 metres of the ring.
 36. Any Licensee wishing to hold a 'Total Fighting' event on the licensed premises shall first apply to the Council for a variation of this licence and in the event that such application is granted, shall comply with any additional conditions that may be imposed. The term 'Total Fighting' shall include any 'full contact' martial arts involving the combined codes of judo, karate and ju-jitsu, judo, sombo and Olympic wrestling or any other mixed martial arts.
 37. At water sports entertainments, staff adequately trained in rescue and life safety procedures shall be stationed and remain within the vicinity of the water at all material times.

CONDITIONS RELATING TO PUBLIC SAFETY IN THEATRES, CINEMAS, CONCERT HALLS AND SIMILAR PLACES

38. The number of attendants on each floor in a closely seated auditorium shall be as set out on the table below:

Number of members of the audience present on a floor	Minimum number of attendants required to be present on that floor
1	One
101	Two
251	Three
501	Four
751	Five
And one additional attendant for each additional 250 persons (or part thereof)	

39. Attendants shall not be engaged in any duties that would hinder the prompt discharge of their duties in the event of an emergency or entail their absence from that floor or auditorium where they are on duty.
40. All attendants shall be readily identifiable to the audience (but this need not entail the wearing of a uniform).
41. The premises shall not be used for a closely seated audience except in accordance with a seating plan(s), a copy of which is available at the premises and shall be shown to any authorised person on request.
42. No article shall be attached to the back of any seat which would reduce the clear width of seatways or cause a tripping hazard or obstruction.
43. A copy of any certificate relating to the design, construction and loading of any temporary seating shall be kept available at the premises and shall be shown to any authorised person on request.
44. Sitting on floors shall not be permitted except where authorised in the premises licence or club premises certificate.
45. Waiting or standing shall not be permitted except in areas designated in the premises licence or club premises certificate.
46. In no circumstances shall anyone be permitted to:
 - sit in any gangway;
 - stand or sit in front of any exit; or
 - stand or sit on any staircase including any landings.
47. Except as authorised by the premises licence or club premises certificate, no drinks shall be sold to, or be consumed by a closely seated audience except in plastic and paper containers.
48. Clothing or other objects shall not be placed over balcony rails or upon balcony fronts.
49. Any special effects or mechanical installation shall be arranged and stored to minimise any risk to the safety of the audience, the performers and staff.
50. Except with the prior written approval of the Council and subject to any conditions, which may be attached to such approval no special effects shall be used on the premises.

Special effects include:

- dry ice machines and cryogenic fog;
- smoke machines and fog generators;
- pyrotechnics, including fireworks;
- real flame;
- firearms;

- motor vehicles;
- strobe lighting;
- lasers (see HSE Guide 'The Radiation Safety of Lasers used for display purposes' [HS(G)95] and BS EN 60825: 'Safety of laser products');
- explosives and highly flammable substances.

51. Where premises used for film exhibitions are equipped with a staff alerting system the number of attendants present shall be as set out in the table below:

Number of members of the audience present on the premises	Minimum number of attendants required to be on duty	Minimum number of other staff on the premises who are available to assist in the event of an emergency
1 - 500	Two	One
501 - 1000	Three	Two
1001 - 1500	Four	Four
1501 or more	Five plus one for every 500 (or part thereof) persons over 2000 on the premises	Five plus one for every 500 (or part thereof) persons over 2000 on the premises

52. Staff shall not be considered as being available to assist in the event of an emergency if they are:

- the holder of the premises licence or the manager on duty at the premises; or
- a member of staff whose normal duties or responsibilities are likely to significantly affect or delay his response in an emergency situation; or
- a member of staff whose usual location when on duty is more than 60 metres from the location to which he is required to go on being alerted to an emergency situation.

53. Attendants shall as far as reasonably practicable be evenly distributed throughout all parts of the premises to which the public have access and keep under observation all parts of the premises to which the audience have access.

54. The staff alerting system shall be maintained in working order and be in operation at all times the premises are in use.

55. The level of lighting in the auditorium shall be as great as possible consistent with the effective presentation of the film; and the level of illumination maintained in the auditorium during the showing of films would normally be regarded as satisfactory if it complies with the standards specified in BS CP 1007 (Maintained Lighting for Cinemas).

CONDITIONS RELATING TO PUBLIC NUISANCE

56. Windows, doors and fire escapes shall remain closed during proposed entertainment events within the premises
57. Noise generated by amplified music shall be controlled by a noise limiting device set at a level determined by the Local Authority Environmental Health Officer, such level being confirmed in writing to the Licensee.
58. Noise limiting devices, once set, cannot be reset or adjusted without consultation with the Local Authority Environmental Health Officer.
59. The lobby doors at the premises shall be kept closed except for access and egress. Door staff shall supervise to ensure that the doors are maintained closed as far as possible when public entertainment is taking place.
60. Clear and legible notices shall be displayed at exits and other circulatory areas requesting patrons to leave the premises having regard to the needs of local residents. In particular, the need to refrain from shouting, slamming car doors and the sounding of car horns shall be emphasised.
61. The premises personal licence holder, designated premise supervisor and door supervisor shall monitor the activity of persons leaving the premises and remind them of their public responsibilities where necessary.
62. Noise and vibration from regulated entertainment shall not be audible at the nearest noise sensitive premises
63. There shall be provided at sufficient regular intervals throughout the premises and grounds, litter bins which shall be emptied and waste removed on a frequent basis, and staff and attendants shall as far as reasonably practicable ensure that the public, members and guests do not litter.

CONDITONS RELATING TO THE PREVENTION OF HARM TO CHILDREN

64. Children under 18 years will not be allowed access to the premises.
65. The club premises certificate holder shall ensure that all attendants (including volunteers and staff) who are to supervise children have been properly vetted (by an enhanced DBS check) and have no convictions that would make them unsuitable to supervise children.
66. There shall be child protection policies agreed with the Licensing Authority and actioned accordingly.

This page is intentionally left blank

REPRESENTATIONS

NEW PREMISES LICENCE APPLICATION

**ABEL HOUSE, UNIT 1 & 2, STATION ROAD, ROWLANDS GILL, NE39
1QD**

Rebecca L Sparrow

From: Phil McCarthy
Sent: 18 May 2017 11:40
To: Rebecca L Sparrow
Subject: Abel House - Unit 1 & 2, Station Road, Rowlands Gill

Rebecca,

I am aware that an application for the Grant of a Premises Licence has been received for the above premises. The application is to open a 'micro pub'.

I can confirm that the proposal would require the benefit of planning permission. At the time of writing the Local Planning Authority has not received a planning application. If a planning application was to be received, it would be determined whilst having regard to all material planning considerations. Consultations would be carried out as part of the planning application process.

I hope the above is clear, if you require anything else just let me know.

Phil

Phillip McCarthy
Assistant Development Manager - Development Management
Development and Public Protection
Gateshead Council
Civic Centre, Regent Street, Gateshead, NE8 1HH
Email: [REDACTED]
Tel: [REDACTED]
www.gateshead.gov.uk

IMPORTANT NOTE: The Council has adopted the Community Infrastructure Levy (CIL) and has commenced charging the Community Infrastructure Levy (CIL) from 1st January 2017.

All Planning approvals issued after the commencement date will be potentially liable to pay the levy in accordance with the Council's charging schedule.

To enable the Council to calculate the levy liability, additional information will be required to validate applications.

Further details of CIL including the charging schedule can be found at
<http://www.gateshead.gov.uk/Building%20and%20Development/Community-Infrastructure-Levy/Community-Infrastructure-Levy.aspx>.

The Council's website will continue to be updated in the coming weeks.



From: Rebecca L Sparrow
Sent: 18 May 2017 10:39
To: Phil McCarthy
Subject: Representation form

Hi Phil

Further to yesterday's meeting please find attached the representation form we talked about.

MR T. E. BROWN

~~_____~~
STATION ROAD
ROWLANDS GILL
~~_____~~

Refs application for licensed
premises of

ABEL HOUSE

UNIT 1+2.

STATION RD.,

ROWLAND GILL

NE 39 17 P.

(1) I object on the grounds that
the proposed premises, are approximately
~~only~~ only 250 yds from the rear
of the Rowlands Gill Social Club.

Does the village need
another licensed premises so
badly.

(2) I and my wife reside
virtually opposite the premises and
we going to be bothered with
live music seven days a week

~~_____~~

05 MAY 2017

LICENSING SECTION

GATESHEAD COUNCIL

CIVIC CENTRE

REGENT STREET

GATESHEAD

NE8 1HH

STATION ROAD

ROWLANDS GILL

3rd MAY 2017LICENSING APPLICATION FOR ABEL HOUSE UNIT 1 & 2 STATION ROAD

Dear Sirs,

I refer to the very helpful conversation that my wife had yesterday with Dan Lines regarding the above Licensing Application for this property in Rowlands Gill. We recognize that the Licensing Section has fully met its notification requirements as set down in regulations but these are hardly broadscale and may actually result in applications slipping through unopposed because of lack of awareness on the part of affected parties. We only heard about this application via village gossip prompted by social media coverage and, interestingly, conversations held yesterday with many local residents most likely to be impacted revealed that NONE of them had heard anything about the application.

We recognise that there may well be significant support in Rowlands Gill for a pub. Indeed, my wife and I would be in favour of an appropriate pub development, as it would undoubtedly enhance the village. If we are going to have a pub, however, let's make it a proper pub on a proper site with car-parking etc where people can drink and enjoy music without serious impact on local residents' quality of life.

The plan for Abel House does NOT constitute an appropriate development, however. It is more naked opportunism on the part of the applicant than a benefit to the community. We recognize that your remit in licensing is quite narrow and some of the obvious objections to this application technically fall outside your remit but we will share all our concerns with you in the hope

that they will convey the deep-rooted unease that we feel (and which others locally share) and perhaps persuade you to include them in your assessment or simply pass them on to the planners, who will surely have to consult on the plan.

Our understanding is that there are Covenants in place which prevent this kind of development happening. Presumably Gateshead Council will ensure that the Trustees of these Covenants are made aware of the application?

There are so many reasons why this application should be turned down.

First and foremost is the question of noise. Rowlands Gill is a quiet village generally and our house, which overlooks the property involved in the application is in a cluster of houses where the average age of residents is 70+. There is also sheltered accommodation-type property within yards of Abel House. The proposed development is small in size and the prospect is very real that the noise from live bands, recorded music and general revelry will seriously impact on the quality of life of those living nearby. If the development enjoys any success, the crowds turning up will mean that the doors are constantly being opened to allow people to cool down etc, which will mean even louder noise.

There is no provision for car parking at the site, so this will inevitably result in an increase in adjacent side-street parking. This is already a significant problem for us and other residents nearby, due to shoppers and others parking, and we do not believe it is reasonable to expect us to put up with more.

The site of the proposed development is also in a very dangerous place with regard to road safety. It is on a busy main road and is situated between two dangerous bends. The prospect of inebriated customers spilling out of the premises onto the pavement and into the road is very real and very frightening!

Another concern that will be shared by all the local residents is the risk of increased anti-social behaviour. In the days of the Towneley Arms, our properties were routinely prey to rowdiness and vandalism to gardens, fences, hedges etc and even now we all get heartily sick of picking litter, beer

cans and bottles out of our Station Road frontages that passers-by think it is OK to throw away into our gardens etc. Allowing a licence to this property will undoubtedly risk a return to the bad old days!

Finally, we actually struggle to see the justification for granting an alcohol and music licence to Abel House when there is another business less than 200 yards away (The Vale Of Derwent Club) which offers these facilities.

We recognize that there is a fashion fad at present for micro pubs of this type but potential popularity should not override public concern in determining their locations. They should NEVER be allowed where there is a safety risk or likely diminution in quality of life for nearby residents.

I hope you find the above arguments persuasive and that you will reject the licensing application or, at minimum , pass on these serious concerns to , say the Planning Department, for whom they may be somewhat more relevant in terms of remit

Thanks you for taking time to read this

Yours faithfully



Lindsay J Williams (Mr)



08 MAY 2017

Representations on a Current Application for a Grant/Variation/Review of a Premises Licence or Club Premises Certificate under The Licensing Act 2003

Before completing this form please read the Guidance Notes at the end of the form

If you are completing this form by hand please write legibly in block capitals. In all cases ensure that your answers are inside the boxes and written in black ink. Use additional sheets if necessary. You may wish to keep a copy of the completed form for your records.

I/We (Insert name) Robert Allan Steele

Wish to make representation about the application for variation/grant for a premises licence/club premises certificate (delete as applicable)

PART 1 – PREMISES OR CLUB PREMISES DETAILS

Postal Address of Premises or Club Premises, or if none, ordnance survey map reference or description Abel House, Unit 1 & 2 Station Road	
Post Town Rowlands Gill	Post Code NE39 1QD

Name of premises licence holder or club holding club premises certificate (if known) Mr Stephen Olver

Number of premises licence or club premise certificate (if known)
--

PART 2 – DETAILS OF PERSON MAKING REPRESENTATION

Please
Tick ✓

- | | | |
|----|---|-------------------------------------|
| 1) | A responsible authority (please complete (C) below) | <input type="checkbox"/> |
| 2) | A member of the club to which this representation relates (please complete (A) below) | <input type="checkbox"/> |
| 3) | Other persons (Please complete (A) or (B) below) | <input checked="" type="checkbox"/> |

DETAILS OF INDIVIDUAL MAKING REPRESENTATION (fill in as applicable)

Mr Mrs Miss Ms Other Title (for example, Rev)

Surname

First Names

I am 18 years old or over Yes (Please Tick)

Current Address	<input type="text" value="The Avenue"/>		
Post Town	Rowlands Gill	Post Code	<input type="text" value=""/>

Daytime contact telephone number

E-mail address (optional)

(B) DETAILS OF OTHER PARTY MAKING REPRESENTATION (e.g Body or Business)

Name and Address

Telephone Number (If any)	<input type="text" value=""/>
E-Mail address (optional)	<input type="text" value=""/>

(C) DETAILS OF RESPONSIBLE AUTHORITY MAKING REPRESENTATION

Name and Address

Telephone Number (If any)	<input type="text" value=""/>
E-Mail address (optional)	<input type="text" value=""/>

representation relates to the following licensing objective(s)

1. The Prevention of Crime and Disorder
2. Public Safety
3. The Prevention of Public Nuisance
4. The Protection of Children From Harm

Please Tick ✓

-
-
-
-

Please state the ground(s) for representation (please read guidance note 1)

The premises, which are proposed for licensing are very close to bungalows both adjacent to and particularly behind Abel House who would suffer Public Nuisance from noise if a licence for live music was granted. The vast majority of residents are elderly and would not welcome this nuisance. There is also an issue of Public Safety if customers stand outside and smoke on the pavement whilst drinking (which happens outside most pubs) on a very busy main road.

Please provide as much information as possible to support the representation

(Please read guidance note 2)

In the past when Booze Busters was open on the corner of Station Road and Taylor Avenue groups of teenagers often gathered outside drinking and throwing litter into gardens.

Please Tick ✓

Have you made any representation relating to these premises before?

If Yes, please state the date of that representation

Day		Month		Year			

If you have made representation before relating to this premises please state what they were and when you made them.

How We Collect And Use Information

The information collected, on this form and from supporting evidence, by Gateshead Council will be used to process your application. The information may be passed to other Enforcement Agencies as permitted by law.

We may check information provided by you, or information about you provided by a third party, with other information held by us. We may also get information from certain third parties, or give information to them to check the accuracy of information, to prevent or detect crime, or to protect public funds in other ways, as permitted by law. These third parties include Government Departments and local authorities.

Will not disclose information about you to anyone outside Gateshead Council nor use information about you for other purposes unless the law permits us to.

Gateshead Council is the Data Controller for the purposes of the Data Protection Act 1998. If you want to know more about what information we have about you, or the way we use your information, you can ask at Civic Centre, Regent Street, Gateshead, NE8 1HH

Part 3 – Signatures (Please read guidance note 3)

Signature of representative or representatives solicitor or other duly authorised agent. (See guidance note 4) If signing on behalf of the representative please state in what capacity.

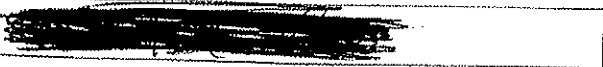
Signature		Date	3/09/17
Capacity			

Contact name (where not previously given) and address for correspondence associated with this representation. (Please read guidance note 5)	
Post Town	Post Code

Telephone Number (if any)	
E-mail Address (optional)	

Notes for Guidance

1. The ground(s) for representation **must** be based on one or more of the licensing objectives.
2. Please list any additional information or details for example dates of problems, which are included in the grounds for representation, if applicable.
3. The representation form must be signed.
4. A representative's agent (for example solicitor) may sign the form on their behalf provided that they have actual authority to do so.
5. This is the address which we shall use to correspond with you about this representation.
6. For further information about the Licensing Act 2003 please contact: The Licensing Act Section, Development & Public Protection, Civic Centre, Regent Street, Gateshead Tyne and Wear NE8 1HH Tel: 0191 433 3918 or 0191 433 3178

COMMUNITIES & ENVIRONMENT

Station Road
Rowlands Gill
Tyne and Wear

11 MAY 2017

Licensing Section
Gateshead Council
Civic Centre
Regent Street
Gateshead
NE8 1HH

9th May 2017

Dear Sir or Madam

Re: License Applications - Abel House, Unit 1 & 2, Station Road, Rowlands Gill.

We are aware of the applications made on 21 April 2017 with regard to the above property in respect of:

Provision of regulated entertainment (live music)
Provision of regulated entertainment (recorded music and anything of a similar description)
Supply of alcohol.

We are close neighbours of the above property and would wish to object in the strongest terms to the proposed use of this property under this set of applications.

The property, as part of a small terrace of retail units, is closely surrounded on all sides by residential properties, and adjoins properties on The Avenue to the rear. Across Station Road further residential properties neighbour the property, together with accommodation for older people at Hollydene.

It is of course the case that there is no parking provision available for this venture, hence the already difficult parking position in Rowlands Gill would be made even worse by the granting of such an application. Clearly this would cause cars to be either parked in adjoining residential streets which do not have capacity, or to be illegally parked as happens already in the case of the existing retail units and the local betting shop just to the east of the property.

The opening of a venue to provide live and recorded music, together with the sale of alcohol represents a totally inappropriate use of the property and one which takes no heed of the requirements of local residents and the existing use of the surrounding streets and properties. It would, in view of its position, cause users of the property to park inappropriately and create noise and potential nuisance for immediate neighbours and wider residents alike.

Continued

11

It is the case that National Trust now offer food and drink experiences in the early evening on selected days of the week and promote music events to the wider community at Gibside throughout the year. This is to be applauded and represents an excellent way of offering such amenities in an appropriate venue with all the required room and facilities, rather than in a 'space- challenged' property with no parking and sitting on top of local residents.

We would urge the Licensing authority to reject these applications and to send a firm message that this is a residential area which is not appropriate for the imposition of evening entertainment.

We thank you for your assistance in this matter.

Yours faithfully,

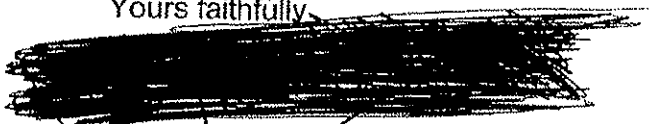

Mr G and Mrs A Smith
Residents

Representations on a Current Application for a Grant/Variation/Review of a Premises Licence or Club Premises Certificate under The Licensing Act 2003

Before completing this form please read the Guidance Notes at the end of the form

If you are completing this form by hand please write legibly in block capitals. In all cases ensure that your answers are inside the boxes and written in black ink. Use additional sheets if necessary. You may wish to keep a copy of the completed form for your records.

I (insert name)

Graham Smith

Wish to make representation about the application for variation/grant for a premises licence/club premises certificate (delete as applicable)

PART 1 – PREMISES OR CLUB PREMISES DETAILS

Postal Address of Premises or Club Premises, or if none, ordnance survey map reference or description	
Abel House, Unit 1 & 2, Station Road,	
Post Town	Post Code
Rowlands Gill	NE39 1QD
Name of premises licence holder or club holding club premises certificate (if known)	
Not Known	
Number of premises licence or club premise certificate (if known)	
Not Known	

PART 2 – DETAILS OF PERSON MAKING REPRESENTATION

- | | |
|--|-------------------------------------|
| | Please
Tick ✓ |
| 1) A responsible authority (please complete (C) below) | <input type="checkbox"/> |
| 2) A member of the club to which this representation relates (please complete (A) below) | <input type="checkbox"/> |
| 3) Other persons (Please complete (A) or (B) below) | <input checked="" type="checkbox"/> |

(A) DETAILS OF INDIVIDUAL MAKING REPRESENTATION (fill in as applicable)

Mr Mrs Miss Ms Other Title (for example, Rev)

Surname
Smith

First Names
Graham

I am 18 years old or over Yes (Please Tick)

Current Address	[REDACTED] Station Road		
Post Town	Rowlands Gill	Post Code	[REDACTED]

Daytime contact telephone number [REDACTED]

E-mail address (optional) [REDACTED]

(B) DETAILS OF OTHER PARTY MAKING REPRESENTATION (e.g Body or Business)

Name and Address

Telephone Number (if any)	
E-Mail address (optional)	

(C) DETAILS OF RESPONSIBLE AUTHORITY MAKING REPRESENTATION

Name and Address

Telephone Number (if any)	
E-Mail address (optional)	

Representation relates to the following licensing objective(s)

- | | Please
Tick ✓ |
|---|--------------------------|
| 1. The Prevention of Crime and Disorder | ✓ |
| 2. Public Safety | ✓ |
| 3. The Prevention of Public Nuisance | ✓ |
| 4. The Protection of Children From Harm | <input type="checkbox"/> |

Please state the ground(s) for representation (please read guidance note 1)

1. Prevention of Crime and Disorder

The opening of a venue to provide live and recorded music, together with the sale of alcohol represents a totally inappropriate use of the property and one which takes no heed of the requirements of local residents and the existing use of the surrounding streets and properties. It would, in view of its position, cause users of the property to park illegally, on the main 'Station Road' as happens with the bookmakers shop further east of the premises already, adding to the existing flouting of parking laws.

The property has a frontage onto the main road and adjoins further units which allow for customers to gather around the side of the units, adjacent to residential properties, encouraging trespass, littering, and general anti-social behaviour with the benefit of drunkenness. This currently occurs without the addition of a unit selling alcohol and playing live and recorded music, which can only add to the issue.

The police would confirm that only two weeks ago they were called out at midnight as several youths were running through The Avenue into private gardens under the influence of alcohol. The approval of this opening would undoubtedly lead to more instances of this kind. It also has the propensity to encourage alcohol abuse for those under age.

2. Public Safety

The parking issues which this application raises have been covered above, however the absence of parking will undoubtedly lead to vehicles being parked in adjacent streets, specifically Taylor Avenue and Hollydene amongst others, as well as illegal parking on Station Road. Not only is this illegal in the case of Station Road but the parking of cars in surrounding streets challenges the safety of pedestrians, and particularly elderly residents in Hollydene.

The unit will also need to be supplied with the sale of alcoholic drinks, deliveries will be by van or lorry and this will clearly add to the public safety issue as pedestrians walk across the unit frontage.

The bookmakers is already an issue for public safety as the customers pay no heed to the yellow lines and park on Station Road, frequently across the path. This makes it difficult for pedestrians to get past the vehicles and oncoming traffic needs to overtake. Again, approval of this application would be disastrous for the local residents.

3. The property, as part of a small terrace of retail units, is closely surrounded on all sides by residential properties, and adjoins properties on The Avenue to the north. Across Station Road further residential properties neighbour the property, together with accommodation for older people at Hollydene.

There is already a culture of people gathering in and around the area of the proposed premises, drinking and then wandering up Station Road, making noise and throwing litter over residents' fences. This can only be increased with the addition of this license in the area.

Please provide as much information as possible to support the representation

(Please read guidance note 2)

Please
Tick ✓

Have you made any representation relating to these premises before?

No ✓

If Yes, please state the date of that representation

Day		Month		Year			

If you have made representation before relating to this premises please state what they were and when you made them.

How We Collect And Use Information

The information collected, on this form and from supporting evidence, by Gateshead Council will be used to process your application. The information may be passed to other Enforcement Agencies as permitted by law.

We may check information provided by you, or information about you provided by a third party, with other information held by us. We may also get information from certain third parties, or give information to them to check the accuracy of information, to prevent or detect crime, or to protect public funds in other ways, as permitted by law. These third parties include Government Departments and local authorities.

We will not disclose information about you to anyone outside Gateshead Council nor use information about you for other purposes unless the law permits us to.

Gateshead Council is the Data Controller for the purposes of the Data Protection Act 1998. If you want to know more about what information we have about you, or the way we use your information, you can ask at Civic Centre, Regent Street, Gateshead, NE8 1HH

Part 3 – Signatures (Please read guidance note 3)

Signature of representative or representatives solicitor or other duly authorised agent. (See guidance note 4) If signing on behalf of the representative please state in what capacity.

Signature		Date	17 May 2017
Capacity	Individual making representation		

Contact name (where not previously given) and address for correspondence associated with this representation. (Please read guidance note 5)	
Post Town	Post Code

Telephone Number (if any)	As above
E-mail Address (optional)	As above

Notes for Guidance

1. The ground(s) for representation **must** be based on one or more of the licensing objectives.
2. Please list any additional information or details for example dates of problems, which are included in the grounds for representation, if applicable.
3. The representation form must be signed.
4. A representative's agent (for example solicitor) may sign the form on their behalf provided that they have actual authority to do so.
5. This is the address which we shall use to correspond with you about this representation.
6. For further information about the Licensing Act 2003 please contact: The Licensing Act Section, Development & Public Protection, Civic Centre, Regent Street, Gateshead Tyne and Wear NE8 1HH
Tel: 0191 433 3918 or 0191 433 3178

LICENSING

~~_____~~
The Crescent
Rowlands Hill
Syr. West
~~_____~~

Dear Sir

I strongly object to the premises of ABEL HOUSE UNIT 1 & 2 being changed into a licence club for Entertainment and live music.

I would think it would be very noisy and right on my doorstep

I cannot see to these premises being suitable at all

Yours faithfully
~~_____~~

~~Station Road~~
Rowlands Gill

~~12-5-17~~
12-5-17

Dear Sir or Madame,

I was shocked to hear that someone has applied for a licence for music and drinks, at Abel House Unit 1+2.

Station Road, Rowlands Gill.

I live opposite, I am an 88 year old widow. The prospect of all the noise and disturbance fills me with dread. But worse is the knowledge that drinkers who live in the Crescent will cut through my garden. Men who go out drinking will never walk further than they have to. I had that problem before they closed the Towneley Arms.

It is on a busy main road, and there is no space at all for parking.

GATESHEAD COUNCIL

LICENSING

Station Rd,
Rowlands Gill,
Tyne & Wear

14.5.2017

To Whom It May Concern,

We find it unbelievable that an application has been made for Abel House Units 1 & 2 on Station Road, Rowlands Gill to be converted to club licensing premises with provision for regulated entertainment (recommended music and anything of a similar description)

Please note that we STRONGLY OBJECT to this application and trust that Gateshead Council Licensing Authority will turn it down.

Our main objection is that this proposed club is very close to our bungalow and the bungalows of our neighbours who like ourselves are all pensioners !!

We also believe that the premises are unsuitable for club use because :-

a) There is extremely limited parking. (Even for a small club)

b) The premises are very small so presumably the licence would permit only a very limited number of customers.

c) Because of the limited space there would be a potential customer overspill onto the relatively narrow footpath on a busy main road.

d) Also because of the limited space the toilet facilities will also be very limited.

We look forward to hearing a favourable outcome to our objection.

Yours sincerely

COMMUNITIES & ENVIRONMENT

17 MAY 2017

CITIZENSHIP COUNCIL

17 MAY 2017

LICENSING

Station Road
Rowlands Gill

15th May 2017

To whom it may concern re:
Application for license for the provision of alcohol and live music at
Unit 1&2 Able House
Station road
Rowlands Gill

I wish to put forward an objection to the granting of a licence for the serving of alcohol and provision of music at the above venue.

The venue is on an incline and a blind bend on the main road which cuts through the village. It would be a serious distraction to drivers passing through the village.

It is a very busy road with heavy traffic travelling along it throughout the day. It would be a very dangerous place for pedestrians to cross to access or leave the premises, particularly after the consumption of alcohol.

In a matter of a few hundred yards to the rear of the property there is the Vale of Derwent Social Club which offers alcohol and music. This is open to members of the public. Another such facility in the village would not add to the amenities offered.

I believe there is an old covenant on the land hereabouts which does not allow the sale of alcohol within its boundaries.

As a long term resident of a property opposite the proposed venue I am appalled to discover this has not been brought to my notice officially and purely by chance I was made aware of the proposals. I hope the council will consider these objections seriously and the impact this could have on the village itself.

Yours sincerely,

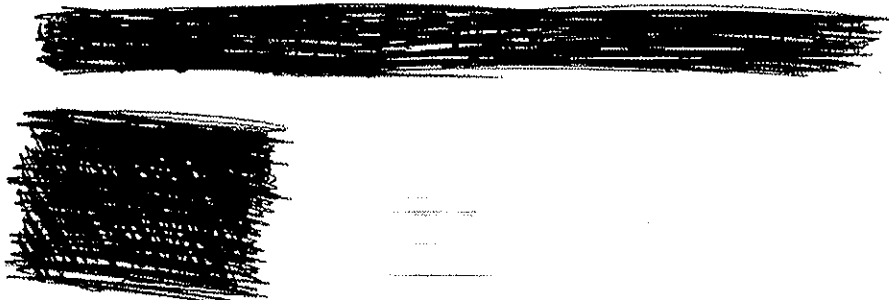
A large, dark, scribbled-out area covering the signature and address of the sender. The scribble is composed of many overlapping, horizontal and vertical lines, completely obscuring any text underneath.

Station Road,
Rowlands Gill,
Tyne and Wear,

Licensing section,
Gateshead Council,
Civic centre,
Regent Street, Gateshead,
NE8 1HH.

GATESHEAD COUNCIL
1
LICENSING

Dear Sirs,

Abel House, Units 1 & 2, Station Road, Rowlands Gill, NE39 1QD

I wish to lodge a formal objection to the application for a drinks and music licence for the above property on the following grounds:-

Prevention of Public Nuisance.

The inclusion of regulated entertainment would create noise and disturbance to residents living very close Abel House. We already have past experience of such nuisance from the days when the Towneley Arms Public House existed. Music could be heard from here and there was further noise, disruption and litter when customers left later in the evening.

Public Safety.

The proposed site constitutes a threat to public safety when goods are being delivered, since it lies between two bends on an extremely busy main road with double yellow lines. We already see the effect of delivery vehicles on the straight stretch of road outside village shops causing traffic congestion, irate motorists and pedestrian inconvenience.

I hope that due consideration will be given to these objections, which we know are endorsed by other residents living nearby and we feel that it is an unsuitable site for the proposed development.

Yours faithfully,

Neville and Sheila Stoddart.,

GATESHEAD COUNCIL

13/11/2017

LICENSING

[REDACTED]
Station Road,
Rowlands Gill,
Tyne and Wear,
[REDACTED]

Licensing section,
Gateshead Council,
Civic centre,
Regent Street, Gateshead,
NE8 1HH

Dear Sirs,

Abel House, Units 1 & 2, Station Road, Rowlands Gill, NE39 1QD

I wish to lodge a formal objection to the application for a drinks and music licence for the above property.

The site is on a bend in the main road, very close to residential properties to the north and south of the property and would constitute a nuisance in noise and disruption.

There is already a working men's club a few hundred metres to the east of these premises and two outlets selling alcohol a few hundred metres to the west of the premises, with a further club half a mile to the west.

We who live on Station Road have in the past experienced noise, disruption, litter and indiscriminate car parking in surrounding streets when there was a wine shop on the corner opposite to Lloyds Bank. Although a planning issue, Abel House has very limited car parking.

I hope that due consideration will be given to these objections, which we know are endorsed by other residents living nearby.

Yours faithfully,

[REDACTED]

[REDACTED]

[Redacted]

COMMUNITIES & ENVIRONMENT

Rawlands Cell

18 MAY 2017

GATESHEAD COUNCIL

1 MAY 2017

17th May 2017

LICENSING

Dear Sirs,

Having discovered quite by accident yesterday evening of the proposal to grant permission for a micro pub to be sited at the shop unit to be let on Station Road, Rawlands Cell, I would like to lodge my objection to the granting of a license for the sale of alcohol, the playing of music and the change of use of these premises.

Apart from this group of small commercial units, such a proposition of licensed premises in such a small venue in an area of residential bungalows, flats and housing, would be totally inappropriate and create much nuisance with regard to noise, parking and perhaps anti-social behaviour.

Yours faithfully,

[Redacted Signature]

Mrs Elaine Rudman
Licensing Section
Gateshead Council
Civic Centre
Regent Street
Gateshead
Tyne & Wear
NE8 1HH

GATESHEAD COUNCIL

13
LICENSING

10th May 2017

Dear Sir/Madam

We would like to put forward our objection to the application by Mr Stephen Olver for a licence and planning development to open a Micro pub, sell alcohol and provide 'entertainment' at Abel House. Unit 1 & 2 Station Road, Rowlands Gill. Tyne & Wear.

This building is adjacent to our land and this close proximity, with the ensuing constant loud music (electronic or otherwise) means that the innocent peace and enjoyment we benefit from our garden and home at present will be stolen from us.



Apart from the fact there is a covenant on this land relating to alcohol and noise, this proposed site is on a bend on a particularly very busy road with no available parking, resulting in extra inconvenience to the public.

It is our opinion, the noise and nuisance level from this establishment will have repercussions not only on the immediate vicinity but on the peace, character and the community of the village as a whole.

Alcohol can be purchased at FIVE (and consumed at THREE) other premises on Station Road. Is another one really necessary?

We cordially invite the members of the committees to our property to assess for themselves the impact this venue will have on our lives.

Yours faithfully,

William & Heather Woods

The Avenue
Rowlands Gill
Tyne & Wear

TEL: 

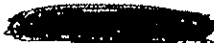
Rebecca L Sparrow

From: Heather Woods [REDACTED]
Sent: 19 May 2017 15:05
To: Rebecca L Sparrow
Subject: Objection re application to open a Micro Pub in Rowlands Gill

Further to our letter of objection to above which we hand delivered to the Licensing Office. Thursday 18TH May 2017.

Having seen the Plan we would like to add other concerns:

There is only ONE entrance/exit door which opens directly onto a well used public footpath alongside the busy main road.

Only ONE toilet is provided which inevitably could lead to patrons urinating in the public area outside the premises, exacerbating a recurring problem at the other end of this block of buildings.

Delivering and collection of stock will create extra hazards for pedestrians and road traffic.
Concerns re Noise when delivering stock and collection of bottles etc.
Where will the bottle bin be sited?

Smoking related litter

Noisy revellers entering and leaving the premises causing a public nuisance.

Constant loud noise from amplified music again causing a public nuisance.

.....

Heather & William Woods

Mrs Elaine Snell

[REDACTED]
Station Road
Rowlands Gill
[REDACTED]

17 May 2017

To whom it may concern

I am writing to you to lodge my objection to the proposed change of use of Abel House, Unit 1 & 2, Station Road, Rowlands Gill, NE39 1QD from a retail unit to a club licensed to serve alcohol and the provision of regulated entertainment (live music).

The reasons for my objection are as follows:

- The proposed club is in close proximity to a well-established residential area. The noise and increased number of people in the locality will have a negative impact on the quality of life of those residents living in close proximity to the establishment.
- It is proposed that live music will take place between the hours of 17.00 – 20.00 on a Sunday evening, a time of day when local residents should not be subjected to noise disruption.
- There is no available parking for those visiting the establishment which will add to the parking problems that already exist in the surrounding streets. For example, despite there already being double yellow lines outside Lloyds Bank these are ignored on a daily basis causing congestion problems when accessing the junction from Station Road onto Taylor Avenue.
- The door of the proposed site opens directly onto the pavement which is the main access route to and from the village and adjacent to a busy main road. This route is used by a significant number of pedestrians and the increased numbers of people entering and exiting the premises at peak times will only add to the congestion.

Yours faithfully,

[REDACTED]
Elaine Snell

Representations on a Current Application for a Grant/Variation/Review of a Premises Licence or Club Premises Certificate under The Licensing Act 2003

Before completing this form please read the Guidance Notes at the end of the form

If you are completing this form by hand please write legibly in block capitals. In all cases ensure that your answers are inside the boxes and written in black ink. Use additional sheets if necessary. You may wish to keep a copy of the completed form for your records.

I/We (insert name) JANET BRONIE

Wish to make representation about the application for variation/grant for a premises licence/club premises certificate (delete as applicable)

PART 1 – PREMISES OR CLUB PREMISES DETAILS

Postal Address of Premises or Club Premises, or if none, ordnance survey map reference or description	
ABEL HOUSE UNIT 1+2 STATION ROAD, ROWLANDS GILL NE39 1QB	
Post	Post Code NE39 1QB

Name of premises licence holder or club holding club premises certificate (if known)

Number of premises licence or club premise certificate (if known)

PART 2 – DETAILS OF PERSON MAKING REPRESENTATION

- | | |
|--|-------------------------------------|
| | Please
Tick ✓ |
| 1) A responsible authority (please complete (C) below) | <input type="checkbox"/> |
| 2) A member of the club to which this representation relates (please complete (A) below) | <input type="checkbox"/> |
| 3) Other persons (Please complete (A) or (B) below) | <input checked="" type="checkbox"/> |

(A) DETAILS OF INDIVIDUAL MAKING REPRESENTATION (fill in as applicable)

Mr Mrs Miss Ms Other Title (for example, Rev)

Surname
Brodie

First Names
Janet

I am 18 years old or over Yes (Please Tick)

Current Address [REDACTED]	[REDACTED]		
Post Town	Rowlands Gill	Post Code	[REDACTED]

Daytime contact telephone number [REDACTED]

E-mail address (optional)

(B) DETAILS OF OTHER PARTY MAKING REPRESENTATION (e.g Body or Business)

Name and Address

Telephone Number (if any)	
E-Mail address (optional)	

(C) DETAILS OF RESPONSIBLE AUTHORITY MAKING REPRESENTATION

Name and Address

Telephone Number (if any)	
E-Mail address (optional)	

This representation relates to the following licensing objective(s)

- | | Please
Tick ✓ |
|---|--------------------------|
| 1. The Prevention of Crime and Disorder | <input type="checkbox"/> |
| 2. Public Safety | <input type="checkbox"/> |
| 3. The Prevention of Public Nuisance | <input type="checkbox"/> |
| 4. The Protection of Children From Harm | <input type="checkbox"/> |

Please state the ground(s) for representation (please read guidance note 1)

Rowlands Gill is a peaceful village, no anti-social behaviour issues which is why most people have chosen to live there myself being one of them, moving from Whickham many years ago. The size of the premises and the position regarding the main road and surrounding area, I find it totally unreasonable that anyone would be given a license to sell alcohol and play music in this kind of neighbourhood.

I feel it would create anti-social behaviour as there are no public houses within the area therefore it would attract the wrong kind of people. Public safety would be an issue as the area is so near to the main road, where would the smokers go with their drinks!!!. How would people who were maybe going to the park or the shops get past. I think that people with pushchairs and children would be put at risk if they had to step on to the road. Would it create a litter issue as everyone knows that when smokers have finished they do not always put the cigarette ends in the bins provided, another issue is there room to put a bin which out causing an obstruction outside of the premises.

Another issue which I know is not mentioned would be the parking, would people park in the street opposite again this would cause a nuisance to people who already live there. The clear majority of the people who live opposite are elderly, would they want music and bands playing through the afternoon and early evening I don't think so. My parents are in their eighties and live opposite the premises and this is causing them great distress, they are worried about it effecting the price of their property, would people cut through their gardens at closing time, the noise and nuisance issues. My father is very ill and he is concerned of the mentioned issues which my Mother will have to deal with on her own which will make her feel unsafe in her own house.

What impact would it have on people driving through the village, the area is so small what about drivers safety when the premises close on a night would they spill out on to the main road.

As always, the decision will be made by someone who doesn't live in the area so it will not encroach on their lives, however I hope that there is enough objection to stop this bazaar idea going forward.

Please
Tick ✓

Have you made any representation relating to these premises before?

If Yes, please state the date of that representation

Day		Month		Year			

If you have made representation before relating to this premises please state what they were and when you made them.

How We Collect And Use Information

The information collected, on this form and from supporting evidence, by Gateshead Council will be used to process your application. The information may be passed to other Enforcement Agencies as permitted by law.

We may check information provided by you, or information about you provided by a third party, with other information held by us. We may also get information from certain third parties, or give information to them to check the accuracy of information, to prevent or detect crime, or to protect public funds in other ways, as permitted by law. These third parties include Government Departments and local authorities.

We will not disclose information about you to anyone outside Gateshead Council nor use information about you for other purposes unless the law permits us to.

Gateshead Council is the Data Controller for the purposes of the Data Protection Act 1998. If you want to know more about what information we have about you, or the way we use your information, you can ask at Civic Centre, Regent Street, Gateshead, NE8 1HH

Part 3 – Signatures (Please read guidance note 3)

Signature of representative or representatives solicitor or other duly authorised agent. (See guidance note 4) If signing on behalf of the representative please state in what capacity.

Signature		Date	18.05.2017
Capacity	REPRESENTATION		

Contact name (where not previously given) and address for correspondence associated with this representation. (Please read guidance note 5)	
Post Town	Post Code

Telephone Number (if any)	
E-mail Address (optional)	

Notes for Guidance

1. The ground(s) for representation **must** be based on one or more of the licensing objectives.
2. Please list any additional information or details for example dates of problems, which are included in the grounds for representation, if applicable.
3. The representation form must be signed.
4. A representative's agent (for example solicitor) may sign the form on their behalf provided that they have actual authority to do so.
5. This is the address which we shall use to correspond with you about this representation.
6. For further information about the Licensing Act 2003 please contact: The Licensing Act Section, Development & Public Protection, Civic Centre, Regent Street, Gateshead Tyne and Wear NE8 1HH
Tel: 0191 433 3918 or 0191 433 3178

We the undersigned strongly object to the opening of a Micro Pub on Station Road, Rowlands Gill.

We believe this will create extra traffic congestion with haphazard parking and noise which will detract from the peaceful nature and charm of the village.

PRINT NAME	SIGNATURE	ADDRESS
[REDACTED]	[REDACTED]	[REDACTED]
A BOWE	[REDACTED]	THE AVE R GILL
S HERBERT	[REDACTED]	THE AVE R GILL
P DUFFY	[REDACTED]	[REDACTED]
W. KELLS	[REDACTED]	[REDACTED]
G. KELLS	[REDACTED]	Taylor Ave R Gill
R. BOW	[REDACTED]	Taylor Ave R Gill
M. BOW	[REDACTED]	" "
N. ROSE	[REDACTED]	" "
G. LAWS	[REDACTED]	TAYLOR AVE
R. LAWS	[REDACTED]	TAYLOR AVE
S. WILSON	[REDACTED]	[REDACTED]
A. KELLY	[REDACTED]	[REDACTED]
Peter W. Wilson	[REDACTED]	The Ave R Gill
LESLIE WILSON	[REDACTED]	" "
[REDACTED]	[REDACTED]	[REDACTED]
MARGARET JACKSON	[REDACTED]	The Avenue.
JOHN JACKSON	[REDACTED]	THE AVENUE. R GILL
JOHN SPICKARD	[REDACTED]	[REDACTED]
JOHN YOUNG	[REDACTED]	WORTHY LANE, R. GILL
R. KNOLLO	[REDACTED]	R. GILL
G. EARLE	[REDACTED]	" "
M. WHARTON	[REDACTED]	" "

1 of 5

We the undersigned strongly object to the opening of a Micro Pub on Station Road. Rowlands Gill.

We believe this will create extra traffic congestion with haphazard parking and noise which will detract from the peaceful nature and charm of the village.

PRINT NAME	SIGNATURE	ADDRESS
A WELSH	[REDACTED]	BUNOPPEL RD. ROWLANDS GILL
S ORMAN	[REDACTED]	BARKWOOD RP R/AM
C YOUNG	[REDACTED]	NORMAN RD R/GILL
M. BROWN	[REDACTED]	S/SHEWAN R/AM
D. SIMMONS	[REDACTED]	The Avenue
M. SIMMONS	[REDACTED]	THE AVENUE Rowland Gill
N. PARKER	[REDACTED]	BUNOPPEL ROAD
B. HALL	[REDACTED]	Southwood Crescent
R. HAMPSON	[REDACTED]	WINKATON
R. HANDY	[REDACTED]	Rowlands Gill
ROBERT YOUNG	[REDACTED]	SPRINGERLY COTT
A. FAIRLESS	[REDACTED]	" " "
J. SIMMONS	[REDACTED]	BARKWOOD ROAD
S. MOSEY	[REDACTED]	BOWES TERR. DITON
B. WILLOUGHBY	[REDACTED]	Wansfield Gardens
J. WELSH	[REDACTED]	Rowlands Gill
A. FAIRLESS	[REDACTED]	Woodland Road
B. GILL	[REDACTED]	NORMAN RD
C. YOUNG	[REDACTED]	Rowland Burn Way
M. CARR	[REDACTED]	GIBSIDE COURT
P. LIGHTFOOT	[REDACTED]	BRIAR RD HAIFIELD
C. JOHNSON	[REDACTED]	BARKWOOD RP
J. BELL	[REDACTED]	WOODLEA R/
Andy Duce	[REDACTED]	BUNNSIDE ROAD
Philip Young	[REDACTED]	NORMAN RD
W. NIXSON	[REDACTED]	
D. WELSH	[REDACTED]	

285

We the undersigned strongly object to the opening of a Micro Pub on Station Road. Rowlands Gill.

We believe this will create extra traffic congestion with haphazard parking and noise which will detract from the peaceful nature and charm of the village.

PRINT NAME	SIGNATURE	ADDRESS
Audrey Haddow	[Redacted]	Denaway
Doris Redpath	[Redacted]	Denaway
Anne Robson	[Redacted]	Thornley Lane
D. Robson	[Redacted]	- do -
Margaret Bennick	[Redacted]	Blamis Crescent
HELEN BROWN	[Redacted]	Domines Close
[Redacted]	[Redacted]	[Redacted]
MARILYN WILLIAMS	[Redacted]	Station Road.
M. Davies	[Redacted]	THE CRESCENT
C. PEACOCK	[Redacted]	STATION ROAD
R. Baldry	[Redacted]	Row. Gill.
J. BALDREY	[Redacted]	STATION RD.
[Redacted]	[Redacted]	" " " "
I. Parnell	[Redacted]	Station Rd.
A. SAKELBY	[Redacted]	" "
G. WOODMAN	[Redacted]	[Redacted]
Lynette Mair	[Redacted]	[Redacted]
SAN MAIR	[Redacted]	[Redacted]
GUY HARRISON	[Redacted]	Station Rd. 7 G
Kate Shalloo	[Redacted]	Station Rd. R. Gill
ALEXANDRA LAW	[Redacted]	STATION ROAD RG.

385

We the undersigned strongly object to the opening of a Micro Pub on Station Road. Rowlands Gill.

We believe this will create extra traffic congestion with haphazard parking and noise which will detract from the peaceful nature and charm of the village.

PRINT NAME	SIGNATURE	ADDRESS
XXXXXXXXXX	XXXXXXXXXX	XXXXXXXXXX
DAVID BELL	XXXXXXXXXX	STATION RD ROWLANDS GILL
K JACKSON	XXXXXXXXXX	THE CRESCENT Rowlands Gill.
S HAWSON	XXXXXXXXXX	THE CRESCENT Rowlands Gill
B. M. GARR	XXXXXXXXXX	CRESCENT Rowlands Gill
G STEPHENSON	XXXXXXXXXX	THE CRESCENT R/GILL
P. STEPHANSON	XXXXXXXXXX	" " "
J SWINBURNE	XXXXXXXXXX	THE CRESCENT R/GILL
F SWINBURNE	XXXXXXXXXX	" " " "
ELIZABETH BELL	XXXXXXXXXX	STATION RD, ROWLANDS GILL
CAROLINE BENTHAM	XXXXXXXXXX	THE CRESCENT, ROWLANDS GILL
BEAYL GARDNER	XXXXXXXXXX	THE CRESCENT ROWLANDS GILL
XXXXXXXXXX	XXXXXXXXXX	XXXXXXXXXX

We the undersigned strongly object to the opening of a Micro Pub on Station Road. Rowlands Gill.

We believe this will create extra traffic congestion with haphazard parking and noise which will detract from the peaceful nature and charm of the village.

PRINT NAME	SIGNATURE	ADDRESS
XXXXXXXXXX	XXXXXXXXXX	XXXXXXXXXX
CHARIS SNELL	XXXXXXXXXX	STATION Rd.
	485	

This page is intentionally left blank



STATEMENT OF LICENSING POLICY

Licensing Act 2003

7 January 2016 - 6 January 2021

1. Foreword by Councillor John McElroy

- 1.1 The Licensing Act has been in force now for ten years, and has contributed to a significant change in how licensable activities are carried on in the Borough.

In Gateshead, both the licensed trade and its patrons are, on the whole, responsible and sensitive to the needs of the communities in which licensed activities take place.

However, the trend away from drinking in pubs and clubs to consumption of alcohol at home presents a different set of challenges in terms of minimizing the harms that can arise.

There has been an increase in the availability and accessibility of alcohol, and a broadening of the type of premises where it is made available. Consequently, there is now an increased role for the licensing regime to play in safeguarding the most vulnerable members of our society.

The licensing regime is not only about the sale and supply of alcohol – the provision of regulated entertainment and late night refreshment equally present challenges to ensure that crime, disorder and public nuisance are prevented, public safety is promoted and children are protected from harm.

There is no single answer to the challenges we will face in the coming months and years; but the licensing regime is key to giving residents and responsible authorities an opportunity to have their say on important matters that can impact their community, and I would encourage everyone to utilise it to its fullest potential.

2. Strategic Context

- 2.1 The Council's overall vision for Gateshead, as described in Gateshead Strategic Partnership's Community Strategy – Vision 2030 and the Council's Corporate Plan is:

"Local people realising their full potential, enjoying the best quality of life in a healthy, equal, safe, prosperous and sustainable Gateshead"

- 2.2 The licensing of premises plays an important role in realising this vision, contributing significantly to the Economy, Environment, and Health areas contained within Priority 1 of the Corporate Plan, in providing safe and accessible venues that promote healthy lifestyles and contribute to economy of the Borough.
- 2.3 This Policy sets out what this Licensing Authority expects of the people that it authorises to carry out licensable activities in the Borough of Gateshead.
- 2.4 Applicants and licensees are of course expected to be familiar with the relevant legislation and the National Guidance issued by the Home Office, but they are also expected to be familiar with the exigencies of the locality that they operate in. This applies to everyone seeking to carry on licensable activities in the Borough, whether they are a large national chain or a small community premises.

- 2.5 The promotion of the licensing objectives underpins every decision that the Licensing Authority makes. How the objectives are best promoted can vary from place to place, and depending on the nature and scale of the activities that are to be carried out. This Policy sets out the issues that are of particular relevance or concern within Gateshead, and the approaches that this Licensing Authority would expect responsible licensees to take into account in their operation.
- 2.6 The Policy links closely with a number of key plans and strategies produced by the Council and its partners, as set out below in the section headed 'Integration with other legislation, policies and guidance'.

3. Local context

- 3.1 Gateshead is located on the southern bank of the river Tyne, opposite Newcastle upon Tyne to the north, and bordering County Durham to the south, Northumberland to the west and South Tyneside/Sunderland to the east. It is a constantly changing borough combining modern facilities with a fascinating heritage. The borough stretches almost 13 miles along the south bank of the river Tyne and covers 55 square miles, making it the largest of the five Tyne and Wear authorities.
- 3.2 Gateshead is a borough of contrasts. It has a large urban hub centred around the main town centre area in Bridges ward and has a number of smaller urban centres and busy employment areas such as Blaydon, Whickham, Felling and Birtley. However, around two thirds of the borough is rural with numerous small settlements such as Kibblesworth, Sunnyside, Chopwell and High Spenn.
- 3.3 Built on traditional industries of mining and heavy engineering, the 1930's saw diversification through the development of the Team Valley Trading Estate (TVTE), the first trading estate of its type in the UK. Centrally located for the region the TVTE has become prominent for transport and distribution activities and is the borough's most prestigious employment centre, attracting the highest number of inward commuters to the borough on a daily basis.
- 3.4 The 1970s saw the decline of many of the region's traditional industries. A high proportion of those who lived in Gateshead worked in these industries, resulting in unemployment and high levels of deprivation and financial/social exclusion, the impact of which is still being felt today. In the 1980's Gateshead saw the development of the MetroCentre, now boasting over two million sq ft of retail and leisure floor space, one of the UK's and Europe's largest shopping centres.
- 3.5 The urban core, shared with Newcastle, is the focus of regeneration, promoting growth through the digital economy, knowledge-based businesses and cultural-led regeneration. Major initiatives such as the Sage Gateshead, BALTIC Centre for Contemporary Art, Gateshead College and the Gateshead Millennium Bridge have all been developed over recent years.
- 3.6 Gateshead has a population of around 200,000 living in 90,600 households. The population has reduced by around 13,000 since the 1980's but has grown over the last decade by around 8,000. This growth has been most significant for older age groups with an 11% increase in 45-64 year olds and an 11% increase in those aged 65 and over. In contrast, the number of 0-24 year olds fell slightly by 0.7%

over the decade. Population projections from the Office for National Statistics predict that this ageing population trend will continue into the future, becoming more pronounced as life expectancy continues to increase.

Crime and anti-social behaviour in Gateshead

- 3.7 The number of recorded crimes across the Borough that were linked to alcohol has increased year on year, with 1,386 alcohol-related crimes recorded in 2014/15 which was an 11% increase from 2013/14, compared to a 7% increase in all crime.
- 3.8 More than half the alcohol-related crimes in the Borough in 2014/15 were violence against the person, with significant increases particularly in the number of assaults. It is notable that whilst incidents of the most serious violence are still relatively infrequent, they have more than doubled in the last year. There have also been significant increases in the numbers of alcohol-related sexual offences and burglaries in the Borough in that time.
- 3.9 Temporal profiles show that almost half of all alcohol-related crimes in the Borough are reported on Friday late evenings / Saturday early mornings, Saturday late evenings / Sunday early mornings and (to a lesser extent) Sunday late evenings / Monday early mornings.
- 3.10 Data provided by Northumbria Police enables the Council to identify the most vulnerable locations throughout the Borough in terms of alcohol-related crimes, and to track trends over time. Information about these areas is contained in 'Local Licensing Guidance' documents which are described in further detail below, and will be available from the Council's website and upon request.

Public health in Gateshead

- 3.11 In 2012 the Police and Social Responsibility Act 2011 introduced public health as a responsible authority under the Licensing Act 2003.
- 3.12 Public health is "the science and art of promoting and protecting health and well-being, preventing ill-health and prolonging life through the organised efforts of society." The Public Health Outcomes Framework acknowledges that health is influenced not only by lifestyle choices but also by a range of wider determinants, including the physical environment, domestic abuse, violent crime and noise nuisance.
- 3.13 Gateshead Council recognises the impact upon population-level health that alcohol consumption can cause. While the protection of public health is not a discrete licensing objective, it can where appropriate permeate each of the licensing objectives.
- 3.14 Each year Gateshead's Director of Public Health publishes an Annual Report, the most recent at the time of writing being published in October 2014. The report recognises that alcohol is a complex social issue which forms part of our everyday social fabric, is a source of pleasure and enjoyment to many; but is also a potentially addictive substance which is promoted by powerful commercial forces, especially to young people. It highlights the growing evidence of rising alcohol

harm on the health of people in Gateshead, and focusses on approaches to tackling alcohol harm.

3.15 The report identifies, for instance, that:

- Around one in 5 secondary school / higher education students in Gateshead admit to drinking alcohol; and
- The number of alcohol specific hospital admissions for secondary school / higher education students in Gateshead is increasing.

3.16 Public health data enables the Council to identify the most vulnerable locations in the Borough in terms of alcohol-related harm, and to track trends over time. This data can be particularly relevant to the protection of children from harm, and may also assist in the prevention of crime and disorder, public nuisance and to public safety.

Local Licensing Guidance

3.17 Different localities within the Borough have different characters, and challenges, both of which can change over time depending on a range of factors. To assist applicants and licensees in their understanding of local issues that they should be cognisant of, from time to time the Council publishes and updates 'Local Licensing Guidance' documents on its website.

3.18 The Local Licensing Guidance provides information about the causes of serious and chronic concern in these localities. The areas covered by the guidance can vary depending on the nature of the problems that are identified, so may relate to the whole of a particular Ward or for instance to street level. The guidance can include a wide range of information that is considered to be relevant to those who seek to carry on licensable activities within the area, for instance:

- The physical environment (including transport, school walking routes, blocks of flats, commercial / residential proximity, etc)
- Existing licensed premises
- Health data (such as hospital admissions for under-18s, ambulance calls for alcohol related reasons)
- Crime and disorder hotspots
- Known areas of congregation
- Local initiatives (such as Pubwatch, Offwatch, Community Alcohol Partnerships etc)
- Local concerns about the promotion of the licensing objectives (including from Ward Members, community leaders, GPs, schools, etc)

3.19 The Local Licensing Guidance will be produced by the Council's Public Health team with the input of Responsible Authorities and other stakeholders as appropriate; and presented to and approved by the Council's full Licensing Committee.

3.20 It is recommended that applicants and licensees have regard to these documents when considering their operating schedule. In particular, where the Local Licensing Guidance identifies measures that it is believed will help to promote the licensing objectives in respect of certain licensable activities due to the issues that have been

identified, if an applicant or licensee chooses not to adopt those measures this may result in representations being made.

4. Legal Context

4.1 This Statement of Licensing Policy has been prepared in accordance with the provisions of the Act and the Guidance issued by the Home Office under Section 182 of the Act.

4.2 The Licensing Authority is responsible for:

- the licensing of licensable activities under the Licensing Act 2003 (The Act)
- ensuring that those who are authorised under the Act comply with the requirements; and
- ensuring that only those who are duly authorised to carry out licensable activities do so.

4.3 This document sets out the Licensing Authority's policy as to how it will fulfil its obligations and achieve its strategic aims in this respect.

4.4 This Policy should be read in conjunction with the Act itself, the Home Office Guidance, and the other policies and guidance that are referred to in this document.

4.5 This Licensing Authority regards each of the Licensing Objective to be of equal importance.

4.6 This document sets out the policies the Licensing Authority will generally apply to promote the Licensing Objectives when making decisions under the Act, and when addressing non-compliance with the Act itself or any authorisations issued under the Act. The Licensing Authority will consider deviating from the policy on a case by case basis, where it believes it to be appropriate and proportionate in all the relevant circumstances.

5. Integration with other legislation, policies and guidance

5.1 Anyone who is or who seeks to be authorised under the Act to carry out licensable activities in the Borough of Gateshead should be aware of the other legislation, policies and guidance that may apply to their business. Failure to comply with other legislation and/or regulatory regimes can indicate that a licensee is irresponsible, which may call into question their ability to adequately promote the Licensing Objectives.

5.2 Although from the perspective of the business proprietor, there may be an element of crossover between licensing and other regimes, they are separate and are treated as such by the Council.

5.3 Applicants and licensees need to be aware of and have regard to:

- Gateshead Strategic Partnership's Community Strategy – Vision 2030
- the Gateshead Local Plan
- Substance Misuse Strategy
- Culture Strategy

- Gateshead Transport Strategy & Tyne & Wear Local Transport Plan
- The Local Government Declaration on Alcohol signed by Gateshead Council in June 2015

5.4 The Licensing Authority will seek to achieve integration with relevant strategies and their aims in its decision making.

Human Rights

5.5 The Licensing Authority will have particular regard to the following relevant provisions of the European Convention on Human Rights:

- Article 6 that in determination of civil rights and obligations everyone is entitled to a fair and public hearing within a reasonable time by an independent and impartial tribunal established by law
- Article 8 that everyone has the right to respect for their home and private life; and
- Article 1 of the First Protocol that every person is entitled to the peaceful enjoyment of their possessions.

Equality and Diversity

5.6 Applicants and licensees should be aware of their obligations under the Equality Act 2010 and the characteristics protected by the legislation which are:

- Age
- Disability
- Gender reassignment
- Marriage and civil partnership
- Pregnancy and maternity
- Race
- Religion and belief
- Sex; and
- Sexual orientation

5.7 It is expected that responsible licensees will be sensitive to the needs of their varied customer base and prepared to make reasonable adjustments to accommodate those needs.

5.8 The Equality Act 2010 also requires the Licensing Authority to have due regard to the need to eliminate discrimination, harassment and victimisation; advance equality of opportunity; and foster good relations between people with different protected characteristics. Each application will be considered with this in mind.

Crime and disorder

5.9 Section 17 of the Crime and Disorder Act 1998 introduced a wide range of measures for preventing crime and disorder and imposed a duty on the Council, Northumbria Police and others to consider crime and disorder reduction in the exercise of all their duties. The reduction of crime and disorder is integral to this Council's approach to the Licensing Act.

Data protection

- 5.10 The Licensing Authority will process personal information in accordance with the Data Protection Act 1998. The personal details provided by applicants will be held on a database and where the law allows, may be shared with other departments within the Council to update details they hold. The Licensing Authority may also be required to disclose personal information to third parties (such as Police, Department for Work and Pensions or Audit Commission for the National Fraud Initiative) for the purposes of preventing or detecting crime or apprehending or prosecuting offenders.

Local Government Declaration on Alcohol

- 5.11 Gateshead Council has signed the Local Government Declaration on Alcohol, and has committed to:
- Promoting the introduction of greater regulations around the price, promotion and availability of alcohol
 - Calling for changes to the Licensing Act in favour of local authorities and communities, to enable greater control on the number, density and availability of alcohol according to local requirements
 - Putting public health and community safety at the forefront of public policy-making about alcohol
 - Making best use of existing licensing powers to ensure effective management of the night-time economy; and
 - Raising awareness of the harm caused by alcohol to individuals and our communities.
- 5.12 It is recognised that the regime under the Licensing Act is only one part of the framework needed to achieve these aims; that in terms of alcohol the Act only regulates its sale and supply – not its consumption; and that the regime cannot be utilised where the Council's aims do not pertain to the objectives set out in the Act.
- 5.13 However the licensing regime has proven to be an effective tool in Gateshead for the control of price, promotion and availability of alcohol:

Price

The sale / supply of cheap alcohol can lead to its over-consumption which in turn can undermine the licensing objectives particularly in respect of the prevention of crime and disorder and the protection of children from harm. This Licensing Authority has imposed and will continue to impose minimum unit price requirements where appropriate to promote the licensing objectives, and as part of a range of measures to tackle identified concerns. For instance, alcohol can be 'cheap' not only due to its price but also due to its strength. Where appropriate this Licensing Authority will also impose conditions to control the sale of certain types of product, such as 'super strength' ciders, spirits, etc.

Promotion

The Government has imposed certain mandatory conditions to prohibit irresponsible drinks promotions where the consumption is intended to take place on the premises. This Licensing Authority will impose further conditions on licences

where it is appropriate and proportionate to do so, which will depend on the individual circumstances. For instance, conditions can be imposed to prevent promotions which are aimed at young people particularly in the vicinity of schools and other locations attended by children, and promotion of potentially dangerous alcoholic products such as cocktails containing liquid nitrogen. Gateshead Licensing Authority's expectations with respect to the promotion of alcohol in off licensed premises are set out in 8.18 below.

Place

There are a range of measures that can assist in controlling the availability of alcohol in defined localities where there is appropriate evidence to support the restriction. These include:

- Cumulative impact policies
- Night time levy
- Early morning restriction orders

The evidential basis to consider implementing any of these measures in Gateshead has not yet been put forward, however if evidence supports their implementation in the future this will be duly considered.

Public Space Protection Orders

5.14 The following locations have been designated as alcohol exclusion areas:

- Gateshead
- at all of the Metro stations in the borough
- Birtley
- Whickham
- Ryton
- Winlaton

5.15 This means that within the exclusion zones it is an offence to refuse to comply with the reasonable request of a Police Constable or authorised officer to stop consuming alcohol or to hand over alcohol for confiscation. Licensed premises (and their curtilages) are excluded from the scope of the Orders while licensable activities are authorised to take place.

Social Responsibility

5.16 The Portman Group has produced a code of practice on the naming, packaging and promotion of alcoholic drinks. Licensees that sell or supply alcohol are expected to have regard to the code of practice as amended from time to time. http://www.portmangroup.org.uk/docs/default-source/code-of-practice/7609_por02_code_of_practice_final.pdf

Pubwatch

5.17 A Pubwatch scheme has been in existence in the Borough for some time. It is led by Northumbria Police, and provides a forum for licensees to gain support from the Police, the Council and other licensees to tackle the problems associated with

individuals who cause disturbance, disorder, use drugs or use or threaten violence in and around licensed premises. By acting collectively in excluding such people from a number of premises in the area, this means that the problem is not simply moved from one pub to the next. Pubwatch schemes have been found to be effective tools in tackling anti-social behaviour in many areas where the schemes are well run and there is a significant level of participation by licence holders in the borough. The Gateshead Alcohol Harm Reduction Strategy 2013-2015 recognises the importance of the Pubwatch scheme and envisages it being used to share and develop best practice and as a forum for training.

Regional and national working

- 5.18 The Licensing Authority participates in regional working through the North East Strategic Licensing Group, which is comprised of representatives of each of the twelve North East Licensing Authorities, and forms part of the North East Public Protection Partnership.
- 5.19 The Licensing Authority also works closely with Balance – the North East Alcohol Office, to achieve an integrated approach across the region and with key partners such as the Police.
- 5.20 From the national perspective, representatives of the Licensing Authority participate in the Local Government Association’s Licensing Policy Forum, and the Licensing Special Area of Activity for Lawyers in Local Government.

6. General Principles of the Policy

- 6.1 Each application will be determined on its merits having regard to this Policy, Guidance under Section 182 of the Act, the Act itself and supporting Regulations.
- 6.2 The Licensing Authority considers:
- the effective and responsible management of premises
 - instruction, training and supervision of staff; and
 - the adoption of best practice

to be amongst the most important control measures for the achievement of all the licensing objectives. For this reason, the Licensing Authority will expect these elements to be specifically considered and addressed within an applicant’s operating schedule.

- 6.3 Applicants who do not clearly demonstrate how they intend to address these issues in their operating schedules should expect their applications to be objected to, including by the Licensing Authority.
- 6.4 Also, licensees whose practice does not meet this expectation may have their licence reviewed, and as above this may be triggered by the Licensing Authority itself.

7. Licensing Objectives

- 7.1 Applicants will need to provide evidence to the Licensing Authority that, in respect of each of the four licensing objectives, suitable and sufficient measures, as detailed in their Operating Schedule, will be implemented and maintained, and will be relevant to the individual style and characteristics of their premises and events.

Prevention of Crime and Disorder

- 7.2 The Licensing Authority will expect to see evidence that the following specific matters that impact on crime and disorder have been addressed in the Operating Schedule of the premises:

- The capability of the person who is in charge to run the premises during trading hours or when Regulated Entertainment is provided to effectively and responsibly manage and supervise the premises, including associated open areas
- The steps to be taken in the absence of the Designated Premises Supervisor to effectively manage the business.
- The steps taken or to be taken to ensure that appropriate instruction, training and supervision is given to those employed or engaged in the premises to prevent incidents of crime and disorder
- The measures taken or to be taken to raise staff awareness and discourage and prevent the use or supply of illegal drugs on the premises
- The features currently in place or planned for physical security at the premises, such as lighting outside the premises
- The policies that have been determined in respect of adoption of appropriate existing and future best practice guidance (eg Safer Clubbing, the National Alcohol Harm Reduction Strategy Toolkit, etc)
- Any arrangements which the licence holder proposes to work in partnership with the Council, police and other traders in establishing a method of co-ordinating closing times to prevent crowds emerging from premises at the same time and to prevent migration between premises with different closing times
- Any appropriate additional measures taken or to be taken for the prevention of violence or public disorder

- 7.3 The extent to which the above matters need to be addressed will be dependent on the individual style, characteristics and location of the premises, and proposed events and activities. In general however, the Licensing Authority will expect more comprehensive measures to be in place at late night entertainment venues or in premises with a history of crime and disorder issues.

- 7.4 In such premises appropriate additional measures taken or to be taken for the prevention of violence or public disorder may include:

- Provision of effective CCTV both within and around premises
- Employment of SIA licensed door staff
- Provision of toughened or plastic glasses
- Procedures for risk assessing drinks promotions and events such as 'happy hours' for the potential to cause crime and disorder and plans for minimising such risks

7.5 The Licensing Authority will have particular regard to representations from the Police in deciding whether the above issues have been adequately addressed. It will not normally grant an application where representations indicate a potential negative impact on crime and disorder, unless the applicant can demonstrate compelling reasons why the application should be approved in the light of these concerns.

Public Safety

7.6 The Licensing Authority will expect to see that applicants have considered the impact that the following factors may have on public safety:

- The occupancy capacity of the premises
- The age, design and layout of the premises, including means of escape in the event of fire
- The nature of the licensable activities to be provided, in particular the sale or supply of alcohol, and/or the provision of music and dancing and including whether those activities are of a temporary or permanent nature
- The hours of operation (differentiating the hours of opening from the hours when licensable activities are provided, if different)
- Customer profile (eg age, disability)
- The use of special effects such as lasers, pyrotechnics, smoke machines, etc

7.7 The following examples of control measures are given to assist applicants who may need to take account of them in their operating schedule, having regard to their particular type of premises and/or activities:

- Suitable and sufficient risk assessments
- Effective and responsible management of the premises
- Provision of a sufficient number of people employed or engaged to secure the safety of the premises and patrons

- Appropriate instruction, training and supervision of those employed or engaged to secure the safety of premises and patrons
- Adoption of best practice guidance (eg Guide to Fire Precautions in Existing Places of Entertainment and like premises, The Event Safety Guide, Safety in Pubs published by the BBPA, and the Safety Guidance for Street Arts, Carnival, Processions and Large Scale Performances published by Independent Street Arts Network)
- Provision of effective CCTV in and around premises
- Provision of toughened or plastic drinking vessels
- Implementation of crowd management measures
- Proof of regular testing (and certification where appropriate) of procedures, appliances, systems etc pertinent to safety)

Prevention of Public Nuisance

- 7.8 The Licensing Authority interprets 'public nuisance' in its widest sense, and takes it to include such issues as noise, light, odour, litter and anti-social behaviour, where these matters impact on those living, working or otherwise engaged in normal activity in an area.
- 7.9 The Licensing Authority will normally apply stricter conditions, including controls on licensing hours, where licensed premises are in residential areas.
- 7.10 The Licensing Authority will expect to see that applicants have considered the impact that the following factors may have on the potential for public nuisance:
- The location of premises and proximity to residential and other noise sensitive premises
 - The hours of opening, particularly between 23:00 and 07:00 hours
 - The nature of activities to be provided, including whether those activities are of a temporary or permanent nature and whether they are to be held inside or outside premises
 - The design and layout of premises and in particular the presence of noise limiting features
 - The occupancy capacity of the premises
 - The availability of public transport
 - 'wind down period' between the end of the licensable activities and closure of the premises, i.e. allowing patrons to remain in the premises for a period after licensable activities have ceased, so that people do not disperse en masse

- last admission time

7.11 The following examples of control measures are given to assist applicants who may need to take account of them in their operating schedule, having regard to their particular type of premises and/or activities:

- effective and responsible management of the premises
- appropriate instruction, training and supervision of those employed or engaged to prevent incidents of public nuisance eg to ensure customers leave quietly
- operating hours for all or parts (eg garden areas) of premises, including such matters as deliveries
- adoption of best practice guidance (eg Good Practice Guide on the Control of Noise from Pubs and Clubs, produced by the Institute of Acoustics, Licensed Property: Noise, published by BBPA)
- installation of soundproofing, air conditioning, acoustic lobbies and sound limitation devices
- management of people, including staff, and traffic (and resulting queues)
- liaison with public transport providers
- siting of external lighting including security lighting
- management arrangements for collection and disposal of litter
- effective ventilation systems to prevent nuisance from odour

Protection of Children from Harm

7.12 The protection of children is an important issue and the licensing regime has a fundamental role in achieving this. The protection of children from harm includes moral, psychological and physical harm and applicants are expected to demonstrate that such factors have been considered in their operating schedules.

7.13 Applicants should expect to receive objections in respect of the protection of children from harm, and licensees should expect their licence to be reviewed, where:

- there have been convictions for serving alcohol to minors or the premises have a reputation for facilitating underage drinking
- there is a known association with drug taking or dealing
- there is a strong element of gambling on the premises
- entertainment of an adult or sexual nature is commonly provided

- 7.14 Licensees will be expected to prevent children from viewing films that are unsuitable because of the age classification of the film that has been imposed by the British Board of Film Classification or the Licensing Authority.
- 7.15 Anyone intending to provide staff for the supervision of activities for under 18s will be expected to carry out enhanced criminal record checks on all such persons, and to keep a register which should be available to the Police or authorised Council officer on request. Applicants who do not put these measures in place should expect objections to be made to their application.
- 7.16 Where applicants intend to provide any age restricted goods or services it is expected that they will apply the same standards of age verification in respect of all age restricted goods or services, that staff will be regularly trained, and that appropriate records are kept of training and refusals.

8. Types of activity that may heighten concern as to the promotion of the licensing objectives

- 8.1 It has been the experience of this Licensing Authority over the last ten years since the Licensing Act came into force that there are certain types of licensable activity that tend to require a greater degree of control or a particular emphasis on certain control measures in order that the licensing objectives are effectively promoted.

Adult entertainment

- 8.2 The term 'adult entertainment' is not defined in the Licensing Act, but it is taken in this policy to refer to activities and form of entertainment that may be unsuitable for children to participate in or to observe. Common examples of adult entertainment include striptease, lap dancing and other forms of dancing /entertainment with a sexual content. Other types of activity may also be 'adult entertainment' such as the showing of films that have been certified '18', total fighting, mixed martial arts, and demonstrations and participation in activities containing elements of bondage, discipline, domination, submission, sadism and/or masochism. This list is clearly not exhaustive, and the Licensing Authority will consider each application on its merits.
- 8.3 Although adult entertainment is permitted by the Licensing Act, it is necessary that licensees set out details of the activities they intend to take place in their operating schedule, so that the Licensing Authority, responsible bodies and others may take appropriate steps to ensure that the Licensing Objectives are not undermined. As such it is important that applicants complete box 'N' of their application form, and provide as much detail as possible regarding the nature of the proposed activities.
- 8.4 If applicants do not complete box 'N' it is the policy of this Licensing Authority to impose a condition on the licence / certificate (if issued), consistent with the operating schedule, that prohibits adult entertainment at the premises. If licensees / certificate holders are then found to have provided adult entertainment in breach of this condition, they may be prosecuted and/or the licence / certificate may be reviewed which could lead to the imposition of further conditions, suspension or revocation.

- 8.12 Applicants and existing licensees / certificate holders should be aware that the presence of gaming machines in licensed premises is considered to be "adult entertainment" and requires notification to the licensing authority in box "N" of the application form otherwise they will not be permitted, as it is the policy of this licensing authority to add a condition, consistent with the operating schedule of each premises where box "N" is not completed, prohibiting adult entertainment at the premises as set out in guidance note 8 of the respective application forms.

Film classification

- 8.13 Where the Licensing Authority is requested to classify a film for exhibition within the Licensing Authority's area, it will do so if the film has not been classified by the British Board of Film Classification, or such classification is not pending.
- 8.14 When an applicant submits a film for classification, they should provide a copy of the film to the Licensing Officer, and should indicate the rating that they consider appropriate. The Licensing Officer shall consult with Northumbria Police and the Local Safeguarding Children Board. The applicant should provide the copy of the film at least 28 days in advance of the proposed screening. If the applicant is unable to provide a copy of the film in DVD format or via a website then they should liaise with the Licensing Officer to arrange for a screening of the film for the relevant bodies as above.
- 8.15 The Licensing Authority shall have regard to any representations received from the Local Safeguarding Children Board and Northumbria Police. The Licensing Authority shall have regard to the classification standards applied by the British Board of Film Classification. The Licensing Authority shall also have regard to (but shall not be bound by) any classification given to the film by another Licensing Authority.
- 8.16 Where a relevant representation is received, the classification of the film shall be determined by a hearing of the Licensing Sub Committee.

Alcohol sales

- 8.17 It is expected that applicants will set out in their operating schedule the measures they will take to ensure that a written record is kept of all the names and addresses of persons who are authorised to sell or supply alcohol at all times, and that the written record is made available to Police and/or Council officers immediately upon request.
- 8.18 It is expected that premises licensed for the sale of alcohol for consumption off the premises will adopt responsible marketing practices and concern may be heightened where alcohol is promoted in such a way as to encourage people to drink more than they would ordinarily do and in a manner that doesn't promote the licensing objectives, for example quantity based discount promotions and display and promotion of alcohol products in multiple positions in a premises.
- 8.19 It is expected that applicants who intend to sell or supply alcohol by delivery or collection of prepaid orders will include provision in their operating schedules to set out how they will ensure that they do not:

- serve alcohol to a person who appears to be drunk
- serve alcohol to a person who it is believed will pass it on to persons under 18 years old
- take payment for the alcohol at the place where it is served – sales should be pre-paid only

8.20 It is also expected that applicants will:

- operate an age verification policy of at least a Challenge 25 standard
- only deliver to residential addresses
- only stock delivery vehicles with alcohol that has been pre-ordered
- verify that the person that the alcohol is served to is the person who has ordered it
- only make sales where the purchase price is at least £25 and/or the minimum unit price of the alcohol is not less than £1 per unit

Petrol stations / garages

8.21 The Licensing Act prohibits the sale or supply of alcohol from premises used primarily as garages. The Section 182 guidance states that premises are used primarily as a garage if they are used for one or more of the following:

- the retailing of petrol
- the retailing of derv
- the sale of motor vehicles; and
- the maintenance of motor vehicles

8.22 It is expected that applicants for premises licences for premises where any of these activities take place will set out in their operating schedule that they will submit sales data on at least a six monthly basis showing:

- the number of purchases of fuel alone
- the number of purchases of fuel and other goods
- the number of purchases of other goods alone, and
- turnover for each of these type of purchases.

Takeaways

8.23 The Licensing Authority will generally not permit the sale of alcohol from 'takeaway' premises that are licensed for late night refreshment, due to the inherent potential for late night alcohol fuelled crime, disorder and anti-social behaviour and the difficulties of addressing such behaviour where the consumption of the alcohol and associated behaviour takes place away from the premises themselves, often in residential areas. Applicants seeking approval to sell alcohol from 'takeaway'

premises will need to clearly demonstrate how they will ensure that their activities will not lead to such problems.

Outside areas

8.24 Where premises include an outside area it is expected that the operating schedule will set out how the applicant will address:

- The provision of appropriate bins and other receptacles for litter generated by patrons
- Measures to reduce the amount of noise generated by patrons, particularly late at night. This may include door supervision, closure of outside areas after a particular time, restricting re-admission to the premises after a particular time, etc
- Provision and placement of appropriate street furniture to prevent persons 'spilling out' onto public highway in the vicinity of the premises
- Provision of CCTV covering entrances and exits, external areas, and surrounding public highways

9. Licensing Hours

9.1 It is expected that premises whose primary activity is off licence sales will not normally be open between 23:00 and 07:00 hours. Applicants wishing to operate beyond 23:00 hours will need to demonstrate to the satisfaction of the Licensing Authority, in their operating schedule, that there will be no significant disturbance to members of the public living, working or otherwise engaged in normal activity around the premises concerned. Opening hours beyond 23:00 hours will generally be considered to be more acceptable for premises in commercial or tourist areas with high levels of public transport availability, rather than premises in predominately residential areas.

9.2 When considering applications, in respect of hours of operation, the Licensing Authority will take the following into consideration:

- Whether the premises is located in a predominantly retail or entertainment area
- The nature of the proposed activities to be provided in the premises
- Whether there are any arrangements to ensure adequate availability of hackney carriages and private hire vehicles and appropriate places for picking up and setting down passengers
- Whether there is an appropriate amount of car parking, readily accessible to the premises, and in places where the parking and use of vehicles will not cause demonstrable adverse impact to local residents

- Whether the operating schedule agreed with Council Officers indicates that the applicant is taking appropriate steps to comply with the licensing objective of preventing public nuisance
- Whether the licensed activity, particularly if located in areas of the highest levels of recorded crime, may result in a reduction or increase in crime or anti-social behaviour
- Whether the licensed activities are likely to cause adverse impact especially on local residents, and that, if there is a potential to cause adverse impact, appropriate measures will be put in place to prevent it.
- Whether there will be any increase in the cumulative adverse impact from these or similar activities, on an adjacent residential area

9.3 In the case of shops, stores and supermarkets selling alcohol, the Licensing Authority will normally expect the hours during which alcohol is sold to match the normal trading hours during which other sales take place, in order to reduce the potential for disturbance or disorder.

10. Operating Schedules

- 10.1 Operating schedules should set out the licensable activities that are intended to be carried out and how it is intended that this happens. Operating schedules should be sufficiently detailed and clear for interested parties and responsible authorities to understand how the applicant or licensee will promote the licensing objectives.
- 10.2 When considering the promotion of the licensing objectives, applicants and licensees should have due regard to the context of the locality that they seek to operate in, and be mindful of any particular concerns that relate to that locality.
- 10.3 For instance, applicants and licensees are expected to have regard to any Local Licensing Guidance in respect of the locality they propose to serve.
- 10.4 Applicants are expected to ensure that their operating schedule enables the Licensing Authority, responsible authorities and interested parties to understand:
- What licensable activities are intended to be carried out
 - When licensable activities will be carried out – i.e. between what hours, on what days and at what times of year
 - When the premises will be open to the public for non-licensed activities
 - Whether alcohol is intended to be sold for consumption off the premises (including where it will be delivered to customers)
 - (Where the sale or supply of alcohol is intended at premises with a Premises Licence) who the Designated Premises Supervisor will be and what his / her address is

- What steps will be taken to promote the Licensing Objectives.

10.5 It is recommended that applicants contact responsible authorities when preparing operating schedules to discuss any relevant concerns.

11. Designated Premises Supervisor

11.1 Designated Premises Supervisors have an important role to play in ensuring that the measures to promote the licensing objectives that are set out in an operating schedule are put into practice on a day to day basis.

11.2 Where there is a requirement for premises to have a Designated Premises Supervisor, it is expected that the person will be a key person related to the premises, so that matters arising can be dealt with as quickly as possible.

11.3 It is expected that a Designated Premises Supervisor will have day to day responsibility for running the premises and will be present at the premises at least 50% of the time in a seven day week that the premises are open for the carrying on of licensable activities.

11.4 Where the Designated Premises Supervisor is not available at the premises for whatever reason, the Licensing Authority will expect an individual to be nominated as a point of contact who will have details of where the Designated Premises Supervisor can be contacted.

11.5 Where there are problems associated with the running of a premises that stem from the DPS's performance of that role, they may be removed from the role by the Licensing Sub-Committee.

12. Conditions

12.1 Whilst the Licensing Act sets out the regulatory framework that applies to all licensees, conditions can be added to individual licences to prescribe how the licensable activities are to be carried out having regard to all the relevant individual circumstances.

12.2 There are three types of condition:

- mandatory conditions imposed by the Secretary of State – applicants and licensees are expected to comply with the relevant mandatory conditions that apply to the activities they carry out, and to be aware that these mandatory conditions change from time to time. The Home Office issued guidance in respect of these mandatory conditions in October 2014:

[https://www.gov.uk/government/uploads/system/uploads/attachment_data/file/350507/2014-08-29 MC Guidance v1 0.pdf](https://www.gov.uk/government/uploads/system/uploads/attachment_data/file/350507/2014-08-29_MC_Guidance_v1_0.pdf)

- conditions imposed voluntarily by the applicant / licensee – these conditions will be consistent with the applicant / licensee's operating schedule, although the wording may be amended to ensure clarity and enforceability. Applicants and licensees should note that in line with this Policy, in certain cases the Licensing Authority will assume unless

informed otherwise that applicants are volunteering conditions. For instance, as above where an applicant does not indicate an intention to provide adult entertainment by ticking box 'N' on their application form, it will be assumed that they are volunteering a condition not to provide adult entertainment at the premises; and

- conditions imposed at a hearing – the Licensing Sub-Committee may impose conditions on a licence where it considers it appropriate to do so. Any such conditions will be appropriate to the promotion of the licensing objectives and proportionate to the problems that the Sub-Committee find in relation to the premises.

12.3 The Licensing Authority does not impose 'standard' conditions on licences, but there are certain factors that most premises that carry out certain licensable activities should take into account. A pool of model conditions is set out in Appendix 1, which applicants should consider when preparing their operating schedule.

13. When things go wrong

Complaints about licensed premises

13.1 The Licensing Authority will investigate complaints about both licensed premises where licensable activities are taking place but not in accordance with the relevant authorisation; and unlicensed premises where licensable activities are taking place without authorisation.

13.2 Complainants will usually, in the first instance, be encouraged to raise the complaint directly with the licensee or business concerned, as this can often be the quickest and most effective way for the person carrying on the licensable activity to understand the negative impact of the activity.

13.3 Where appropriate, the Licensing Authority will initially endeavour to seek a resolution through informal means.

13.4 Where appropriate, the Licensing Authority may pass any complaint on for investigation by any other statutory agency under whose enforcement responsibility the complaint falls.

Failing to comply with the Licensing Act

13.5 The Council delivers a wide range of enforcement services, aimed at safeguarding the environment and the community and at providing a 'level playing field' on which businesses can fairly trade. The administration and enforcement of the licensing regime is one of these services. The BRDO has published a Regulators' Code, which the Council complies with:

<https://www.gov.uk/government/publications/regulators-code>

The Council will base its enforcement activities around the principles of consistency, transparency and proportionality.

- Exclude a licensable activity from the licence or certificate
- Remove the designated premises supervisor
- Suspend the licence or certificate for a period not exceeding three months
- Revoke the licence or certificate.

13.14 The review process is intended to enable the Licensing Authority to take appropriate timely measures to promote the Licensing Objectives in respect of individual premises. A review can take place even if it would be disproportionate to revoke a licence or certificate, as some lesser measure can be taken, as above.

13.15 Also, because the review process is intended to address the future conduct of the licence holder, a review can take place regardless of any other measures that may be open to the interested party or responsible body. For instance, if a licence holder is found to have sold age restricted products to a minor, it is not necessary for a prosecution (or indeed a successful prosecution) to take place in respect of that sale before a review is brought, as the review would consider the steps appropriate to prevent future underage sales.

Summary reviews

13.16 The Police may request a summary review in serious cases of crime and disorder, and in which case within 48 hours of the application the Licensing Authority will consider whether any interim steps are required pending completion of the review process. This may include immediate suspension of the relevant licence.

14. Delegation and Decision Making

14.1 The Council has established a Licensing Committee to administer its functions under the Licensing Act 2003. Powers and functions have also been delegated to Licensing Sub-Committees and officers in order to provide a speedy, efficient and cost effective service to all parties involved in the licensing process.

14.2 Many of the decisions and functions are largely administrative in nature such as the grant of non-contentious applications, including for example those licences and certificates where no representations have been made. These will be delegated to Council officers. All such matters dealt with by officers will be reported for information to the next Licensing Committee meeting.

14.3 Applications where there are relevant representations will be dealt with by the Licensing Committee/Sub-Committee – unless such representations are considered irrelevant, frivolous or vexatious or unless the Licensing Authority, the applicant and everyone who has made representations agrees that a hearing is not necessary (usually after successful mediation).

14.4 The table given below sets out the delegation of decisions and functions of the Licensing Committee, Sub-Committees and officers. The various delegations include delegation to impose appropriate conditions.

14.5 This scheme of delegations is without prejudice to the right of relevant parties to refer an application to a Licensing Sub-Committee or the full Licensing Committee if considered appropriate in the circumstances of any particular case.

- 14.6 Unless there are compelling reasons to the contrary, the Licensing Authority will require the Licensing Committee or any of its sub-committees to meet in public – although Members can retire into private session to consider their decision. A public announcement of the decision will be made at the end of the hearing together with clear, cogent reasons for the decision having due regard to the Human Rights Act 1998, the four licensing objectives and all other legislation.
- 14.7 The Licensing Committee will be made up of 15 members and Sub-Committees of three who will hear any relevant representations from authorised persons, responsible authorities and interested parties in the form of a hearing.
- 14.8 Where a function is delegated to an officer, that officer will be responsible for liaising between the applicant, interested parties and the responsible authorities to ensure that any licence granted is subject to the appropriate conditions. Where objections are made then the officer will once again liaise with the applicant, interested parties and the responsible authorities to see if a 'settlement' is possible to overcome the objections without the need for the matter to go before the Sub-Committee.
- 14.9 The Sub-Committee will determine each case before it on its individual merits. However, in determining the application the Sub-Committee will consider:
- The case and evidence presented by all parties
 - The promotion of the four licensing objectives
 - Guidance issued by Central Government
 - The Licensing Authority's own statement of Licensing Policy

14.10 Delegation of functions:

Matter to be dealt with	Full Committee	Sub-Committee	Officers
Consideration of reports to the committee	Six monthly		
Approval of new / updated Local Licensing Guidance	Six monthly		
Application for personal licence		If representation is made	If no representation made
Application for Personal Licence with unspent convictions		All cases	
Application for Premises Licence / Club Premises Certificate		If a relevant representation made	If no relevant representation is made
Application for a Provisional		If a relevant representation made	If no relevant representation is

This page is intentionally left blank



Home Office

Revised Guidance issued under section 182 of the Licensing Act 2003

April 2017

1. Introduction

The Licensing Act 2003

1.1 The Licensing Act 2003 (referred to in this Guidance as the 2003 Act), its explanatory notes and any statutory instruments made under it may be viewed online at www.legislation.gov.uk. The statutory instruments include regulations setting out the content and format of application forms and notices. The Home Office has responsibility for the 2003 Act. However, the Department for Culture, Media and Sport (DCMS) is responsible for regulated entertainment, for which there is provision in Schedule 1 to the 2003 Act (see Chapter 16).

Licensing objectives and aims

1.2 The legislation provides a clear focus on the promotion of four statutory objectives which must be addressed when licensing functions are undertaken.

1.3 The licensing objectives are:

- The prevention of crime and disorder;
- Public safety;
- The prevention of public nuisance; and
- The protection of children from harm.

1.4 Each objective is of equal importance. There are no other statutory licensing objectives, so that the promotion of the four objectives is a paramount consideration at all times.

1.5 However, the legislation also supports a number of other key aims and purposes. These are vitally important and should be principal aims for everyone involved in licensing work.

They include:

- protecting the public and local residents from crime, anti-social behaviour and noise nuisance caused by irresponsible licensed premises;
- giving the police and licensing authorities the powers they need to effectively manage and police the night-time economy and take action against those premises that are causing problems;
- recognising the important role which pubs and other licensed premises play in our local communities by minimising the regulatory burden on business, encouraging innovation and supporting responsible premises;
- providing a regulatory framework for alcohol which reflects the needs of local communities and empowers local authorities to make and enforce decisions about the most appropriate licensing strategies for their local area; and
- encouraging greater community involvement in licensing decisions and giving local residents the opportunity to have their say regarding licensing decisions that may affect them.

The guidance

- 1.6 Section 182 of the 2003 Act provides that the Secretary of State must issue and, from time to time, may revise guidance to licensing authorities on the discharge of their functions under the 2003 Act. This revised guidance takes effect as soon as it is published. Where a licence application was made prior to the publication of the revised guidance, it should be processed in accordance with the guidance in effect at the time at which the application was made; the revised guidance does not apply retrospectively. However, all applications received by the licensing authority on or after the date the revised guidance was published should be processed in accordance with the revised guidance.

Purpose

- 1.7 This Guidance is provided to licensing authorities in relation to the carrying out of their functions under the 2003 Act. It also provides information to magistrates' courts hearing appeals against licensing decisions and has been made widely available for the benefit of those who run licensed premises, their legal advisers and the general public. It is a key medium for promoting best practice, ensuring consistent application of licensing powers across England and Wales and for promoting fairness, equal treatment and proportionality.
- 1.8 The police remain key enforcers of licensing law. This Guidance does not bind police officers who, within the parameters of their force orders and the law, remain operationally independent. However, this Guidance is provided to support and assist police officers in interpreting and implementing the 2003 Act in the promotion of the four licensing objectives.

Legal status

- 1.9 Section 4 of the 2003 Act provides that, in carrying out its functions, a licensing authority must 'have regard to' guidance issued by the Secretary of State under section 182. This Guidance is therefore binding on all licensing authorities to that extent. However, this Guidance cannot anticipate every possible scenario or set of circumstances that may arise and, as long as licensing authorities have properly understood this Guidance, they may depart from it if they have good reason to do so and can provide full reasons. Departure from this Guidance could give rise to an appeal or judicial review, and the reasons given will then be a key consideration for the courts when considering the lawfulness and merits of any decision taken.
- 1.10 Nothing in this Guidance should be taken as indicating that any requirement of licensing law or any other law may be overridden (including the obligations placed on any public authorities under human rights legislation). This Guidance does not in any way replace the statutory provisions of the 2003 Act or add to its scope and licensing authorities should note that interpretation of the 2003 Act is a matter for the courts. Licensing authorities and others using this Guidance must take their own professional and legal advice about its implementation.

Licensing policies

- 1.11 Section 5 of the 2003 Act requires a licensing authority to determine and publish a statement of its licensing policy at least once every five years. The policy must be published before it carries out any licensing functions under the 2003 Act.
- 1.12 However, determining and publishing a statement of its policy is a licensing function and as such the authority must have regard to this Guidance when taking this step. A licensing authority may depart from its own policy if the individual circumstances of any case merit such a decision in the interests of the promotion of the licensing objectives. But once again, it is important that it should be able to give full reasons for departing from its published statement of licensing policy. Where revisions to this Guidance are issued by the Secretary of State, there may be a period of time when the licensing policy statement is inconsistent with the Guidance (for example, during any consultation by the licensing authority). In these circumstances, the licensing authority should have regard, and give appropriate weight, to this Guidance and its own existing licensing policy statement.

Licensable activities

- 1.13 For the purposes of the 2003 Act, the following are licensable activities:
- The sale by retail of alcohol;
 - The supply of alcohol by or on behalf of a club to, or to the order of, a member of the club;
 - The provision of regulated entertainment; and
 - The provision of late night refreshment.

Further explanation of these terms is provided in Chapter 3.

Authorisations or permissions

- 1.14 The 2003 Act provides for four different types of authorisation or permission, as follows:
- Premises licence – to use premises for licensable activities.
 - Club premises certificate – to allow a qualifying club to engage in qualifying club activities as set out in Section 1 of the Act.
 - Temporary event notice – to carry out licensable activities at a temporary event.
 - Personal licence – to sell or authorise the sale of alcohol from premises in respect of which there is a premises licence.

General principles

- 1.15 If an application for a premises licence or club premises certificate has been made lawfully and there have been no representations from responsible authorities or other persons, the licensing authority must grant the application, subject only to conditions that are consistent with the operating schedule and relevant mandatory conditions. It is recommended that licence applicants contact responsible authorities when preparing their operating schedules.

Licence conditions – general principles

1.16 Conditions on a premises licence or club premises certificate are important in setting the parameters within which premises can lawfully operate. The use of wording such as “must”, “shall” and “will” is encouraged. Licence conditions:

- must be appropriate for the promotion of the licensing objectives;
- must be precise and enforceable;
- must be unambiguous and clear in what they intend to achieve;
- should not duplicate other statutory requirements or other duties or responsibilities placed on the employer by other legislation;
- must be tailored to the individual type, location and characteristics of the premises and events concerned;
- should not be standardised and may be unlawful when it cannot be demonstrated that they are appropriate for the promotion of the licensing objectives in an individual case;
- should not replicate offences set out in the 2003 Act or other legislation;
- should be proportionate, justifiable and be capable of being met;
- cannot seek to manage the behaviour of customers once they are beyond the direct management of the licence holder and their staff, but may impact on the behaviour of customers in the immediate vicinity of the premises or as they enter or leave; and
- should be written in a prescriptive format.

Each application on its own merits

1.17 Each application must be considered on its own merits and in accordance with the licensing authority’s statement of licensing policy; for example, if the application falls within the scope of a cumulative impact policy. Conditions attached to licences and certificates must be tailored to the individual type, location and characteristics of the premises and events concerned. This is essential to avoid the imposition of disproportionate and overly burdensome conditions on premises where there is no need for such conditions. Standardised conditions should be avoided and indeed may be unlawful where they cannot be shown to be appropriate for the promotion of the licensing objectives in an individual case.

Additional guidance

1.18 From time to time, the Home Office may issue additional supporting guidance to licensing authorities and other persons on the Gov.uk website. This supporting guidance is good practice guidance and should be viewed as indicative and subject to change. Such supporting guidance will broadly reflect but will not be part of the statutory guidance issued by the Secretary of State under section 182 of the 2003 Act. Licensing authorities may wish to refer to, but are under no statutory duty to have regard to such supporting guidance issued by the Home Office.

Other relevant legislation

1.19 While licence conditions should not duplicate other statutory provisions, licensing authorities and licensees should be mindful of requirements and responsibilities placed on them by other legislation. Legislation which may be relevant includes:

- The Gambling Act 2005
- The Environmental Protection Act 1990
- The Noise Act 1996
- The Clean Neighbourhoods and Environmental Act 2005
- The Regulatory Reform (Fire Safety) Order 2005
- The Health and Safety at Work etc. Act 1974
- The Equality Act 2010
- The Immigration Act 2016

2. The licensing objectives

Crime and disorder

- 2.1 Licensing authorities should look to the police as the main source of advice on crime and disorder. They should also seek to involve the local Community Safety Partnership (CSP).
- 2.2 In the exercise of their functions, licensing authorities should seek to co-operate with the Security Industry Authority ("SIA") as far as possible and consider adding relevant conditions to licences where appropriate. The SIA also plays an important role in preventing crime and disorder by ensuring that door supervisors are properly licensed and, in partnership with police and other agencies, that security companies are not being used as fronts for serious and organised criminal activity. This may include making specific enquiries or visiting premises through intelligence led operations in conjunction with the police, local authorities and other partner agencies. Similarly, the provision of requirements for door supervision may be appropriate to ensure that people who are drunk, drug dealers or people carrying firearms do not enter the premises and ensuring that the police are kept informed.
- 2.3 Conditions should be targeted on deterrence and preventing crime and disorder including the prevention of illegal working in licensed premises (see paragraph 10.10). For example, where there is good reason to suppose that disorder may take place, the presence of closed-circuit television (CCTV) cameras both inside and immediately outside the premises can actively deter disorder, nuisance, anti-social behaviour and crime generally. Some licence holders may wish to have cameras on their premises for the prevention of crime directed against the business itself, its staff, or its customers. But any condition may require a broader approach, and it may be appropriate to ensure that the precise location of cameras is set out on plans to ensure that certain areas are properly covered and there is no subsequent dispute over the terms of the condition.
- 2.4 The inclusion of radio links and ring-round phone systems should be considered an appropriate condition for public houses, bars and nightclubs operating in city and town centre leisure areas with a high density of licensed premises. These systems allow managers of licensed premises to communicate instantly with the police and facilitate a rapid response to any disorder which may be endangering the customers and staff on the premises.
- 2.5 Conditions relating to the management competency of designated premises supervisors should not normally be attached to premises licences. It will normally be the responsibility of the premises licence holder as an employer, and not the licensing authority, to ensure that the managers appointed at the premises are competent and appropriately trained. The designated premises supervisor is the key person who will usually be responsible for the day to day management of the premises by the premises licence holder, including the prevention of disorder. A condition of this kind may only be justified as appropriate in rare circumstances where it can be demonstrated that, in the circumstances associated with particular premises, poor management competency could give rise to issues of crime and disorder and public safety.

- 2.6 The prevention of crime includes the prevention of immigration crime including the prevention of illegal working in licensed premises. Licensing authorities should work with Home Office Immigration Enforcement, as well as the police, in respect of these matters. Licence conditions that are considered appropriate for the prevention of illegal working in licensed premises might include requiring a premises licence holder to undertake right to work checks on all staff employed at the licensed premises or requiring that a copy of any document checked as part of a right to work check are retained at the licensed premises.

Public safety

- 2.7 Licence holders have a responsibility to ensure the safety of those using their premises, as a part of their duties under the 2003 Act. This concerns the safety of people using the relevant premises rather than public health which is addressed in other legislation. Physical safety includes the prevention of accidents and injuries and other immediate harms that can result from alcohol consumption such as unconsciousness or alcohol poisoning. Conditions relating to public safety may also promote the crime and disorder objective as noted above. There will of course be occasions when a public safety condition could incidentally benefit a person's health more generally, but it should not be the purpose of the condition as this would be outside the licensing authority's powers (be ultra vires) under the 2003 Act. Conditions should not be imposed on a premises licence or club premises certificate which relate to cleanliness or hygiene.
- 2.8 A number of matters should be considered in relation to public safety. These may include:
- Fire safety;
 - Ensuring appropriate access for emergency services such as ambulances;
 - Good communication with local authorities and emergency services, for example communications networks with the police and signing up for local incident alerts (see paragraph 2.4 above);
 - Ensuring the presence of trained first aiders on the premises and appropriate first aid kits;
 - Ensuring the safety of people when leaving the premises (for example, through the provision of information on late-night transportation);
 - Ensuring appropriate and frequent waste disposal, particularly of glass bottles;
 - Ensuring appropriate limits on the maximum capacity of the premises (see paragraphs 2.12-2.13, and Chapter 10; and
 - Considering the use of CCTV in and around the premises (as noted in paragraph 2.3 above, this may also assist with promoting the crime and disorder objective).
- 2.9 The measures that are appropriate to promote public safety will vary between premises and the matters listed above may not apply in all cases. As set out in Chapter 8 (8.38-8.46), applicants should consider when making their application which steps it is appropriate to take to promote the public safety objective and demonstrate how they achieve that.

Ensuring safe departure of those using the premises

- 2.10 Licence holders should make provision to ensure that premises users safely leave their premises. Measures that may assist include:
- Providing information on the premises of local taxi companies who can provide safe transportation home; and
 - Ensuring adequate lighting outside the premises, particularly on paths leading to and from the premises and in car parks.

Maintenance and repair

- 2.11 Where there is a requirement in other legislation for premises open to the public or for employers to possess certificates attesting to the safety or satisfactory nature of certain equipment or fixtures on the premises, it would be inappropriate for a licensing condition to require possession of such a certificate. However, it would be permissible to require as a condition of a licence or certificate, if appropriate, checks on this equipment to be conducted at specified intervals and for evidence of these checks to be retained by the premises licence holder or club provided this does not duplicate or gold-plate a requirement in other legislation. Similarly, it would be permissible for licensing authorities, if they receive relevant representations from responsible authorities or any other persons, to attach conditions which require equipment of particular standards to be maintained on the premises. Responsible authorities – such as health and safety authorities – should therefore make their expectations clear in this respect to enable prospective licence holders or clubs to prepare effective operating schedules and club operating schedules.

Safe capacities

- 2.12 “Safe capacities” should only be imposed where appropriate for the promotion of public safety or the prevention of disorder on the relevant premises. For example, if a capacity has been imposed through other legislation, it would be inappropriate to reproduce it in a premises licence. Indeed, it would also be wrong to lay down conditions which conflict with other legal requirements. However, if no safe capacity has been imposed through other legislation, a responsible authority may consider it appropriate for a new capacity to be attached to the premises which would apply at any material time when the licensable activities are taking place and make representations to that effect. For example, in certain circumstances, capacity limits may be appropriate in preventing disorder, as overcrowded venues can increase the risks of crowds becoming frustrated and hostile.
- 2.13 The permitted capacity is a limit on the number of persons who may be on the premises at any time, following a recommendation by the relevant fire and rescue authority under the Regulatory Reform (Fire Safety) Order 2005. For any application for a premises licence or club premises certificate for premises without an existing permitted capacity where the applicant wishes to take advantage of the special provisions set out in section 177 of the 2003 Act¹, the applicant should conduct their own risk assessment as to the appropriate capacity of the premises. They should send their recommendation to the fire and rescue authority which will consider it and decide what the “permitted capacity” of

¹ S 177 of the 2003 Act now only applies to performances of dance.

those premises should be.

- 2.14 Public safety may include the safety of performers appearing at any premises, but does not extend to the prevention of injury from participation in a boxing or wrestling entertainment.

Public nuisance

- 2.15 The 2003 Act enables licensing authorities and responsible authorities, through representations, to consider what constitutes public nuisance and what is appropriate to prevent it in terms of conditions attached to specific premises licences and club premises certificates. It is therefore important that in considering the promotion of this licensing objective, licensing authorities and responsible authorities focus on the effect of the licensable activities at the specific premises on persons living and working (including those carrying on business) in the area around the premises which may be disproportionate and unreasonable. The issues will mainly concern noise nuisance, light pollution, noxious smells and litter.
- 2.16 Public nuisance is given a statutory meaning in many pieces of legislation. It is however not narrowly defined in the 2003 Act and retains its broad common law meaning. It may include in appropriate circumstances the reduction of the living and working amenity and environment of other persons living and working in the area of the licensed premises. Public nuisance may also arise as a result of the adverse effects of artificial light, dust, odour and insects or where its effect is prejudicial to health.
- 2.17 Conditions relating to noise nuisance will usually concern steps appropriate to control the levels of noise emanating from premises. This might be achieved by a simple measure such as ensuring that doors and windows are kept closed after a particular time, or persons are not permitted in garden areas of the premises after a certain time. More sophisticated measures like the installation of acoustic curtains or rubber speaker mounts to mitigate sound escape from the premises may be appropriate. However, conditions in relation to live or recorded music may not be enforceable in circumstances where the entertainment activity itself is not licensable (see chapter 16). Any conditions appropriate to promote the prevention of public nuisance should be tailored to the type, nature and characteristics of the specific premises and its licensable activities. Licensing authorities should avoid inappropriate or disproportionate measures that could deter events that are valuable to the community, such as live music. Noise limiters, for example, are expensive to purchase and install and are likely to be a considerable burden for smaller venues.
- 2.18 As with all conditions, those relating to noise nuisance may not be appropriate in certain circumstances where provisions in other legislation adequately protect those living in the area of the premises. But as stated earlier in this Guidance, the approach of licensing authorities and responsible authorities should be one of prevention and when their powers are engaged, licensing authorities should be aware of the fact that other legislation may not adequately cover concerns raised in relevant representations and additional conditions may be appropriate.
- 2.19 Where applications have given rise to representations, any appropriate conditions should normally focus on the most sensitive periods. For example, the most sensitive period for people being disturbed by unreasonably loud music is at night and into the

early morning when residents in adjacent properties may be attempting to go to sleep or are sleeping. This is why there is still a need for a licence for performances of live music between 11 pm and 8 am. In certain circumstances, conditions relating to noise emanating from the premises may also be appropriate to address any disturbance anticipated as customers enter and leave.

- 2.20 Measures to control light pollution will also require careful thought. Bright lighting outside premises which is considered appropriate to prevent crime and disorder may itself give rise to light pollution for some neighbours. Applicants, licensing authorities and responsible authorities will need to balance these issues.
- 2.21 Beyond the immediate area surrounding the premises, these are matters for the personal responsibility of individuals under the law. An individual who engages in anti-social behaviour is accountable in their own right. However, it would be perfectly reasonable for a licensing authority to impose a condition, following relevant representations, that requires the licence holder or club to place signs at the exits from the building encouraging patrons to be quiet until they leave the area, or that, if they wish to smoke, to do so at designated places on the premises instead of outside, and to respect the rights of people living nearby to a peaceful night.

Protection of children from harm

- 2.22 The protection of children from harm includes the protection of children from moral, psychological and physical harm. This includes not only protecting children from the harms associated directly with alcohol consumption but also wider harms such as exposure to strong language and sexual expletives (for example, in the context of exposure to certain films or adult entertainment). Licensing authorities must also consider the need to protect children from sexual exploitation when undertaking licensing functions.
- 2.23 The Government believes that it is completely unacceptable to sell alcohol to children. Conditions relating to the access of children where alcohol is sold and which are appropriate to protect them from harm should be carefully considered. Moreover, conditions restricting the access of children to premises should be strongly considered in circumstances where:
- adult entertainment is provided;
 - a member or members of the current management have been convicted for serving alcohol to minors or with a reputation for allowing underage drinking (other than in the context of the exemption in the 2003 Act relating to 16 and 17 year olds consuming beer, wine and cider when accompanied by an adult during a table meal);
 - it is known that unaccompanied children have been allowed access;
 - there is a known association with drug taking or dealing; or
 - in some cases, the premises are used exclusively or primarily for the sale of alcohol for consumption on the premises.
- 2.24 It is also possible that activities, such as adult entertainment, may take place at certain times on premises but not at other times. For example, premises may operate as a café bar during the day providing meals for families but also provide entertainment with a sexual content after 8.00pm. It is not possible to give an exhaustive list of what amounts to entertainment or services of an adult or sexual nature. Applicants, responsible

authorities and licensing authorities will need to consider this point carefully. This would broadly include topless bar staff, striptease, lap-, table- or pole-dancing, performances involving feigned violence or horrific incidents, feigned or actual sexual acts or fetishism, or entertainment involving strong and offensive language.

- 2.25 Applicants must be clear in their operating schedules about the activities and times at which the events would take place to help determine when it is not appropriate for children to enter the premises. Consideration should also be given to the proximity of premises to schools and youth clubs so that applicants take appropriate steps to ensure that advertising relating to their premises, or relating to events at their premises, is not displayed at a time when children are likely to be near the premises.
- 2.26 Licensing authorities and responsible authorities should expect applicants, when preparing an operating schedule or club operating schedule, to set out the steps to be taken to protect children from harm when on the premises.
- 2.27 Conditions, where they are appropriate, should reflect the licensable activities taking place on the premises. In addition to the mandatory condition regarding age verification, other conditions relating to the protection of children from harm can include:
- restrictions on the hours when children may be present;
 - restrictions or exclusions on the presence of children under certain ages when particular specified activities are taking place;
 - restrictions on the parts of the premises to which children may have access;
 - age restrictions (below 18);
 - restrictions or exclusions when certain activities are taking place;
 - requirements for an accompanying adult (including for example, a combination of requirements which provide that children under a particular age must be accompanied by an adult); and
 - full exclusion of people under 18 from the premises when any licensable activities are taking place.
- 2.28 Please see also Chapter 10 for details about the Licensing Act 2003 (Mandatory Licensing Conditions) Order 2010.
- 2.29 Licensing authorities should give considerable weight to representations about child protection matters. In addition to the responsible authority whose functions relate directly to child protection, the Director of Public Health may also have access to relevant evidence to inform such representations. These representations may include, amongst other things, the use of health data about the harms that alcohol can cause to underage drinkers. Where a responsible authority, or other person, presents evidence to the licensing authority linking specific premises with harms to children (such as ambulance data or emergency department attendances by persons under 18 years old with alcohol-related illnesses or injuries) this evidence should be considered, and the licensing authority should also consider what action is appropriate to ensure this licensing objective is effectively enforced. In relation to applications for the grant of a licence in areas where evidence is presented on high levels of alcohol-related harms in persons aged under 18, it is recommended that the licensing authority considers what conditions may be appropriate to ensure that this objective is promoted effectively.

- 2.30 The 2003 Act provides that, where a premises licence or club premises certificate authorises the exhibition of a film, it must include a condition requiring the admission of children to films to be restricted in accordance with recommendations given either by a body designated under section 4 of the Video Recordings Act 1984 specified in the licence (the British Board of Film Classification is currently the only body which has been so designated) or by the licensing authority itself. Further details are given in Chapter 10.
- 2.31 Theatres may present a range of diverse activities and entertainment including, for example, variety shows incorporating adult entertainment. It is appropriate in these cases for a licensing authority to consider restricting the admission of children in such circumstances. Entertainments may also be presented at theatres specifically for children. It will be appropriate to consider whether a condition should be attached to a premises licence or club premises certificate which requires the presence of a sufficient number of adult staff on the premises to ensure the wellbeing of the children during any emergency.

Offences relating to the sale and supply of alcohol to children

- 2.32 Licensing authorities are expected to maintain close contact with the police, young offenders' teams and trading standards officers (who can carry out test purchases under section 154 of the 2003 Act) about the extent of unlawful sales and consumption of alcohol by minors and to be involved in the development of any strategies to control or prevent these unlawful activities and to pursue prosecutions. Licensing authorities, alongside the police, are prosecuting authorities for the purposes of these offences, except for the offences under section 147A (persistently selling alcohol to children). Where, as a matter of policy, warnings are given to retailers prior to any decision to prosecute in respect of an offence, it is important that each of the enforcement arms should be aware of the warnings each of them has given.

Table of relevant offences under the 2003 Act

Section	Offence	Prosecuting Authority
Section 145	Unaccompanied children prohibited from certain premises	Police and/or Licensing Authority
Section 146	Sale of alcohol to children	Police, Licensing Authority and/or Local Weights and Measures Authority
Section 147	Allowing the sale of alcohol to children	Police, Licensing Authority and/or Local Weights and Measures Authority
Section 147A	Persistently selling alcohol to children	Police and/or Local Weights and Measures Authority
Section 149	Purchase of alcohol by or on behalf of children	Police and/or Licensing Authority
Section 150	Consumption of alcohol by children	Police and/or Licensing Authority
Section 151	Delivering alcohol to children	Police and/or Licensing Authority
Section 152	Sending a child to obtain alcohol	Police and/or Licensing Authority
Section 153	Prohibition of unsupervised sales by children	Police and/or Licensing Authority

8. Applications for premises licences

Relevant licensing authority

- 8.1 Premises licences are issued by the licensing authority in which the premises are situated or, in the case of premises straddling an area boundary, the licensing authority where the greater part of the premises is situated. Where the premises is located equally in two or more areas, the applicant may choose but, in these rare cases, it is important that each of the licensing authorities involved maintain close contact.
- 8.2 Section 13 of the 2003 Act defines the parties holding important roles in the context of applications, inspection, monitoring and reviews of premises licences.

Authorised persons

- 8.3 The first group –“authorised persons”– are bodies empowered by the 2003 Act to carry out inspection and enforcement roles. The police and immigration officers are not included because they are separately empowered by the 2003 Act to carry out their duties.
- 8.4 For all premises, the authorised persons include:
- officers of the licensing authority;
 - fire inspectors;
 - inspectors with responsibility in the licensing authority’s area for the enforcement of the Health and Safety at Work etc Act 1974;
 - officers of the local authority exercising environmental health functions
- 8.5 Local authority officers will most commonly have responsibility for the enforcement of health and safety legislation, but the Health and Safety Executive is responsible for certain premises. In relation to vessels, authorised persons also include an inspector or a surveyor of ships appointed under section 256 of the Merchant Shipping Act 1995. These would normally be officers acting on behalf of the Maritime and Coastguard Agency. The Secretary of State may prescribe other authorised persons by means of regulations, but has not currently prescribed any additional bodies. If any are prescribed, details will be made available on the GOV.UK website.
- 8.6 Where an immigration officer has reason to believe that any premises are being used for a licensable activity, the officer may enter the premises with a view to seeing whether an offence under any of the Immigration Acts is being committed in connection with the licensable activity.

Responsible authorities

- 8.7 The second group –“responsible authorities”– are public bodies that must be fully notified of applications and that are entitled to make representations to the licensing authority in relation to the application for the grant, variation or review of a premises licence. These representations must still be considered ‘relevant’ by the licensing authority and relate to one or more of the licensing objectives. For all premises, responsible authorities include:
- the relevant licensing authority and any other licensing authority in whose area part of

- the premises is situated;
 - the chief officer of police;
 - the local fire and rescue authority;
 - the relevant enforcing authority under the Health and Safety at Work etc Act 1974;
 - the local authority with responsibility for environmental health;
 - the local planning authority;
 - a body that represents those who are responsible for, or interested in, matters relating to the protection of children from harm;
 - each local authority's Director of Public Health (DPH) in England⁴ and Local Health Boards (in Wales);
 - the local weights and measures authority (trading standards); and
 - Home Office Immigration Enforcement (on behalf of the Secretary of State).
- 8.8 The licensing authority should indicate in its statement of licensing policy which body it recognises to be competent to advise it on the protection of children from harm. This may be the local authority social services department, the Local Safeguarding Children Board or another competent body. This is important as applications for premises licences have to be copied to the responsible authorities in order for them to make any representations they think are relevant.
- 8.9 In relation to a vessel, responsible authorities also include navigation authorities within the meaning of section 221(1) of the Water Resources Act 1991 that have statutory functions in relation to the waters where the vessel is usually moored or berthed, or any waters where it is proposed to be navigated when being used for licensable activities; the Environment Agency; the Canal and River Trust; and the Secretary of State (who in practice acts through the Maritime and Coastguard Agency (MCA)). In practice, the Environment Agency and the Canal and River Trust only have responsibility in relation to vessels on waters for which they are the navigation statutory authority.
- 8.10 The MCA is the lead responsible authority for public safety, including fire safety, affecting passenger ships (those carrying more than 12 passengers) wherever they operate and small commercial vessels (carrying no more than 12 passengers) which go to sea. The safety regime for passenger ships is enforced under the Merchant Shipping Acts by the MCA which operates certification schemes for these vessels. Fire and rescue authorities, the Health and Safety Executive and local authority health and safety inspectors should normally be able to make "nil" returns in relation to such vessels and rely on the MCA to make any appropriate representations in respect of this licensing objective.
- 8.11 Merchant Shipping legislation does not, however, apply to permanently moored vessels. So, for example, restaurant ships moored on the Thames Embankment, with permanent shore connections should be considered by the other responsible authorities concerned with public safety, including fire safety. Vessels carrying no more than 12 passengers which do not go to sea are not subject to MCA survey and certification, but may be licensed by the local port or navigation authority.

⁴ This change was made as a result of the commencement of measures in the Health and Social Care Act 2012 which amended the 2003 Act and further provision in the NHS Bodies and Local Authorities (Partnership Arrangements, Care Trusts, Public Health and Local Healthwatch) Regulations 2012.

- 8.12 The Secretary of State may prescribe other responsible authorities by means of regulations. Any such regulations are published on the Government's legislation website: www.legislation.gov.uk.

Other persons

- 8.13 As well as responsible authorities, any other person can play a role in a number of licensing processes under the 2003 Act. This includes any individual, body or business entitled to make representations to licensing authorities in relation to applications for the grant, variation, minor variation or review of premises licences and club premises certificates, regardless of their geographic proximity to the premises. In addition, these persons may themselves seek a review of a premises licence. Any representations made by these persons must be 'relevant', in that the representation relates to one or more of the licensing objectives. It must also not be considered by the licensing authority to be frivolous or vexatious. In the case of applications for reviews, there is an additional requirement that the grounds for the review should not be considered by the licensing authority to be repetitious. Chapter 9 of this guidance (paragraphs 9.4 to 9.10) provides more detail on the definition of relevant, frivolous and vexatious representations.
- 8.14 While any of these persons may act in their own right, they may also request that a representative makes the representation to the licensing authority on their behalf. A representative may include a legal representative, a friend, a Member of Parliament, a Member of the Welsh Government, or a local ward or parish councillor who can all act in such a capacity.

Who can apply for a premises licence?

- 8.15 Any person (if an individual aged 18 or over) who is carrying on or who proposes to carry on a business which involves the use of premises (any place including one in the open air) for licensable activities may apply for a premises licence either on a permanent basis or for a time-limited period.
- 8.16 "A person" in this context includes, for example, a business or a partnership. Licensing authorities should not require the nomination of an individual to hold the licence or determine the identity of the most appropriate person to hold the licence.
- 8.17 In considering joint applications (which is likely to be a rare occurrence), it must be stressed that under section 16(1)(a) of the 2003 Act each applicant must be carrying on a business which involves the use of the premises for licensable activities. In the case of public houses, this would be easier for a tenant to demonstrate than for a pub owning company that is not itself carrying on licensable activities. Where licences are to be held by businesses, it is desirable that this should be a single business to avoid any lack of clarity in accountability.
- 8.18 A public house may be owned, or a tenancy held, jointly by a husband and wife, civil partners or other partnerships of a similar nature, and both may be actively involved in carrying on the licensable activities. In these cases, it is entirely possible for the husband and wife or the partners to apply jointly as applicant for the premises licence, even if they are not formally partners in business terms. This is unlikely to lead to the same issues of clouded accountability that could arise where two separate businesses

apply jointly for the licence. If the application is granted, the premises licence would identify the holder as comprising both names and any subsequent applications, for example for a variation of the licence, would need to be made jointly.

- 8.19 A wide range of other individuals and bodies set out in section 16 of the 2003 Act may apply for premises licences. They include, for example, Government Departments, local authorities, hospitals, schools, charities or police forces. In addition to the bodies listed in section 16, the Secretary of State may prescribe by regulations other bodies that may apply and any such regulations are published on the Government's legislation website. There is nothing in the 2003 Act which prevents an application being made for a premises licence at premises where a premises licence is already held.

Application forms

- 8.20 The Provision of Services Regulations 2009 require local authorities to ensure that all procedures relating to access to, or the exercise of, a service activity may be easily completed, at a distance and by electronic means. Electronic application facilities for premises licences may be found either on GOV.UK or the licensing authority's own website. It remains acceptable to make an application in writing.

Electronic applications

- 8.21 Applicants may apply using the licence application forms available on GOV.UK, or will be re-directed from GOV.UK to the licensing authority's own electronic facility if one is available. Applicants may also apply directly to the licensing authority's facility without going through GOV.UK.

Electronic applications using forms on gov.uk

- 8.22 GOV.UK will send a notification to the licensing authority when a completed application form is available for it to download from GOV.UK. This is the day that the application is taken to be 'given' to the licensing authority, even if it is downloaded at a later stage, and the application must be advertised from the day after that day (as for a written application). The licensing authority must acknowledge the application as quickly as possible, specifying the statutory time period and giving details of the appeal procedure.
- 8.23 The period of 28 consecutive days during which the application must be advertised on a notice outside the premises is, effectively, the statutory timescale by which the application must be determined (unless representations are made). This will be published on GOV.UK and must also be published on the licensing authority's own electronic facility if one exists. If no representations are made during this period, the licensing authority must notify the applicant as quickly as possible that the licence has been granted. The licensing authority must send the licence to the applicant as soon as possible after this, but the applicant may start the licensed activity as soon as they have been notified that the application is granted (subject to compliance with the conditions of the licence). The licence may be supplied in electronic or written format as long as the applicant is aware which document constitutes 'the licence'. If representations are made, the guidance in Chapter 9 applies.

Requirement to copy application to responsible authorities

- 8.24 The licensing authority must copy electronic applications, made via GOV.UK or its own facility, to responsible authorities no later than the first working day after the application

is given. However, if an applicant submits any part of their application in writing, the applicant will remain responsible for copying it to responsible authorities.

Applications via the local authority electronic application facility

8.25 Where applications are made on the licensing authority's own electronic facility, the application will be taken to be 'given' when the applicant has submitted a complete application form and paid the fee. The application is given at the point at which it becomes accessible to the authority by means of the facility. The licensing authority must acknowledge the application as quickly as possible, specifying the statutory time period and giving details of the appeal procedure.

'Holding' and 'deferring' electronic applications

8.26 The Government recommends (as for written applications) that electronic applications should not be returned if they contain obvious and minor errors such as typing mistakes, or small errors that can be rectified with information already in the authority's possession. However, if this is not the case and required information is missing or incorrect, the licensing authority may 'hold' the application until the applicant has supplied all the required information. This effectively resets the 28 day period for determining an application and may be done any number of times until the application form is complete. Licensing authorities must ensure that they notify the applicant as quickly as possible of any missing (or incorrect) information, and explain how this will affect the statutory timescale and advertising requirements.

8.27 If an application has been given at the weekend, the notice advertising the application (where applicable) may already be displayed outside the premises by the time that the licensing authority downloads the application. It is therefore recommended that, if a licensing authority holds an application, it should inform the applicant that the original (or if necessary, amended) notice must be displayed until the end of the revised period. The licensing authority should also advise the applicant that they should not advertise the application in a local newspaper until they have received confirmation from the licensing authority that the application includes all the required information. To ensure clarity for applicants, the Government recommends that licensing authorities include similar advice on their electronic application facilities (where these exist) to ensure that applicants do not incur any unnecessary costs.

8.28 If an applicant persistently fails to supply the required information, the licensing authority may refuse the application and the applicant must submit a new application.

8.29 Licensing authorities may also 'defer' electronic applications once if the application is particularly complicated, for example if representations are received and a hearing is required. This allows the licensing authority to extend the statutory time period for the determination of the application by such time as is necessary, including, if required, arranging and holding a hearing. Licensing authorities must ensure that applicants are informed as quickly as possible of a decision to defer, and the reasons for the deferral, before the original 28 days has expired.

Written applications

8.30 A written application for a premises licence must be made in the prescribed form to the relevant licensing authority and be copied to each of the appropriate responsible authorities. For example, it would not be appropriate to send an application for premises

which was not a vessel to the Maritime and Coastguard Agency. The application must be accompanied by:

- the required fee (details of fees may be viewed on the GOV.UK website);
- an operating schedule (see below);
- a plan of the premises in a prescribed form; and
- if the application involves the supply of alcohol, a form of consent from the individual who is to be specified in the licence as the designated premises supervisor (DPS).

- 8.31 If the application is being made by an individual the application should be accompanied by acceptable evidence of entitlement to work in the UK, as set out in the application form (see paragraph 4.8).
- 8.32 If the application is being made in respect of a community premises, it may be accompanied by the form of application to apply the alternative licence condition.
- 8.33 Guidance on completing premises licence, club premises certificate and minor variation forms can be found on the GOV.UK website. The Licensing Act 2003 (Premises licences and club premises certificates) Regulations 2005 contain provision about the prescribed form of applications, operating schedules and plans and are published on the legislation.gov.uk website.

Plans

- 8.34 Plans, for written and electronic applications, will not be required to be submitted in any particular scale, but they must be in a format which is “clear and legible in all material respects”, i.e. they must be accessible and provides sufficient detail for the licensing authority to be able to determine the application, including the relative size of any features relevant to the application. There is no requirement for plans to be professionally drawn as long as they clearly show all the prescribed information.

Entitlement to work in the UK

- 8.35 Individuals applying for a premises licence for the sale of alcohol or late night refreshment must be entitled to work in the UK. From 6 April 2017 licensing authorities must be satisfied that an individual who applies for a premises licence is entitled to work in the UK. This includes applications made by more than one individual applicant. An application made by an individual without the entitlement to work in the UK must be rejected. This applies to applications which include the sale of alcohol and the provisions of late night refreshment, but does not include applications which apply to regulated entertainment only. For example, a person applying for a licence for a music venue who does not intend to sell alcohol or late night refreshment is not prohibited from applying for a licence on grounds of immigration status. However, they will commit a criminal offence if they work illegally.
- 8.36 The documents which may be relied on in support of an application demonstrating an entitlement to work in the UK are the same as for personal licence applicants see paragraph 4.8. Where there is sufficient evidence that the applicant is not resident in the UK there is no requirement that the applicant have an entitlement to work in the UK.
- 8.37 Where an applicant’s permission to work in the UK is time-limited the licensing authority may issue a premises licence for an indefinite period, but the licence will become invalid

when the immigration permission expires. The individual's entitlement to work in the UK may be extended or made permanent by the Home Office, and granting the licence for an indefinite period prevents the licensee from having to re-apply for a new licence. In the event that the Home Office cuts short or ends a person's immigration permission (referred to as a curtailment or revocation), any licence issued on or after 6 April 2017 which authorises the sale of alcohol or provision of late night refreshment will automatically lapse. As with personal licences, the licensing authority is under no duty to carry out on going immigration checks to see whether a licence holder's permission to be in the UK has been brought to an end. For further details on entitlement to work see paragraphs 4.8 to 4.18.

Steps to promote the licensing objectives

- 8.38 In completing an operating schedule, applicants are expected to have regard to the statement of licensing policy for their area. They must also be aware of the expectations of the licensing authority and the responsible authorities as to the steps that are appropriate for the promotion of the licensing objectives, and to demonstrate knowledge of their local area when describing the steps they propose to take to promote the licensing objectives. Licensing authorities and responsible authorities are expected to publish information about what is meant by the promotion of the licensing objectives and to ensure that applicants can readily access advice about these matters. However, applicants are also expected to undertake their own enquiries about the area in which the premises are situated to inform the content of the application.
- 8.39 Applicants are, in particular, expected to obtain sufficient information to enable them to demonstrate, when setting out the steps they propose to take to promote the licensing objectives, that they understand:
- the layout of the local area and physical environment including crime and disorder hotspots, proximity to residential premises and proximity to areas where children may congregate;
 - any risk posed to the local area by the applicants' proposed licensable activities; and
 - any local initiatives (for example, local crime reduction initiatives or voluntary schemes including local taxi-marshalling schemes, street pastors and other schemes) which may help to mitigate potential risks.
- 8.40 Applicants are expected to include positive proposals in their application on how they will manage any potential risks. Where specific policies apply in the area (for example, a cumulative impact policy), applicants are also expected to demonstrate an understanding of how the policy impacts on their application; any measures they will take to mitigate the impact; and why they consider the application should be an exception to the policy.
- 8.41 It is expected that enquiries about the locality will assist applicants when determining the steps that are appropriate for the promotion of the licensing objectives. For example, premises with close proximity to residential premises should consider what effect this will have on their smoking, noise management and dispersal policies to ensure the promotion of the public nuisance objective. Applicants must consider all factors which may be relevant to the promotion of the licensing objectives, and where there are no known concerns, acknowledge this in their application.

- 8.42 The majority of information which applicants will require should be available in the licensing policy statement in the area. Other publicly available sources which may be of use to applicants include:
- the Crime Mapping website;
 - Neighbourhood Statistics websites;
 - websites or publications by local responsible authorities;
 - websites or publications by local voluntary schemes and initiatives; and
 - on-line mapping tools.
- 8.43 While applicants are not required to seek the views of responsible authorities before formally submitting their application, they may find them to be a useful source of expert advice on local issues that should be taken into consideration when making an application. Licensing authorities may wish to encourage co-operation between applicants, responsible authorities and, where relevant, local residents and businesses before applications are submitted in order to minimise the scope for disputes to arise.
- 8.44 Applicants are expected to provide licensing authorities with sufficient information in this section to determine the extent to which their proposed steps are appropriate to promote the licensing objectives in the local area. Applications must not be based on providing a set of standard conditions to promote the licensing objectives and applicants are expected to make it clear why the steps they are proposing are appropriate for the premises.
- 8.45 All parties are expected to work together in partnership to ensure that the licensing objectives are promoted collectively. Where there are no disputes, the steps that applicants propose to take to promote the licensing objectives, as set out in the operating schedule, will very often translate directly into conditions that will be attached to premises licences with the minimum of fuss.
- 8.46 For some premises, it is possible that no measures will be appropriate to promote one or more of the licensing objectives, for example, because they are adequately covered by other existing legislation. It is however important that all operating schedules should be precise and clear about the measures that are proposed to promote each of the licensing objectives.

Variations

Introduction

- 8.47 Where a premises licence holder wishes to amend the licence, the 2003 Act in most cases permits an application to vary to be made rather than requiring an application for a new premises licence. The process to be followed will depend on the nature of the variation and its potential impact on the licensing objectives. Applications to vary can be made electronically via GOV.UK or by means of the licensing authority's own electronic facility following the procedures set out in Chapter 8 above.

Simplified processes

- 8.48 There are simplified processes for making applications, or notifying changes, in the following cases:
- a change of the name or address of someone named in the licence (section 33);

application on a case by case basis and in light of any licence conditions put forward by the applicant.

Licensing hours

- 8.63 Variations to the following are excluded from the minor variations process and must be treated as full variations in all cases:
- to extend licensing hours for the sale or supply of alcohol for consumption on or off the premises between the hours of 23.00 and 07.00; or
 - to increase the amount of time on any day during which alcohol may be sold or supplied for consumption on or off the premises.
- 8.64 Applications to reduce licensing hours for the sale or supply of alcohol or, in some cases, to move (without increasing) the licensed hours between 07.00 and 23.00 will normally be processed as minor variations.
- 8.65 Applications to vary the time during which other licensable activities take place should be considered on a case-by-case basis with reference to the likely impact on the licensing objectives.

Licensing conditions

a) Imposed conditions

- 8.66 Licensing authorities cannot impose their own conditions on the licence through the minor variations process. If the licensing officer considers that the proposed variation would impact adversely on the licensing objectives unless conditions are imposed, they should refuse it.

b) Volunteered conditions

- 8.67 Applicants may volunteer conditions as part of the minor variation process. These conditions may arise from their own risk assessment of the variation, or from informal discussions with responsible authorities or the licensing authority.
- 8.68 For instance, there may be circumstances when the licence holder and a responsible authority such as the police or environmental health authority, agree that a new condition should be added to the licence (for example, that a nightclub adds the provision of late night refreshment to its licence to ensure a longer period of dispersal). Such a change would not normally impact adversely on the licensing objectives and could be expected to promote them by preventing crime and disorder or public nuisance. In these circumstances, the minor variation process may provide a less costly and onerous means of amending the licence than a review, with no risk to the licensing objectives. However, this route should only be used where the agreed variations are minor and the licence holder and the responsible authority have come to a genuine agreement. The licensing authority should be alive to any attempts to pressure licence or certificate holders into agreeing to new conditions where there is no evidence of a problem at the premises and, if there is any doubt, should discuss this with the relevant parties.

c) Amending or removing existing conditions

- 8.69 However, there may be some circumstances when the minor variation process is appropriate. Premises may change over time and the circumstances that originally led to the condition being attached or volunteered may no longer apply. For example, there

9. Determining applications

General

- 9.1 When a licensing authority receives an application for a new premises licence or an application to vary an existing premises licence, it must determine whether the application has been made in accordance with section 17 of the 2003 Act, and in accordance with regulations made under sections 17(3) to (6), 34, 42, 54 and 55 of the 2003 Act. It must similarly determine applications for the grant of club premises certificates made in accordance with section 71 of the 2003 Act, and in accordance with regulations made under sections 71(4) to (7), 84, 91 and 92 of the 2003 Act. This means that the licensing authority must consider among other things whether the application has been properly advertised in accordance with those regulations.

Where no representations are made

- 9.2 A hearing is not required where an application has been properly made and no responsible authority or other person has made a relevant representation or where representations are made and subsequently withdrawn. In these cases, the licensing authority must grant the application in the terms sought, subject only to conditions which are consistent with the operating schedule and relevant mandatory conditions under the 2003 Act. This should be undertaken as a simple administrative process by the licensing authority's officials who should replicate the proposals contained in the operating schedule to promote the licensing objectives in the form of clear and enforceable licence conditions. Licensing authorities should not hold hearings for uncontested applications, for example in situations where representations have been made and conditions have subsequently been agreed.

Where representations are made

- 9.3 Where a representation concerning the licensing objectives is made by a responsible authority about a proposed operating schedule and it is relevant (see paragraphs 9.4 to 9.10 below), the licensing authority's discretion will be engaged. It will also be engaged if another person makes relevant representations to the licensing authority, which are also not frivolous or vexatious (see paragraphs 9.4 to 9.10 below). Relevant representations can be made in opposition to, or in support of, an application and can be made by any individual, body or business that has grounds to do so.

Relevant, vexatious and frivolous representations

- 9.4 A representation is "relevant" if it relates to the likely effect of the grant of the licence on the promotion of at least one of the licensing objectives. For example, a representation from a local businessperson about the commercial damage caused by competition from new licensed premises would not be relevant. On the other hand, a representation by a businessperson that nuisance caused by new premises would deter customers from entering the local area, and the steps proposed by the applicant to prevent that nuisance were inadequate, would be relevant. In other words, representations should relate to the impact of licensable activities carried on from premises on the objectives. For representations in relation to variations to be relevant, they should be confined to

Home Office Immigration Enforcement acting as a responsible authority

- 9.25 The Immigration Act 2016 made the Secretary of State a responsible authority in respect of premises licensed to sell alcohol or late night refreshment with effect from 6 April 2017. In effect this conveys the role of responsible authority to Home Office Immigration Enforcement who exercises the powers on the Secretary of State's behalf. When Immigration Enforcement exercises its powers as a responsible authority it will do so in respect of the prevention of crime and disorder licensing objective because it is concerned with the prevention of illegal working or immigration offences more broadly.

Disclosure of personal details of persons making representations

- 9.26 Where a notice of a hearing is given to an applicant, the licensing authority is required under the Licensing Act 2003 (Hearings) Regulations 2005 to provide the applicant with copies of the relevant representations that have been made.
- 9.27 In exceptional circumstances, persons making representations to the licensing authority may be reluctant to do so because of fears of intimidation or violence if their personal details, such as name and address, are divulged to the applicant.
- 9.28 Where licensing authorities consider that the person has a genuine and well-founded fear of intimidation and may be deterred from making a representation on this basis, they may wish to consider alternative approaches.
- 9.29 For instance, they could advise the persons to provide the relevant responsible authority with details of how they consider that the licensing objectives are being undermined so that the responsible authority can make representations if appropriate and justified.
- 9.30 The licensing authority may also decide to withhold some or all of the person's personal details from the applicant, giving only minimal details (such as street name or general location within a street). However, withholding such details should only be considered where the circumstances justify such action.

Hearings

- 9.31 Regulations governing hearings may be found on the www.legislation.gov.uk website. If the licensing authority decides that representations are relevant, it must hold a hearing to consider them. The need for a hearing can only be avoided with the agreement of the licensing authority, the applicant and all of the persons who made relevant representations. In cases where only 'positive' representations are received, without qualifications, the licensing authority should consider whether a hearing is required. To this end, it may wish to notify the persons who made representations and give them the opportunity to withdraw those representations. This would need to be done in sufficient time before the hearing to ensure that parties were not put to unnecessary inconvenience.
- 9.32 Responsible authorities should try to conclude any discussions with the applicant in good time before the hearing. If the application is amended at the last moment, the licensing committee should consider giving other persons time to address the revised application before the hearing commences.
- 9.33 Regulations made under the 2003 Act require that representations must be withdrawn

24 hours before the first day of any hearing. If they are withdrawn after this time, the hearing must proceed and the representations may be withdrawn orally at that hearing. However, where discussions between an applicant and those making representations are taking place and it is likely that all parties are on the point of reaching agreement, the licensing authority may wish to use the power given within the hearings regulations to extend time limits, if it considers this to be in the public interest.

- 9.34 Applicants should be encouraged to contact responsible authorities before formulating their applications so that the mediation process may begin before the statutory time limits come into effect after submission of an application. The hearing process must meet the requirements of regulations made under the 2003 Act. Where matters arise which are not covered by the regulations, licensing authorities may make arrangements as they see fit as long as they are lawful.
- 9.35 There is no requirement in the 2003 Act for responsible authorities that have made representations to attend, but it is generally good practice and assists committees in reaching more informed decisions. Where several responsible authorities within a local authority have made representations on an application, a single local authority officer may represent them at the hearing if the responsible authorities and the licensing authority agree. This local authority officer representing other responsible authorities may be a licensing officer, but only if this licensing officer is acting as a responsible authority on behalf of the licensing authority and has had no role in the licensing determination process. This is to ensure that the responsible authorities are represented by an independent officer separate from the licensing determination process.
- 9.36 As noted in paragraphs 9.13 to 9.19 above, where the licensing officer is acting as a responsible authority the relevant steps should be followed to ensure that this individual has no role in the decision making process regarding the licensing determination.
- 9.37 As a matter of practice, licensing authorities should seek to focus the hearing on the steps considered appropriate to promote the particular licensing objective or objectives that have given rise to the specific representation and avoid straying into undisputed areas. A responsible authority or other person may choose to rely on their written representation. They may not add further representations to those disclosed to the applicant prior to the hearing, but they may expand on their existing representation.
- 9.38 In determining the application with a view to promoting the licensing objectives in the overall interests of the local community, the licensing authority must give appropriate weight to:
- the steps that are appropriate to promote the licensing objectives;
 - the representations (including supporting information) presented by all the parties;
 - this Guidance;
 - its own statement of licensing policy.
- 9.39 The licensing authority should give its decision within five working days of the conclusion of the hearing (or immediately in certain specified cases) and provide reasons to support it. This will be important if there is an appeal by any of the parties. Notification of a decision must be accompanied by information on the right of the party to appeal. After considering all the relevant issues, the licensing authority may grant the application subject to such conditions that are consistent with the operating schedule.

Any conditions imposed must be appropriate for the promotion of the licensing objectives; there is no power for the licensing authority to attach a condition that is merely aspirational. For example, conditions may not be attached which relate solely to the health of customers rather than their direct physical safety. Any conditions added to the licence must be those imposed at the hearing or those agreed when a hearing has not been necessary.

- 9.40 Alternatively, the licensing authority may refuse the application on the grounds that this is appropriate for the promotion of the licensing objectives. It may also refuse to specify a designated premises supervisor and/or only allow certain requested licensable activities. In the interests of transparency, the licensing authority should publish hearings procedures in full on its website to ensure that those involved have the most current information.
- 9.41 In the context of variations or minor variations, which may involve structural alteration to or change of use of a building, the decision of the licensing authority will not exempt an applicant from the need to apply for building control approval, planning permission or both of these where appropriate.

Determining actions that are appropriate for the promotion of the licensing objectives

- 9.42 Licensing authorities are best placed to determine what actions are appropriate for the promotion of the licensing objectives in their areas. All licensing determinations should be considered on a case-by-case basis. They should take into account any representations or objections that have been received from responsible authorities or other persons, and representations made by the applicant or premises user as the case may be.
- 9.43 The authority's determination should be evidence-based, justified as being appropriate for the promotion of the licensing objectives and proportionate to what it is intended to achieve.
- 9.44 Determination of whether an action or step is appropriate for the promotion of the licensing objectives requires an assessment of what action or step would be suitable to achieve that end. While this does not therefore require a licensing authority to decide that no lesser step will achieve the aim, the authority should aim to consider the potential burden that the condition would impose on the premises licence holder (such as the financial burden due to restrictions on licensable activities) as well as the potential benefit in terms of the promotion of the licensing objectives. However, it is imperative that the authority ensures that the factors which form the basis of its determination are limited to consideration of the promotion of the objectives and nothing outside those parameters. As with the consideration of licence variations, the licensing authority should consider wider issues such as other conditions already in place to mitigate potential negative impact on the promotion of the licensing objectives and the track record of the business. Further advice on determining what is appropriate when imposing conditions on a licence or certificate is provided in Chapter 10. The licensing authority is expected to come to its determination based on an assessment of the evidence on both the risks and benefits either for or against making the determination.

Considering cases where licensing and planning applications are made simultaneously

- 9.45 Where businesses have indicated, when applying for a licence under the 2003 Act, that they have also applied for planning permission or that they intend to do so, licensing committees and officers should consider discussion with their planning counterparts prior to determination with the aim of agreeing mutually acceptable operating hours and scheme designs.

10. Conditions attached to premises licences and club premises certificates

General

- 10.1 This chapter provides further guidance in relation to conditions attached to premises licences and club premises certificates. General principles on licence conditions are set out in Chapter 1 (see paragraph 1.16).
- 10.2 Conditions include any limitations or restrictions attached to a licence or certificate and essentially are the steps or actions that the holder of the premises licence or the club premises certificate will be required to take or refrain from taking in relation to the carrying on of licensable activities at the premises in question. Failure to comply with any condition attached to a licence or certificate is a criminal offence, which on conviction is punishable by an unlimited fine or up to six months' imprisonment. The courts have made clear that it is particularly important that conditions which are imprecise or difficult for a licence holder to observe should be avoided.
- 10.3 There are three types of condition that may be attached to a licence or certificate: proposed, imposed and mandatory. Each of these categories is described in more detail below.

Proposed conditions

- 10.4 The conditions that are appropriate for the promotion of the licensing objectives should emerge initially from the risk assessment carried out by a prospective licence or certificate holder, which they should carry out before making their application for a premises licence or club premises certificate. This would be translated into the steps recorded in the operating schedule or club operating schedule, which must also set out the proposed hours during which licensable activities will be conducted and any other hours during which the premises will be open to the public.
- 10.5 It is not acceptable for licensing authorities to simply replicate the wording from an applicant's operating schedule. A condition should be interpreted in accordance with the applicant's intention.

Consistency with steps described in operating schedule

- 10.6 The 2003 Act provides that where an operating schedule or club operating schedule has been submitted with an application and there have been no relevant representations made by responsible authorities or any other person, the licence or certificate must be granted subject only to such conditions as are consistent with the schedule accompanying the application and any mandatory conditions required under the 2003 Act.
- 10.7 Consistency means that the effect of the condition should be substantially the same as that intended by the terms of the operating schedule. If conditions are broken, this may lead to a criminal prosecution or an application for a review and it is extremely important therefore that they should be expressed on the licence or certificate in unequivocal and unambiguous terms. The duty imposed by conditions on the licence holder or club must be clear to the licence holder, club, enforcement officers and the courts.

Imposed conditions

- 10.8 The licensing authority may not impose any conditions unless its discretion has been exercised following receipt of relevant representations and it is satisfied as a result of a hearing (unless all parties agree a hearing is not necessary) that it is appropriate to impose conditions to promote one or more of the four licensing objectives. In order to promote the crime prevention licensing objective conditions may be included that are aimed at preventing illegal working in licensed premises. This provision also applies to minor variations.
- 10.9 It is possible that in some cases no additional conditions will be appropriate to promote the licensing objectives.

Proportionality

- 10.10 The 2003 Act requires that licensing conditions should be tailored to the size, type, location and characteristics and activities taking place at the premises concerned. Conditions should be determined on a case-by-case basis and standardised conditions which ignore these individual aspects should be avoided. For example, conditions should not be used to implement a general policy in a given area such as the use of CCTV, polycarbonate drinking vessels or identity scanners where they would not be appropriate to the specific premises. Conditions that are considered appropriate for the prevention of illegal working in premises licensed to sell alcohol or late night refreshment might include requiring a premises licence holder to undertake right to work checks on all staff employed at the licensed premises or requiring that a copy of any document checked as part of a right to work check is retained at the licensed premises. Licensing authorities and other responsible authorities should be alive to the indirect costs that can arise because of conditions. These could be a deterrent to holding events that are valuable to the community or for the funding of good and important causes. Licensing authorities should therefore ensure that any conditions they impose are only those which are appropriate for the promotion of the licensing objectives.

Naming, packing and promotion in retail premises

- 10.11 The Government acknowledges that the irresponsible naming, packing or promotion of alcoholic drinks may contribute to alcohol related harms. Where there is direct evidence of specific incidents of irresponsible naming, packing or promotion of alcoholic drinks linked to the undermining of one of the licensing objectives, licensing authorities should, in the exercise of their licensing functions (in particular, in relation to an application for the grant, variation or review of a premises licence), consider whether it is appropriate to impose conditions on licences that require the licence holder to comply with the Portman Group's Retailer Alert Bulletins. This condition should be considered on a case by case basis and in the context of the promotion of the licensing objectives.
- 10.12 The Portman Group operates, on behalf of the alcohol industry, a Code of Practice on the Naming, Packaging and Promotion of Alcoholic Drinks. The Code seeks to ensure that drinks are packaged and promoted in a socially responsible manner and only to those who are 18 years old or older. Complaints about products under the Code are considered by an Independent Complaints Panel and the Panel's decisions are published on the Portman Group's website, in the trade press and in an annual report. If a product's packaging or point-of-sale advertising is found to be in breach of the Code,

- 14.52 Statements of policy should also make clear that conditions requiring the admission of children to any premises cannot be attached to licences or certificates. Where no licensing restriction is appropriate, this should remain a matter for the discretion of the individual licence holder, club or premises user.
- 14.53 Venue operators seeking premises licences and club premises certificates should consider including such prohibitions and restrictions in their operating schedules particularly where their own risk assessments have determined that the presence of children is undesirable or inappropriate.

Responsible authority and children

- 14.54 A statement of licensing policy should indicate which body the licensing authority judges to be competent to act as the responsible authority in relation to the protection of children from harm. This may be the local authority social services department, the Local Safeguarding Children Board or other competent body as agreed locally. It would be practical and useful for statements of licensing policy to include descriptions of the responsible authorities in any area and appropriate contact details.

Children and cinemas

- 14.55 The statement of policy should make clear that in the case of premises giving film exhibitions¹⁷, the licensing authority will expect licence holders or clubs to include in their operating schedules arrangements for restricting children from viewing age-restricted films classified according to the recommendations of the British Board of Film Classification or the licensing authority itself (see paragraphs 10.59 to 10.60).

Integrating strategies

- 14.56 It is recommended that statements of licensing policy should provide clear indications of how the licensing authority will secure the proper integration of its licensing policy with local crime prevention, planning, transport, tourism, equality schemes, cultural strategies and any other plans introduced for the management of town centres and the night-time economy. Many of these strategies are not directly related to the promotion of the licensing objectives, but, indirectly, impact upon them. Co-ordination and integration of such policies, strategies and initiatives are therefore important.

Planning and building control

- 14.57 The statement of licensing policy should indicate that planning permission, building control approval and licensing regimes will be properly separated to avoid duplication and inefficiency. The planning and licensing regimes involve consideration of different (albeit related) matters. Licensing committees are not bound by decisions made by a planning committee, and vice versa.
- 14.58 There are circumstances when as a condition of planning permission, a terminal hour has been set for the use of premises for commercial purposes. Where these hours are different to the licensing hours, the applicant must observe the earlier closing time. Premises operating in breach of their planning permission would be liable to prosecution under planning law. Proper integration should be assured by licensing committees,

¹⁷ See paragraphs 15.22-15.24 in relation to the licensing exemption for an exhibition of a film on community premises.

16. Regulated entertainment

Types of regulated entertainment

- 16.1 Schedule 1 to the 2003 Act sets out what activities are regarded as the provision of regulated entertainment and when they are licensable and those activities which are not and therefore exempt from the regulated entertainment regime. Changes to regulated entertainment are due to take effect on 6 April 2015. Therefore, up until that date you should refer to chapter 16 of the guidance published in October 2014.
- 16.2 The descriptions of entertainment activities licensable under the 2003 Act are:
- a performance of a play;
 - an exhibition of a film;
 - an indoor sporting event;
 - a boxing or wrestling entertainment;
 - a performance of live music;
 - any playing of recorded music;
 - a performance of dance; and
 - entertainment of a similar description to a performance of live music, any playing of recorded music or a performance of dance.
- 16.3 To be licensable, one or more of these activities needs to be provided for the purpose (at least partly) of entertaining an audience; has to be held on premises made available for the purpose of enabling that activity; and must also either:
- take place in the presence of a public audience, or
 - where that activity takes place in private, be the subject of a charge made with a view to profit.
- 16.4 Guidance around what constitutes audiences and private events is at paragraphs 16.11-16.14.

Overview of circumstances in which entertainment activities are not licensable

- 16.5 There are a number of exemptions that mean that a licence (or other authorisation¹⁸) under the 2003 Act is not required. This Guidance cannot give examples of every eventuality or possible entertainment activity that is not licensable. However, the following activities are examples of entertainment which are not licensable:
- activities which involve participation as acts of worship in a religious context;
 - activities in places of public religious worship;
 - education – teaching students to perform music or to dance;
 - the demonstration of a product – for example, a guitar – in a music shop;
 - the rehearsal of a play or performance of music for a private audience where no charge is made with a view to making a profit;

¹⁸ The word 'licence' is typically used as a reference to all forms of authorisation

Travelling circuses

16.25 Where types of entertainment are present in a performance by a travelling circus⁵⁰ they will not be licensable provided that certain qualifying conditions are met⁵¹. The qualifying conditions are that:

- the entertainment is not an exhibition of a film or a boxing or wrestling entertainment;
- the entertainment takes place between 08.00 and 23.00 on the same day;
- the entertainment takes place wholly within a moveable structure and the audience present is accommodated wholly inside that moveable structure; and
- the travelling circus has not been located on the same site for more than 28 consecutive days.

Live music

16.26 Live music is licensable:

- where a performance of live music – whether amplified or unamplified – takes place before 08.00 or after 23.00 on any day;
- where a performance of amplified live music does not take place either on relevant licensed premises, or at a workplace that is not licensed other than for the provision of late night refreshment;
- where a performance of amplified live music takes place at a time when the relevant licensed premises are not open for the purposes of being used for the sale or supply of alcohol for consumption on the premises⁵²;
- where a performance of amplified live music takes place at relevant licensed premises, or workplaces⁵³, in the presence of an audience of more than 500 people⁵⁴; or
- where a licensing authority intentionally removes the effect of the deregulation provided for by the 2003 Act when imposing a condition on a premises licence or club premises certificate as a result of a licence review⁵⁵.

16.27 In any of the above circumstances, unless the performance of live music is appropriately authorised by a premises licence, club premises certificate or TEN, allowing it to take place could lead to enforcement action and, where relevant, a review of the alcohol licence or certificate.

16.28 A public performance of live unamplified music that takes place between 08.00 and 23.00 on the same day no longer requires a licence under the 2003 Act in any location. An exception to this is where a specific condition related to live music is included following a review of the premises licence or club premises certificate in respect of relevant licensed premises.

⁵⁰ 'Travelling circus' is defined in the 2014 Order as meaning a circus which travels from site to site for the purpose of giving performances. Musical entertainment at a travelling fairground is likely to be incidental to the main attractions and rides that are not themselves regulated entertainment.

⁵¹ There is no audience limit for this exemption, but the conditions are designed to ensure that deregulation does not have unintended consequences for the licensing objectives – e.g. only bona fide travelling circuses qualify.

⁵² See Chapter 3 of this Guidance

⁵³ See paragraph 16.31

⁵⁴ The 2014 Order substituted "500" for "200" that was in the 2012 Act

⁵⁵ See paragraphs 16.55-16.56

- 16.29 As a result of the amendments to the 2003 Act, section 177 of the 2003 Act now only applies to performances of dance⁵⁶.

Key terms used in relation to live music

- 16.30 Under the live music provisions, “music” includes vocal or instrumental music or any combination of the two. “Live music” is a performance of live music in the presence of an audience which it is intended to entertain. While a performance of live music can include the playing of some recorded music, ‘live’ music requires that the performance does not consist entirely of the playing of recorded music without any additional (substantial and continual) creative contribution being made. So, for example, a drum machine or backing track being used to accompany a vocalist⁵⁷ or a band would be part of the performance of amplified live music. The performance of a DJ who is merely playing tracks would not be classified as live music, but it might if he or she was performing a set which largely consisted of mixing recorded music in a live performance to create new sounds⁵⁸. There will inevitably be a degree of judgement as to whether a performance is live music (or recorded music) and organisers of events should check with their licensing authority if this consideration is relevant to whether the activity is authorised by a licence or certificate. In the event of a dispute about whether a performance is live music or not, it will be for the licensing authority initially and ultimately, for the courts to decide in the individual circumstances of any case.
- 16.31 A “workplace” is as defined in regulation 2(1) of the Workplace (Health, Safety and Welfare) Regulations 1992 and is anywhere that is made available to any person as a place of work. It is a very wide term which can include outdoor spaces, as well as the means of entry and exit.
- 16.32 A “relevant licensed premises” for the purposes of this chapter is one which is authorised to sell or supply alcohol for consumption on the premises by a premises licence or club premises certificate. Premises cannot benefit from the deregulation introduced by the 2012 Act by virtue of holding an authorisation for the sale or supply of alcohol under a TEN.⁵⁹

Recorded music

- 16.33 No licence is required for recorded music where it takes place on premises which are authorised by a premises licence or club premises certificate to be used for the supply of alcohol for consumption on the premises. However, recorded music remains licensable:
- where the playing of recorded music takes place before 08.00 or after 23.00 on any day;
 - where the playing of recorded music takes place at a time when the relevant licensed premises are not open for the purposes of being used for the sale or supply of alcohol for consumption on the premises;⁶⁰
 - where the playing of recorded music takes place at relevant licensed premises in the

⁵⁶ See paragraph 2.13. Post the 2013 Order, Section 177 can be relevant to a performance of dance after 23.00 on any day

⁵⁷ Karaoke is generally classed as a performance of live music

⁵⁸ This would include ‘scratching’

⁵⁹ TENs are covered in chapter 7

⁶⁰ See Chapter 3 of this Guidance

- presence of an audience of more than 500 people; and
- where a licensing authority intentionally removes the effect of the deregulation provided for by the 2003 Act (as amended).⁶¹

Plays and dance

- 16.34 No licence is required for a performance of a play or dance to the extent that certain qualifying conditions⁶² are satisfied. However a performance of a play or dance remains licensable:
- where the performance takes places before 08.00 or after 23.00 on any day; or
 - where the performance takes place in the presence of an audience of more than 500 people.

Indoor Sport

- 16.35 No licence is required for an indoor sporting event to the extent that certain qualifying conditions⁶³ are satisfied. However an indoor sporting event remains licensable:
- where the event takes places before 08.00 or after 23.00 on any day;
 - where the event takes place in the presence of more than 1000 spectators.

Licence conditions

Live Music or recorded music

- 16.36 Any existing licence conditions⁶⁴ (or conditions added on a determination of an application for a premises licence or club premises certificate⁶⁵) which relate to live music or recorded music remain in place, but are **suspended** between the hours of 08.00 and 23.00 on the same day where the following conditions are met:
- at the time of the music entertainment, the premises are open for the purposes of being used for the sale or supply of alcohol for consumption on the premises;
 - if the music is amplified, it takes place before an audience of no more than 500 people; and
 - the music takes place between 08.00 and 23.00 on the same day.
- 16.37 Whether a licence condition relates to live or recorded music will be a matter of fact in each case. In some instances, it will be obvious that a condition relates to music and will be suspended, for example “during performances of live music all doors and windows must remain closed”. In other instances, it might not be so obvious: for example, a condition stating “during performances of regulated entertainment all doors and windows must remain closed” would be suspended insofar as it relates to music between 08.00 and 23.00 on the same day to an audience of up to 500, but the condition would continue to apply if there was regulated entertainment after 23.00.
- 16.38 More general licence conditions (e.g. those relating to overall management of potential noise nuisance) that are not specifically related to the provision of entertainment (e.g.

⁶¹ This would be by way of imposing a condition on a premises licence or club premises certificate as a result of a licence review, see paragraphs 16.55-16.56.

⁶² See paragraphs 16.6 and 16.45-16.48.

⁶³ See paragraph 16.6.

⁶⁴ In relation to relevant licensed premises, see paragraph 16.32.

⁶⁵ See paragraphs 16.39-16.40.

signage asking patrons to leave quietly) will continue to have effect.

- 16.39 Chapter 9 of this Guidance sets out how a licensing authority must determine applications for a new licence or to vary an existing premises licence. Licence conditions imposed, in accordance with paragraphs 9.41 to 9.43, for live or recorded music activities will only apply if the activity meets the criteria of having more than 500 people present, and/or the activities are taking place between 23.00 and 08.00.
- 16.40 These conditions will, in effect, be suspended between 08.00 and 23.00 if a performance of live music or the playing of recorded music takes place before an audience of 500 people or fewer, but will remain on the face of the licence for when these activities may take place under other circumstances.
- 16.41 Where a performance of live music or the playing of recorded music on relevant licensed premises is not licensable, it remains possible for anyone to apply for a review of a licence or certificate, if there are appropriate grounds to do so.⁶⁶

Beer gardens

- 16.42 Beer gardens are often included as part of a premises licence or club premises certificate. Live amplified music that takes place in a beer garden is exempt from licensing requirements, provided the beer garden is included in the licence or certificate applying to the relevant licensed premises, and the performance takes place between 08.00 and 23.00 on the same day before an audience of 500 people or fewer.
- 16.43 Where a beer garden does not form part of the relevant licensed premises and so is not included in plans attached to a premises licence or club premises certificate, it is nevertheless very likely that it will be a workplace⁶⁷. Paragraph 12B of Schedule 1 to the 2003 Act says that a performance of live music in a workplace that does not have a licence (except to provide late night refreshment) is not regulated entertainment if it takes place between 08.00 and 23.00 on the same day in front of an audience of no more than 500 people. Note that the exemption in paragraph 12B does not apply to the playing of recorded music.
- 16.44 However, a licensing authority may, where justified⁶⁸, impose a licence condition that relates to the performance of live music in an unlicensed beer garden being served by any associated premises licence or club premises certificate. Provided such a condition is lawfully imposed, it takes effect in accordance with its terms.

Plays, dance and indoor sport

- 16.45 Where qualifying conditions are satisfied⁶⁹, any current licence condition that relates to a performance of a play or dance, or an indoor sporting event for which a licence is no longer required will (except in the circumstances described in the next paragraph) have no effect.
- 16.46 Where, however, these ~~non-licensable~~ activities take place at the same time ~~as other~~

⁶⁶ See paragraphs 16.55-16.56 and chapter 11.

⁶⁷ A beer garden is one example of a potential workplace, see paragraph 16.31. Whether other outdoor spaces (such as seating adjacent to a premises, a smoking shelter, or a car park) constitute a workplace, part of the licensed premises, or neither, will be a matter of fact in each case.

⁶⁸ Including on a licence review

⁶⁹ See paragraph 16.6

Applicaiton for a Premises Licence- Abel House



Licensing Sub-Committee 14 June 2017

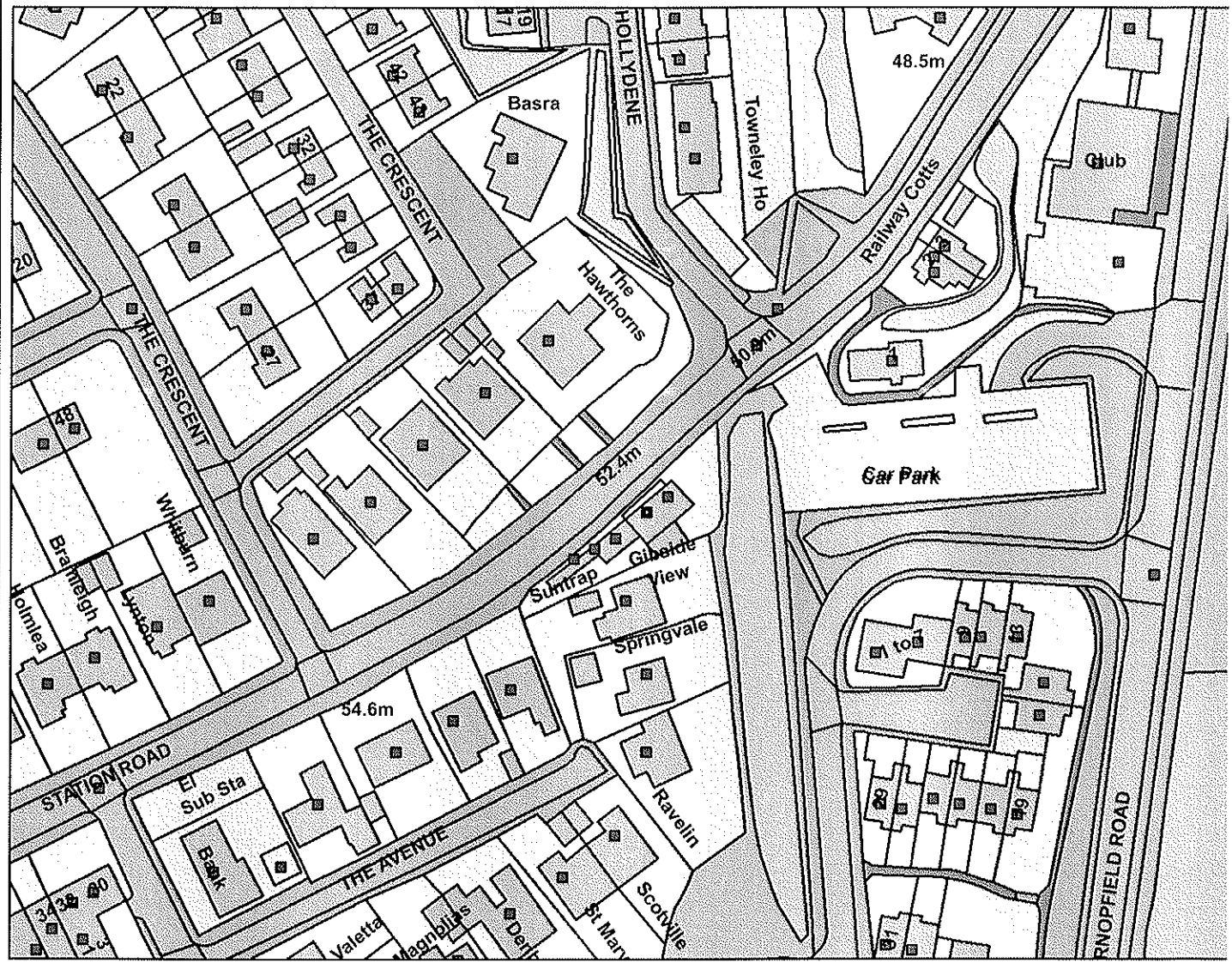

Legend

[Empty legend box]

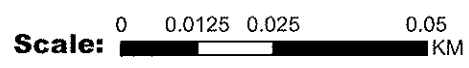

Reproduced from the Ordnance Survey map with permission of the Controller of Her Majesty's Stationery Office © Crown Copyright 2012.

Unauthorised reproduction infringes Crown Copyright and may lead to prosecution or civil proceedings.

Organisation	Gateshead Council
Department	Development and Public Prote
Comments	Not Set
Date	19/05/2017
MSA Number	SLA

This page is intentionally left blank